

HAM 21-29

2022 LEASE AGREEMENT BETWEEN KENDALL COUNTY, ILLINOIS AND THE KANE COUNTY OFFICE OF COMMUNITY REINVESTMENT, WORKFORCE DEVELOPMENT DIVISION

This Lease Agreement ("Lease") is made and entered into as of January 1, 2022 (the Effective Date), by and between the Landlord, the County of Kendall (hereinafter referred to as "County") and the Tenant, the Kane County Office of Community Reinvestment, Workforce Development Division.

1. PREMISES.

1.1 In consideration of the mutual promises, covenants, and conditions herein set forth, the County (hereinafter referred to as "Landlord") hereby leases to Kane County Office of Community Reinvestment, Workforce Development Division (hereinafter referred to as "Tenant") and Tenant hereby leases from the Landlord the premises, being the office numbers 221, 223, & 225 located on the second floor of the Kendall County Health and Human Services Building, located at 811 West John Street, Yorkville, Kendall County, Illinois, consisting of approximately twelve hundred (1200) square feet (hereinafter referred to as "Premises"), for the purpose of the Kane County Office of Community Reinvestment, Workforce Development Division providing job seekers with access to job search and labor market information, employment counseling and support along with education and skills training for the residence of Kendall County. Said Premises are shown on Exhibit A, attached hereto and excludes all Common Areas, as defined herein.

1.2 Landlord expressly reserves (a) the use of the exterior front, rear and side walls and roof of the Premises and the use of any space between the ceiling of the Premises and the floor above or the roof of the Building(s), and (b) the right to install, maintain, use, repair, and replace the pipes, ducts, conduits, and wires leading into or running through the Premises (in locations which will not materially interfere with Tenant's use of the Premises).

2. TERM.

2.1 Term. The Initial Term of this Lease shall be for the period of one (1) year commencing on January 1, 2022, and terminating on December 31, 2022. "Lease Term" or "Term" shall mean the Initial Term and any exercised Option Periods (as defined in Section 2.2 below).

2.2 Option Periods. Provided Tenant has not been in default in the payment of Rent during the Term and Tenant is then occupying the Premises, Tenant may extend the Initial Term for two, successive, one-year option periods by giving notice of exercise thereof ("Option Notice") to Landlord at least 60 calendar days before the expiration of the Initial Term or, in the event of the second, one-year option, 60 calendar days before the expiration of the first, one-year option period. If Tenant fails to provide the Option Notice at least 60 calendar days before the expiration of the term of the lease or, in the event of the second, one year option, at least 60 calendar days before the expiration of the first, one-year option period, Landlord may agree to waive the 60 calendar day notice requirement and allow Tenant to exercise the applicable option period. Any waiver thereof, must be in writing and signed by Landlord. If Tenant delivers a valid Option Notice or if Landlord agrees to waive the 60 calendar day notice requirement and allows Tenant to exercise the applicable option period, the Term shall thereby be extended on all the terms and provisions contained in this Lease.

2.3 Renovation of Premises by Landlord. The parties agree that that Landlord will not perform any renovation work to the premises prior to the tenant taking possession. Tenant's taking possession of the Premises shall be conclusive evidence that the Premises were suitable for Tenant's intended purposes as of the date thereof, that Tenant accepts the condition of the Premises.

2.4 Termination of Lease Agreement. Either party may terminate this Lease upon sixty (60) day written notice to the other party. All obligations outstanding at that time of termination shall survive the Lease. Both parties may agree in writing to termination of the Lease and waive the sixty (60) day written notice requirement.

3. RENT

3.1 Rental Payment. Tenant shall pay to Landlord Rent for said Premises in the amount of \$9600.00 per year, for the period of January 1, 2022 to December 31, 2022. Tenant shall make monthly rental payments in the amount of \$800.00, each full payment shall be made by the first day of the month, with the first payment being made January 1, 2022.

3.2 Security Deposit. No security deposit will be required as part of this lease.

3.3 Fair Market Value. The Landlord and Tenant agree that the rental amount set forth in section 3.1 constitutes the fair market value for rental of the premise.

4. PROPERTY

4.1 The Landlord and Tenant each agree that any personal property, such as equipment, furniture, or other non-fixture items, purchased by the Tenant or the Landlord, either prior to or during the term of this Lease, shall remain the personal property of the party who furnished the funds to purchase the property. All personal property of the Tenant shall be removed from the Premise at the termination of this Lease, unless otherwise agreed to in writing by the parties. Tenant specifically waives any claim of damage against the Landlord for any property damaged as a result of an act of nature including but not limited to lightning strikes and floods. Landlord is not responsible for providing any personal property, equipment, furniture or other non-fixture items to the Tenant.

5. COMMON AREA.

5.1 Common Area. "Common Area" is defined as all areas and facilities within the Kendall County Health and Human Services Building not appropriated to the occupancy of Tenant (The area of occupancy of the Tenant is show in Exhibit A), and facilities, utilities, or equipment outside the Kendall County Health and Human Services Building which serve the Kendall County Health and Human Services Building or any other County facility or property, including, but not limited to, all vehicle parking spaces or areas, roads, traffic lanes, driveways, sidewalks, pedestrian walkways, landscaped areas, signs, service delivery facilities, common storage areas, common utility facilities, and all other areas for nonexclusive use in the Kendall County Health and Human Services Building that may from time to time exist. Common Areas shall include the roofs and exterior walls of buildings in the Kendall County Health and Human Services Building, all utility systems, heating, ventilating, and cooling systems, and sewer laterals.

5.2 Common Area Expenses. The term "Common Area Expenses" shall include the maintenance, repair, replacement, operation, and management of the Common Area and the Kendall County Health and Human Services Building and shall include landscaping; repaving; resurfacing; restriping; security; alarm systems; signage; property management; repairs, maintenance, and replacements of bumpers, directional

signs, and other markers; painting; lighting and other utilities (including, but not limited to electricity, gas, water, and telephone); cleaning; trash removal; Tenant's trash removal; any contracts for services or supplies to be provided in connection with the maintenance, management, operation, repair, and replacement of such Common Area. All costs associated with the Common Area are to be paid by the Landlord.

5.3 Control of the Common Area. Landlord and the Kendall County Health Department shall have exclusive control of the Common Area and may exclude any person from use thereof, except authorized employees and service suppliers of Tenant. Tenant acknowledges that Landlord may change the shape, size, location, number, and extent of the improvements to any portion of the Kendall County Health and Human Services Building without Tenant's consent. Tenant and its agents, employees, assignees, contractors, and invitees shall observe faithfully and comply with any rules or regulations adopted by the Landlord and/or Kendall County Health Department for the Kendall County Health and Human Services Building. Tenant agrees to keep the Common Area free and clear of any obstructions created or permitted by Tenant or resulting from Tenant's operation and to use the Common Area. Common Areas shall be used by Tenant and its employees, agents, representatives, licensees, and invitees only for normal activities: parking, ingress, and egress to and from the Premises and Kendall County Health and Human Services Building. If, in the opinion of Landlord, unauthorized persons are using the Common Area by reason of the presence of Tenant in the Premises, Tenant, upon demand of Landlord, shall correct such situation by appropriate action and proceedings against all such unauthorized persons. Nothing herein shall affect the rights of Landlord at any time to remove any such unauthorized persons from said areas or to prevent the use of said areas by such unauthorized persons. The Tenant is allowed to use the waiting area as set forth in Exhibit A, as well as public restrooms, for clients of the Tenant. In addition, the Tenant is allowed access to conference rooms and training rooms as deemed appropriate by the Kendall County Health Department and subject to their rules and regulations.

6. REAL PROPERTY TAXES.

6.1 All real property taxes shall be the responsibility of the Landlord, to the extent applicable under the laws of the State of Illinois.

7. INSURANCE; INDEMNITY; SUBROGATION.

7.1 General. All insurance policies required to be carried by Tenant under this Lease shall (a) be written by companies rated A-/VIII or better in the most recent edition of BEST'S INSURANCE REPORTS and authorized to do business in the State of Illinois and (b) name Landlord, the Kendall County Health Department, and any parties designated by Landlord as additional insures. Tenant shall deliver to Landlord certified copies of its insurance policies, or an original certificate evidencing that such coverage is in effect, January 1, 2022 and thereafter at least 30 days before the expiration dates of expiring policies. Coverage shall not be canceled or materially reduced. Tenant's coverage shall be primary insurance with respect to Landlord, and its officers, directors, and employees. Any insurance maintained by Landlord shall be in excess of, and not contributing with, Tenant's insurance. Coverage shall apply separately to each insured against whom a claim is made or suit is brought, except with respect to any aggregate limit applicable to the insuring party's policy.

7.2 Tenant's Liability Insurance. Tenant shall keep in force during the term of this Lease a policy of public liability insurance insuring against any liability arising out of Tenant's use, occupancy, or maintenance of the Premises and the acts, omissions, and negligence of Tenant, its agents, employees, contractors, and invitees in and about the Premises and the Kendall County Health and Human Services Building. As of the Term commencement date, such insurance shall provide coverage for and shall be in

the amount of not less than \$2,000,000.00 per occurrence for bodily injury, including death, and person injury, \$1,000,000.00 per occurrence property damage insurance.

7.3 Tenant's Other Insurance. Tenant shall maintain special form property coverage, with sprinkler leakage, vandalism, and malicious mischief endorsements on all of Tenant's fixtures, including tenant improvements and betterments, equipment, and personal property on the Premises, in an amount not less than 100 percent of their full guaranteed replacement value, the proceeds of which shall, as long as the Lease is in effect, be used for the repair or replacement of the property so insured. Tenant shall maintain workers' compensation insurance in accordance with the laws of the State of Illinois in which the Premises are located and employer's liability insurance with a limit of not less than \$1,000,000.00 each accident.

7.4 Waiver of Subrogation. Neither Landlord nor Tenant shall be liable to the other or to any insurance company (by way of subrogation or otherwise) insuring the other party for any loss or damage to any building, structure, or other tangible property, or any resulting loss of income and benefits (even though such loss or damage might have been occasioned by the negligence of such party, its agents, or employees) if such loss or damage is covered by insurance benefiting the party suffering such loss or damage or was required to be covered by insurance pursuant to this Lease. Landlord and Tenant shall require their respective insurance companies to include a standard waiver of subrogation provision in their respective policies.

7.5 Indemnification and Waiver by Tenant. To the fullest extent permitted by law and except to the extent that any damage to property or injury is caused by the gross negligence or willful misconduct of Landlord, Tenant agrees (and Tenant shall cause its contractors and subcontractors to agree) that neither Landlord, its officers, directors, and employees nor Landlord's employees, agents, representatives, and contractors, nor Kendall County Health Department, its officers, directors, employees, agents, representative, and contractors, and each of their successors and assigns (each, "Landlord Party" and collectively "Landlord Parties") shall be liable for any injury to or death of persons or damage to property of Tenant (or its contractors and subcontractors) or any other person from the date of this Lease. Tenant shall defend with counsel of Landlord's choosing, indemnify, and hold Landlord and the Landlord Parties harmless against and from any and all claims, liabilities, losses, damages, suits, costs, and expenses of any kind or nature including without limitation reasonable attorneys' fees (collectively referred to herein as "Claims") arising from or relating to (a) Tenant's use of the Premises or the Common Areas, or (b) any acts, omissions, negligence, or default of Tenant or Tenant's agents, employees, officers, directors, contractors, and invitees (each, "Tenant Party" and collectively "Tenant Parties"), except to the extent that any such Claim is caused by the gross negligence or willful misconduct of Landlord. The terms of the indemnification by Tenant set forth in this Section 7.5 shall survive the expiration or earlier termination of this Lease.

8. USE.

8.1 The Premises shall be used for the Tenant to provide job seekers with access to job search and labor market information, employment counseling and support along with education and skills training for the residence of Kendall County during the term of this Lease. The failure by Tenant to use the Premises pursuant to this Article 8 shall be considered a default under this Lease, and Landlord shall have the right to exercise any and all rights and remedies provided herein or by law. The Tenant may not transfer or assign the Lease to a third party.

8.2 Landlord shall have the authority to make modification and improvements to the Kendall County Health and Human Services Building, including the Premises, as deemed necessary to accomplish its statutory functions.

8.3 Access to the Premises by the Tenant shall be limited to the normal business hours of the Kendall County Health and Human Service Building for general public access.

9. MAINTENANCE, REPAIRS, ALTERATIONS.

9.1 Tenant's Obligations. Subject to the foregoing, Tenant shall keep and maintain the Premises in good condition.

9.2 Landlord's Obligations. Subject to the foregoing, Landlord shall keep and maintain in good condition and repair (or replace, if necessary) all aspects of the Kendall County Health and Human Services Building including but not limited to the roof, exterior walls, structural parts, and structural floor of the Premises, fire protection services, and pipes and conduits outside the Premises for the furnishing to the Premises of various utilities (except to the extent that the same are the obligation of the appropriate public utility company).

9.3 Surrender. Upon the expiration or termination of this Lease, Tenant shall surrender the Premises to Landlord in good and broom-clean condition, with all of Tenant's fixtures and property removed, excepting ordinary wear and tear. Tenant shall also remove any Tenant-installed improvements that Landlord may require to be removed.

9.4 Alterations. Tenant shall not make any structural repairs or alterations of the Premises unless approved in writing by Landlord prior to any repairs or alterations.

9.5 Cleaning. The Landlord agrees to continue to provide for the general cleaning and maintenance of the Premises and the removal of trash from the Premises, including all associated costs.

9.6 Technical Support. Tenant is responsible, at its own cost, to provide any technical or mechanical support to repair or replace any electrical, mechanical, or computer equipment purchased by Tenant for use on said Premise.

10. UTILITIES.

10.1 Obligation to Pay. Landlord shall pay for all water, gas, electricity, and other utilities used by Tenant during the Lease Term, with the exception of telephone lines dedicated specifically for handling of Kane County Office of Community Reinvestment, Workforce Development Division telephone calls, which shall be paid by the Tenant.

10.2 Standard Use. Tenant acknowledges that the Premises are designed to provide standard office use electrical facilities and standard office lighting. Tenant shall not use any equipment or devices that utilize excessive electrical energy or that may, in Landlord's reasonable opinion, overload the wiring or interfere with electrical services to other tenants. Tenant agrees that it shall not install any equipment that exceeds or overloads the capacity of the utility facilities serving the Premises, and that if equipment installed by Tenant requires additional utility facilities, installation of the same shall be at Tenant's expense, but only after Landlord's written approval of same.

10.3 Landlord's Responsibility. Landlord shall not be liable for, and Tenant shall not be entitled to, any damages, abatement, or reduction in Rent by reason of any interruption or failure in the supply of utilities, including but not limited to lightning strikes and floods. No failure, stoppage, or interruption of any utility or service, including but not limited to lightning strikes and floods, shall be construed as an eviction.

of Tenant, nor shall it relieve Tenant from any obligation to perform any covenant or agreement under this Lease. In the event of any failure, stoppage, or interruption of utilities or services, Landlord shall use its reasonable efforts to attempt to restore all services promptly. Landlord reserves the right from time to time to make reasonable and nondiscriminatory modifications to the utility systems serving the Kendall County Health and Human Services Building. Landlord shall be entitled to cooperate with the energy and water conservation efforts of governmental agencies or utility suppliers.

11. MECHANICS LIENS.

11.1 Tenant shall keep the Premises and the Kendall County Health and Human Services Building free and clear of all encumbrances, mechanics liens, stop notices, demands, and claims arising from work done by or for Tenant or for persons claiming under Tenant, and Tenant shall defend Landlord and the Kendall County Health Department with counsel of Landlord's choosing, indemnify and save Landlord and the Kendall County Health Department free and harmless from and against any claims arising from or relating to the same.

12. DEFAULTS, REMEDIES.

12.1 Tenant's Default. Tenant shall be in default in the event of any of the following: (a) if Tenant fails to make any payment of Rent and such failure shall continue for 30 days after written notice by Landlord; (b) if Tenant fails to perform any other obligation to be performed by Tenant hereunder and such failure shall continue for 30 days after written notice by Landlord; provided, however, if the nature of such default is such that the same cannot reasonably be cured within a 30-day period, then Tenant shall not be deemed to be in default if it shall commence such cure within such 30-day period and thereafter rectify and cure such default with due diligence; (c) if Tenant abandons or vacates the Premises or ceases to use the Premises for the stated purpose as set forth in this Lease; or (d) if Tenant files a petition or institutes any proceedings under the Bankruptcy Code.

12.2 Remedies in Default. In the event of a default by Tenant, Landlord, in addition to any other remedies available to it at law or in equity, including injunction, at its option, without further notice or demand of any kind to Tenant or any other person, may (a) terminate this Lease and Tenant's right to possession of the Premises, recover possession of the Premises and remove all persons there from; (b) have the remedies available at law or in equity (Landlord may continue the Lease in effect after Tenant's breach and abandonment and recover Rent as it becomes due, if Tenant has the right to sublet or assign, subject only to reasonable limitations); or (c) even though it may have reentered the Premises, thereafter elect to terminate this Lease and all of the rights of Tenant in or to the Premises. (Landlord shall provide written notice to Tenant at the time Landlord believes it has the right contained in 12.2(c).)

12.3 At the termination of the Lease Term, by lapse of time or otherwise, Tenant will yield immediate possession of the Premises to the Landlord in good condition and repair, ordinary wear excepted, and will return any keys or access cards therefore to the Landlord.

12.4 If Tenant holds over or occupies the Premises beyond the Lease Term (it being agreed there shall be no holding over or occupancy without Landlord's written consent), Tenant shall pay Landlord for each day of such holding over a sum equal to 125% (one hundred twenty-five percent) of the Rent prorated for the number of days of such holding over. In addition, Tenant shall be liable to Landlord for any and all damages which Landlord shall suffer by reason thereof, and Tenant will indemnify Landlord against all claims and demands made by any succeeding tenants against Landlord, founded upon delay by Landlord in delivering possession of the Premises to such succeeding tenant. The provisions of this section shall not

constitute a waiver by Landlord of any right of re-entry as hereinafter set forth; nor shall receipt of any Rent or other act in apparent agreement of tenancy operate as a waiver of the right to terminate this Lease for a breach of any of the covenants herein.

13. DESTRUCTION.

13.1 Landlord's Option to Terminate. In the event of a casualty causing damage to the Premises or Kendall County Health and Human Services Building that cannot be repaired within ninety (90) calendar days from the date of damage or destruction, either Landlord or Tenant may terminate this Lease as of the date of the damage, upon written notice to the other party given within ninety (90) calendar days following the date of the casualty.

13.2 Repairs; Rental Abatement. In the event of an insured casualty that may be repaired within ninety (90) days from the date of the damage or, in the alternative, in the event that the Landlord or Tenant does not elect to terminate this Lease under the terms of Section 13.1 above, then this Lease shall continue in full force and effect and the Premises shall be reconstructed with the obligations of the parties being as set forth in Section 13.3 below. Such partial destruction shall in no way annul or void this Lease. As long as Tenant conducts its business in the Premises, there shall be no abatement of the Rent amounts owed unless and until the parties agree in writing on the amount thereof.

13.3 Limitation on Repairs. In the event of any reconstruction of the Premises under 13.2, Landlord's obligation to reconstruct the Premises shall be, to the extent reasonably practicable and to the extent of available proceeds, to restore the Premises to the condition in which they were delivered to Tenant. Landlord's repair obligations shall in no way include any construction obligations originally imposed on Tenant or subsequently undertaken by Tenant.

14. SIGNS AND DISPLAYS.

14.1 Tenant shall not erect or install in, on, or about the Premises any exterior or interior signs or advertising media, or window or door lettering or placards, without Landlord's consent. All such signs shall comply with all applicable laws and ordinances.

15. COMPLIANCE WITH LAWS.

15.1 Laws Generally. Tenant, at its sole cost and expense, shall comply with all existing and future laws, ordinances, orders, rules, regulations, and requirements of all governmental and quasi-governmental authorities (including the Americans with Disabilities Act, and any amendments thereto) having jurisdiction over the Premises and shall perform all work required to comply therewith. If any such work would involve changes to the structure, exterior, or mechanical, electrical, or plumbing systems of the Building, then such work shall be performed by Landlord, and Tenant shall reimburse Landlord the cost thereof within 30 days after receipt of billing.

15.2 Tenant shall comply with any and all laws concerning environmental regulations. Tenant shall not cause or permit any Hazardous Materials to be brought, stored, used, handled, transported, generated, released, or disposed of, on, in, under, or about the Premises

16. RIGHT OF ENTRY.

16.1 Landlord, the Kendall County Health Department, and its authorized representatives shall have the right to enter the Premises at all reasonable times upon reasonable notice to make repairs or alterations to the systems serving the Premises or for any other purpose.

17. WAIVERS.

17.1 No delay or omission in the exercise of any right or remedy of Landlord with respect to any default by Tenant shall impair such right or remedy or be construed as a waiver. No waiver of any of the terms, provisions, covenants, conditions, rules, and regulations shall be valid unless it shall be in writing signed by Landlord. The receipt and acceptance by Landlord of delinquent Rent or other payments due hereunder shall not constitute a waiver of any other default.

18. ATTORNEY'S FEES.

18.1 If either party hereto brings an action at law or in equity to enforce, interpret, or seek redress for the breach of this Lease, then the prevailing party in such action shall be entitled to recover all court costs, witness fees, and reasonable attorneys' fees, at trial or on appeal, in addition to all other appropriate relief.

19. LIMITATION ON LIABILITY.

19.1 In consideration of the benefits accruing hereunder, Tenant, on behalf of itself and all successors and assigns of Tenant, covenants and agrees that the obligations under this Lease do not constitute personal obligations of the Landlord, its members, directors, officers, or employees, and Tenant shall not seek recourse against members, directors, officers, or employees of Landlord or any of their personal assets for satisfaction in any liability in respect to this Lease.

20. NOTICES.

20.1 Every notice, demand, or request (collectively "Notice") required hereunder or by law to be given by either party to the other shall be in writing and shall be served on the parties at the addresses set forth below the signatures of the parties or such other address as the party to be served may from time to time designate in a Notice to the other party. A copy of any notice to Landlord shall be sent to the Kendall County State's Attorney, 807 John Street, Yorkville, Illinois, 60560. Any such Notices shall be sent either by (a) United States certified or registered mail, postage prepaid, return receipt requested; (b) overnight delivery using a nationally recognized overnight courier, which shall provide evidence of delivery upon sender's request; or (c) personal delivery, All notices given in the manner specified herein shall be effective upon the earliest to occur of actual receipt, the date of inability to deliver to the intended recipient as evidenced by the United States Postal Service or courier receipt, or the date of refusal by the intended recipient to accept delivery as evidenced by the United States Postal Service or courier.

21. MISCELLANEOUS.

21.1 Cumulative Remedies. No remedy herein conferred on or reserved to Landlord is intended to be exclusive of any other remedy herein or by law provided, but each shall be cumulative and shall be in addition to every other remedy given hereunder or now hereafter existing at law or in equity by statute.

21.2 Severability. The unenforceability, invalidity, or illegality of any provision of this Lease shall not render the other provisions unenforceable, invalid, or illegal. If a court finds that any provision of this Lease is invalid or unenforceable, but that by limiting such provision it becomes valid and enforceable, then such provision shall be deemed to be written, construed and enforced as so limited.

21.3 Governing Laws. The laws of the State of Illinois shall govern the validity, performance, and enforcement of this Lease. No conflict-of-law rules of any state or country (including, without limitation, Illinois conflict-of-law rules) shall be applied to result in the application of any substantive or procedural laws of any state or country other than Illinois. All controversies, claims, actions, or causes of action arising between the parties hereto and their respective successors and assigns shall be brought, heard, and adjudicated by the courts of the State of Illinois, with venue in Kendall County.

21.4 Force Majeure. If, by reason of any event of force majeure, either party to this Lease is prevented, delayed, or stopped from performing any act that such party is required to perform under this Lease other than the payment of Rent or other sums due hereunder, the deadline for performance of such act by the party obligated to perform shall be extended for a period of time equal to the period of prevention, delay, or stoppage resulting from the force majeure event, unless this Lease specifies that force majeure is not applicable to the particular obligation. As used in this Lease, the term "force majeure" shall include, but not be limited to, fire or other casualty; bad weather; inability to secure materials; strikes or labor disputes (over which the obligated party has no direct or indirect bearing in the resolution thereof); acts of God; acts of the public enemy or other hostile governmental action; civil commotion; terrorist acts; governmental restrictions, regulations, or controls; judicial orders; and/or other events over which the party obligated to perform (or its contractor or subcontractors) has no control. A party claiming a force majeure event ("the claiming party") shall promptly notify the other party in writing, describing the nature and estimated duration of the claiming party's inability to perform due to the force majeure event. The cause of such inability to perform will be remedied by the claiming party with all reasonable dispatch.

21.5 Successors and Assigns. All of the provisions, terms, covenants, and conditions of this Lease shall be binding on and inure to the benefit of the parties and their respective heirs, executors, administrators, successors, and assigns. No party shall assign, sublet, sell or transfer its interest in this Lease without the other party's prior written consent.

21.6 Relationship. Nothing contained in the Lease shall be deemed or construed by the parties or by any third person to create the relationship of principal and agent, or of partnership, or of joint venture, or of any association between Landlord and Tenant.

21.7 Entire Agreement; Modification. This Lease and all exhibits and/or addendums, and/or riders, if any, attached to this Lease are hereby made a part of this Lease, with full force and effect as if set forth herein. This Lease supersedes all prior agreements between the parties and sets forth all the covenants, promises, agreements, and conditions, and understandings between Landlord and Tenant concerning the Premises, and there are no actual or implied covenants, promises, agreements, conditions, or understandings, either oral or written, between them other than as are set forth herein and none thereof shall be used to interpret, construe, supplement, or contradict this Lease. No alteration, amendment, change, or addition to this Lease shall be binding on Landlord or Tenant unless reduced to writing and signed by each party.

21.8 Time of Essence. Time is of the essence with respect to the performance of every provision of this Lease in which time performance is specified.

21.9 Survival of Obligations. All obligations of Tenant accrued as of the date of acceptance or rejection of this Lease due to the bankruptcy of Tenant, and those accrued as of the date of termination or expiration of this Lease for any reason whatsoever, shall survive such acceptance, rejection, termination, or expiration.

21.10 Authority. Each party represents and warrants that their representative whose signature appears below have the power and authority to enter into this Lease and to obligate the party to the term of this Lease.

IN WITNESS WHEREOF, the parties hereto have executed this Lease as of the date first written above.

LANDLORD: Scott P. Gray
Chairman

TENANT: Scott Berger
Director - Scott Berger

Address of Landlord:
111 West Fox Street
Yorkville, IL 60560

Address of Tenant:
Kane County Office of Community Reinvestment
143 First Street
Batavia IL 60510

EXHIBIT A
DEPICTION OF PREMISES

[See attached Second Floor Plan]

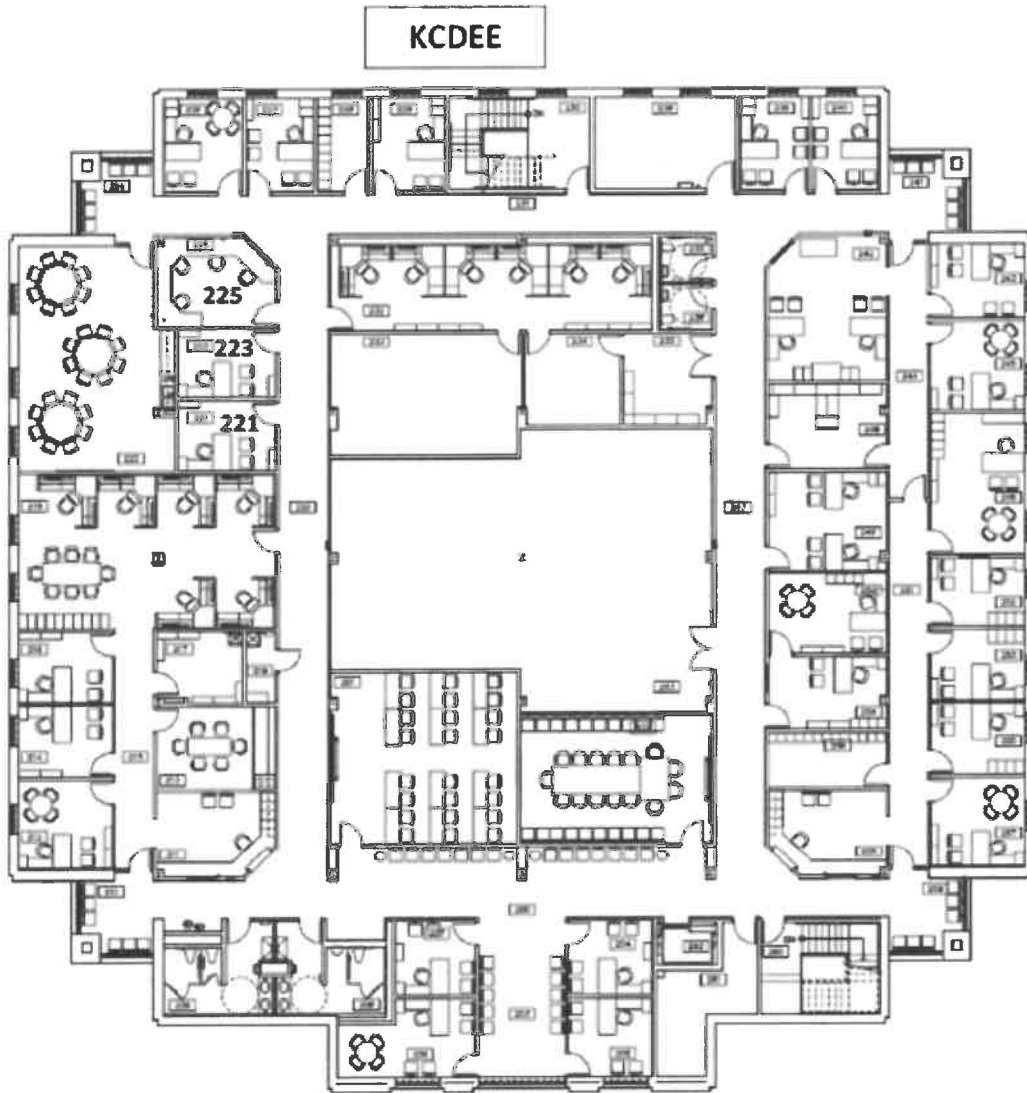

Kendall County Health Department
2nd Floor
Kane County Office Community
Reinvestment Workforce
Development Division Space
Offices 225, 223 & 221

