



**KENDALL COUNTY
HISTORIC PRESERVATION COMMISSION**
111 W. Fox Street • Rooms 209 and 210 • Yorkville, IL • 60560
(630) 553-4141 Fax (630) 553-4179

AGENDA

September 19, 2022 – 6:00 p.m.

CALL TO ORDER

ROLL CALL: Eric Bernacki (Secretary), Elizabeth Flowers (Vice-Chair), Kristine Heiman, Marty Shanahan, and Jeff Wehrli (Chair)

APPROVAL OF AGENDA:

APPROVAL OF MINUTES: Approval of Minutes of August 15, 2022 Meeting (Pages 2-29)

CHAIRMAN’S REPORT:

PUBLIC COMMENT:

NEW BUSINESS:

1. Approval of Appointment of Elizabeth Flowers as Vice-Chair of the Kendall County Historic Preservation Commission
2. Approval of Appointment of Eric Bernacki as Secretary of the Kendall County Historic Preservation Commission
3. Follow-Up on August 2022 Meeting with Historic Preservation Groups
 - a. Approval of Invoice for Food in the Amount of \$41.38; Invoice to Be Paid from PBZ Department’s Historical Preservation Line Item 11001902-63830 (Page 30)
4. Discussion of 2023 Meeting with Historic Preservation Groups
5. Discussion of CAMP Training (Pages 31-35)
6. Conference on Illinois History (Page 36)

OLD BUSINESS:

1. Discussion of Having Commission Meetings at Historic Locations in the County (Pages 37-41)
2. Discussion of Historic Survey Project/Certified Local Government Grant (Pages 42-43)
3. Discussion of Cemeteries (Pages 44-45)

CORRESPONDENCE:

1. National Registry Additions From August 12, 2022 To August 18, 2022 (Pages 46-47)
2. Fern Dell Annual Meeting Email (Page 48)
3. Chapel on the Green Open House Email (Pages 49-50)

PUBLIC COMMENT:

ADJOURNMENT:

If special accommodations or arrangements are needed to attend this County meeting, please contact the Administration Office at 630-553-4171, a minimum of 24-hours prior to the meeting time.

KENDALL COUNTY
Historic Preservation Commission
Fern Dell School
302 Chicago Road, Newark, Illinois
Fern Dell Museum
9 Front Street, Newark, Illinois
6:00 p.m.
August 15, 2022-Unofficial Until Approved

NEW BUSINESS

Tour of the Fern Dell School

Attendees and Commissioners toured the Fern Dell School starting at 6:05 p.m.

CALL TO ORDER

Chairman Jeff Wehrli called the meeting to order at the Fern Dell Museum at 6:29 p.m.

ROLL CALL

Present: Eric Bernacki (Secretary), Elizabeth Flowers (Vice-Chairwoman), Marty Shanahan, and Jeff Wehrli (Chairman)

Absent: Kristine Heiman

Also Present: Matt Asselmeier (Senior Planner), Ken Itle, Jane Burke, Jeff Mathre, Chris Phillips, Paul Burd, Todd Milliron, Subash George, Jeanne Valentine, Lisa Wolancevich, Johanna Byram, Susan Kritzberg, Ken Donart, Jeff Farren, Mike Bortal, Bev Casey, Janet Blue, and Marilynn Thompson

APPROVAL OF AGENDA

Member Flowers made a motion, seconded by Member Bernacki, to approve the agenda as presented. With a voice vote of four (4) ayes, the motion carried.

APPROVAL OF MINUTES

Member Flowers made a motion, seconded by Member Bernacki, to approve the minutes from the June 21, 2022, meeting. With a voice vote of four (4) ayes, the motion carried.

CHAIRMAN'S REPORT

Chairman Wehrli thanked Fern Dell for hosting. He explained the purpose of the meeting and noted the County's heritage.

PUBLIC COMMENT

Todd Milliron suggested having a local tractor show/parade.

NEW/OLD BUSINESS

Nomination of Officers for 2022-2023

Member Flowers, seconded by Member Shanahan, nominated Member Bernacki to the position of Secretary. There were no additional nominations.

Member Bernacki, seconded by Member Shanahan, nominated Member Flowers to the position of Vice-Chair. There were no additional nominations.

The votes on the nominations will occur at the September meeting.

Discussion of Historic Survey Project and Request for Volunteers-Ken Itle from WJE

Ken Itle from Wiss, Janney, Elstner Associates, Inc. presented information on the historic structure survey. He explained the project and plans to start the project in September. He discussed the source material for the survey. He also discussed the field work aspect of the project and the use of volunteers.

Lyon Farm has histories of many families and farms.

Mr. Itle discussed the deliverable from the project.

The survey teams will be one (1) person from WJE and one (1) volunteer. Surveys usually occur during the week, but can happen on a weekend. He plans to survey fifteen (15) to twenty (20) sites per day. Interested parties should reach out to Mr. Itle or Mr. Asselmeier. There would be a training session in September.

Mr. Asselmeier will do an email blast to the email list.

Mr. Itle explained that the project is funded through a Certified Local Government Grant. He explained how the grant was funded.

Chairman Wehrli explained the plan to survey the other townships.

Mr. Itle said that he would use archival photos as available. He discussed how he determines the dates of photos.

There were about two hundred forty (240) sites to examine.

Mr. Itle said that he attempts to track where structures used to be located.

Kendall Township would be surveyed first.

Mr. Itle hopes to pick a date in September for the training.

Concerns were expressed that some families would not be available in September due to harvesting.

Discussion of Cemeteries

Chairman Wehrli provided an update on the Commission's work, but the Commission has not put anything together at this time. The cemeteries have been identified. Lisa Wolancevich said the Elmer Dixon at Lyon Farm has that information. Johanna Byram discussed a group that identified veterans buried in Oswego.

Updates from Historic Preservation Groups

Mike Bortal, Plainfield Historic Preservation Commission, discussed having a CAMP organized hosted by the National Alliance of Preservation Commissioners. They would finance the CAMP through a Certified Local Government Grant with financial assistance from local Certified Local Governments. He discussed previous CAMPS and how CAMPS work. The grant would be applied for in 2022 and the CAMP would occur in 2023. He requested that the Kendal County Historic Preservation Commission let him know, if the Commission was interested in participating. He also provided information on the Bronk Farm. He also discussed a rehabilitation grant in Plainfield for historic properties.

Susan Kritzberg, Chapel on the Green, introduced Chapel on the Green representatives in attendance. She discussed their wedding business. They were working on a Network to Freedom grant.

Marilynn Thompson, Fern Dell, welcomed everyone to the Museum. She discussed their fundraising activities and history of the organization. She introduced several board members in attendance. She discussed activities at the Fern Dell School. She discussed the importance of getting new people involved. She discussed their plat book collection. She thanked everyone for attending the meeting.

Discussion occurred about educating children on the history of the area.

Subash George, Oswego Preservation Commission, also discussed the importance of educating children. He talked about partnering with the school district.

Jeanne Valentine, Plano Historical Society, was close to getting a location. She hoped that having a location will add new life to the organization.

Lisa Wolancevich, Kendall County Historical Society, introduced members of the Society in attendance. She discussed the repairs to roofs on several buildings at Lyon Farm. She discussed the literary events at the Society. She discussed the issues with the Illinois Department of Transportation regarding the expanding of Route 71. She noted the donation from the Elmer Dixon estate; there will be celebration of life for Elmer Dixon and his wife this fall at Lyon Farm. Their Fall Festival is September 24, 2022, and car show on September 25, 2022, with tractors. She requested attendees to submit names of families or notable citizens to celebrate at the Fall Festival.

Susan Kritzberg, Chapel on the Green, stated they also received a donation from the Elmer Dixon estate and they were planning an event for the fall of 2022 to honor Mr. Dixon.

Jane Burke, Naperville Preservation, discussed the mission of her organization. She discussed a CAMP training that she previously attended. She discussed the cataloguing for the first commercial residential subdivision in Naperville. She also discussed two (2) threatened structures in DuPage County.

Janet Blue and Bev Casey, Millington Historical Society, discussed the mission of their organization and their veterans' wall. They discussed the importance of networking and promoting through Facebook.

As part of an effort to identify former business occupants in buildings in Yorkville, a request was made for phone books from the 1990s.

Discussion occurred about notifying the libraries and the other museums about collections at the various museums.

Jane Burke discussed the Suburban Preservation Alliance meeting, sponsored by Landmarks Illinois, which will be held on September 17, 2022, in Naperville. She will send information to Mr. Asselmeier.

Subash George said the Oswego Historic Preservation Commission was looking for members.

Discussion of Upcoming Meetings with Historic Preservation Groups

Chairman Wehrli indicated that another group meeting would occur in winter 2022-2023.

Chairman Wehrli discussed having Commission meetings at sites in Kendall County to gain a greater understanding of Kendall County. He asked attendees to send suggested meeting locations to Mr. Asselmeier.

CORRESPONDENCE

July 21, 2022 and August 7, 2022 Emails from Michael Bortel Regarding National Alliance of Preservation Commissions CAMP

Commissioners reviewed the correspondence.

August 1, 2022 Edith Farnsworth House Email Regarding New Exhibit Open August 7th

Commissioners reviewed the correspondence.

August 2022 Edition of The Bell Tower

Commissioners reviewed the correspondence.

PUBLIC COMMENT

Chairman Wehrli encouraged attendees to volunteer.

ADJOURNMENT

Member Flowers made a motion, seconded by Member Shanahan, to adjourn. With a voice vote of four (4) ayes, the motion carried.

The Historic Preservation Commission adjourned at 7:39 p.m.

Chairman Wehrli thanked everyone for attending.

Respectfully Submitted,
Matthew H. Asselmeier, AICP, CFM
Senior Planner

Enc.



SOLUTIONS FOR THE BUILT WORLD

Rural Historic Structures Survey



www.wje.com

WJE ENGINEERS
ARCHITECTS
MATERIALS SCIENTISTS

Wiss, Janney, Elstner Associates, Inc.

August 15, 2022



Wiss, Janney, Elstner Associates, Inc.

Kenneth Itle

Rural historic structures survey

- Historical research
- Database development
- Mapping
- Field survey
- Report preparation

Historical research



Research materials

HISTORY
—OF—
KENDALL COUNTY

ILLINOIS,

FROM THE

Earliest Discoveries to the Present Time,

—BY—
REV. E. W. HICKS.

Author of "Life of Jesus, for Young People."

AURORA, ILL.:
KNICKERBOCKER & HODDER, Steam Printers and Blank Book Makers,
Nos. 24, 26 & 28 Broadway,
1877.
F. J. G.

GENEALOGICAL
AND
BIOGRAPHICAL RECORD
OF
KENDALL AND WILL COUNTIES
ILLINOIS

Containing Biographies of Well Known Citizens of the
Past and Present

BIOGRAPHICAL PUBLISHING COMPANY
CHICAGO
1901

10

Prairie Farmer's Director
of
Grundy and Kendall Counties
Illinois

Complete Directory of the Farmers of Grundy and Kendall Counties, with valuable information about each farm.

Breeder's Directory, giving full classified list of breeders of purebred livestock and poultry.

Business Directory, giving list of all business houses in Grundy and Kendall Counties.

Valuable statistics and general information.

Copyright, 1917

By PRAIRIE FARMER PUBLISHING COMPANY

1917

Compiled and Published by
Prairie Farmer Publishing Co.
CHICAGO, ILLINOIS

Atlases and Plat Maps

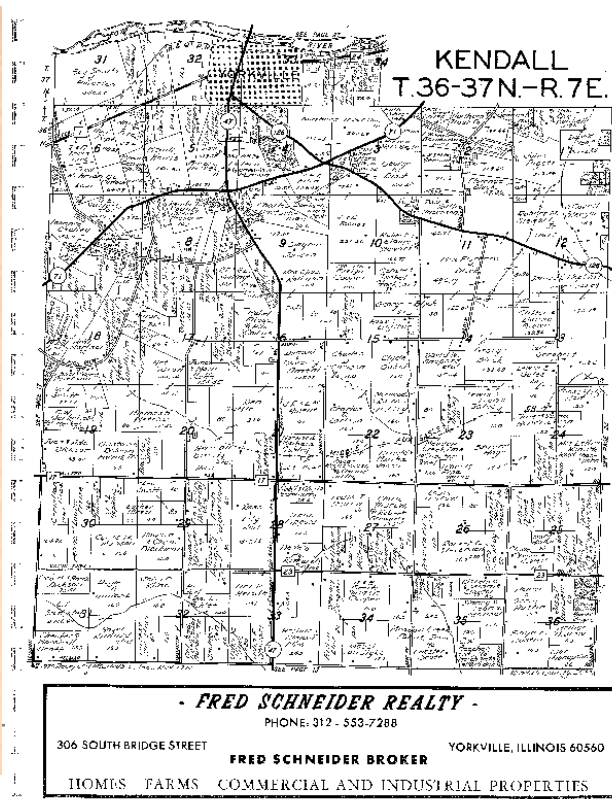
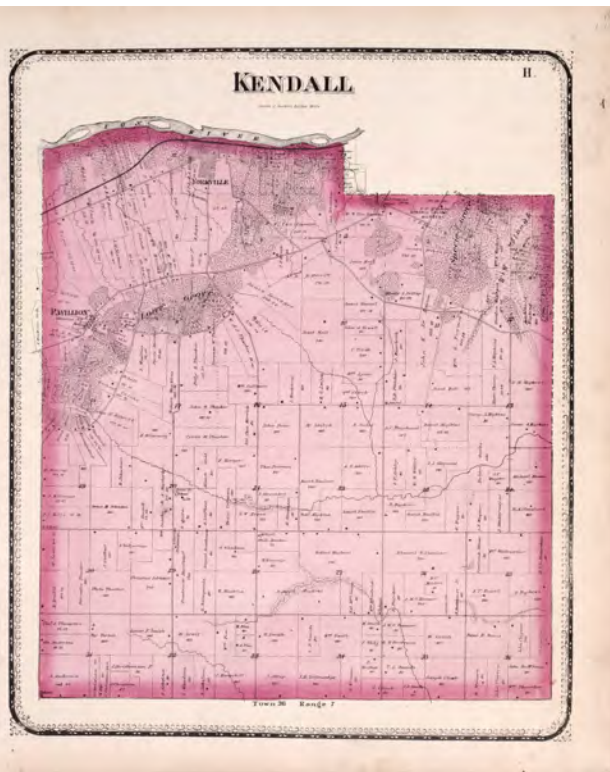

Atlases and Plat Maps

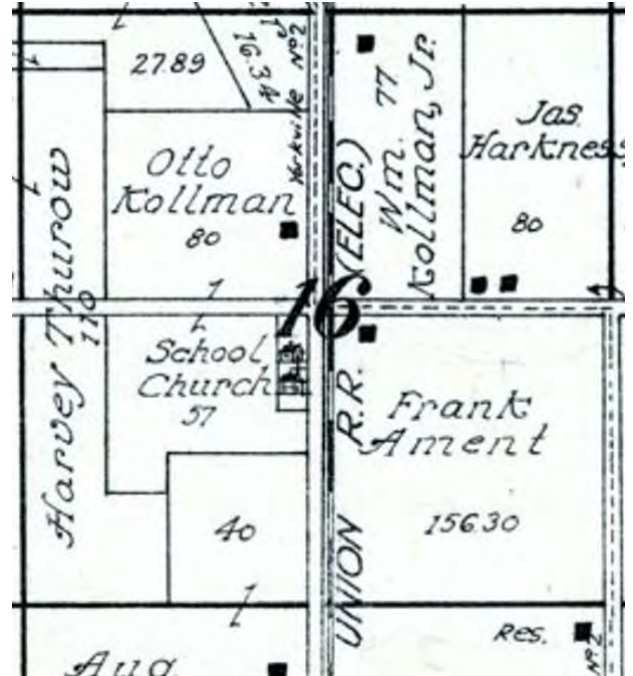
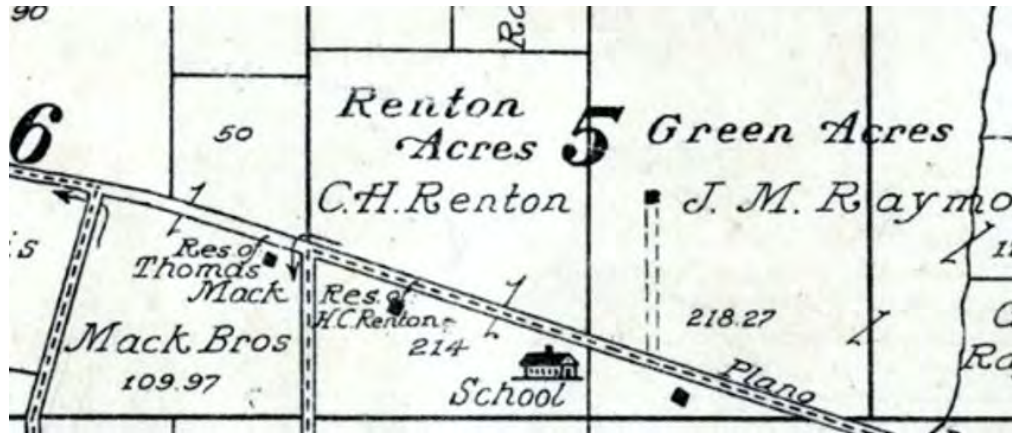

Research materials



KENDALL COUNTY COURT HOUSE, YORKVILLE, ILLINOIS.



"ORCHARD HOME,"
Residence of Peter J. Schlapp, Five Miles Southeast
of Oswego.



RESIDENCE OF O. C. KNUDSON,
YORKVILLE, ILLINOIS.

Database development



Microsoft Access database

Property Basic Data Entry Form 304

214

Sketchbook:

PIN Number: 02-03-400-005
 Street Number: 522
 Street Name: Dickson Road
 Congress_twp: T37N
 Congress_range: R7E
 Section_num: 3
 Parcel: NW 1/4 of SE 1/4
 Surveyor_initial:
 Survey_date:
 Name:
 Hist_func:
 Cur_func:
 Orientation:
 History_notes: House: 1939
 fieldnotes:
 add_structures:
 significance:

Extra Photo 1

Extra Photo 2

Records: 11 of 126 Search

PIN Number	Street No	Street Name	Section	Parcel	History notes	Name
				1 E 1/2 of NW 1/4		
				1 NE part NE 1/4		
02-01-200-005	6136	Galena Road		1 part SE 1/4 NE 1/4	House: 1918	
				1 middle part S 1/2		
02-01-300-016		Orchard Road		1 NW part SW 1/4	May be relatively recent construction.	
				1 NW part SW 1/4		
02-01-300-006	6920	Galena Road		1 part SW 1/4 SW 1/4	House: 1880	
02-01-200-001		U.S. Route 30		1		Jacob Keck Memorial Cemetery
02-02-101-004				2 W 1/2 of NW 1/4		
				2 W part of NE 1/4		
				2 E part NE 1/4		
02-02-476-006	7027	Galena Road		2 small part SE 1/4	House: 1979	
02-03-100-001	8822	U.S. Route 30		3 N 1/2 of NW 1/4	House: 1933	
02-03-200-001	8218	U.S. Route 30		3 NE 1/4	House: 1940	
02-03-300-002	421	Dickson Road		3 NE 1/4 of SW 1/4	House: 1928	
02-03-400-005	522	Dickson Road		3 NW 1/4 of SE 1/4	House: 1939	
02-03-481-006	1004	Dickson Road		3 SW 1/4 of SE 1/4	House: 1862	
				3 SE 1/4 of SW 1/4		
02-04-100-007	9338	U.S. Route 30		4 W 1/2 of NE 1/4	House: 1880	
02-04-200-001	9124	U.S. Route 30		4 E 1/2 of NE 1/4	House: 1875	
02-05-200-004	10034	Baseline Road		5 NE 1/4 of NE 1/4	House: 1960	
				5 SE 1/4		
02-05-300-005	10724	Galena Road		5 SW 1/4	House: 1890	
02-05-300-002	10502	Galena Road		5 small parcel	House: 1959	
02-05-400-012	10318	Galena Road		5 S part SE 1/4	House: 1963	
02-06-100-010	11843	Galena Road		6 part NW 1/4	House: 1850	
				6 part SE 1/4		
02-06-300-009	790	Eldamain Road		6 part SW 1/4	House: 1910	
02-07-100-011	1414	Eldamain Road		7 SW 1/4 of NW 1/4	House: 1900	
02-07-100-008	1327	Beecher Road West		7 SE 1/4 of NW 1/4	House: 1880	
02-07-200-001	1128	Beecher Road West		7 W 1/2 of NE 1/4	House: 1967	
				7 S 1/2 of SW 1/4		
02-08-100-005	1410	Beecher Road East		8 NW 1/4	House: 1900	
02-08-300-008	10791	Corneills Road		8 W part SW 1/4	House: 2000	
02-08-400-002	10417	Corneills Road		8 SW 1/4 of SE 1/4	House: 1960	
				9 W part NW 1/4		
02-09-100-013	115	Galena Road		9 N part NW 1/4	House: 1890	
02-09-200-003	9274	Galena Road		9 NE 1/4	House: 1890	
02-09-300-003	9619	Corneills Road		9 SE 1/4 of SW 1/4	House: 1940	

Unfiltered Search

Mapping



GIS

- GIS stands for geographic information system, a computerized methodology for organizing data geographically.
- Combines database-like organization of information with coordinate information (latitude and longitude)

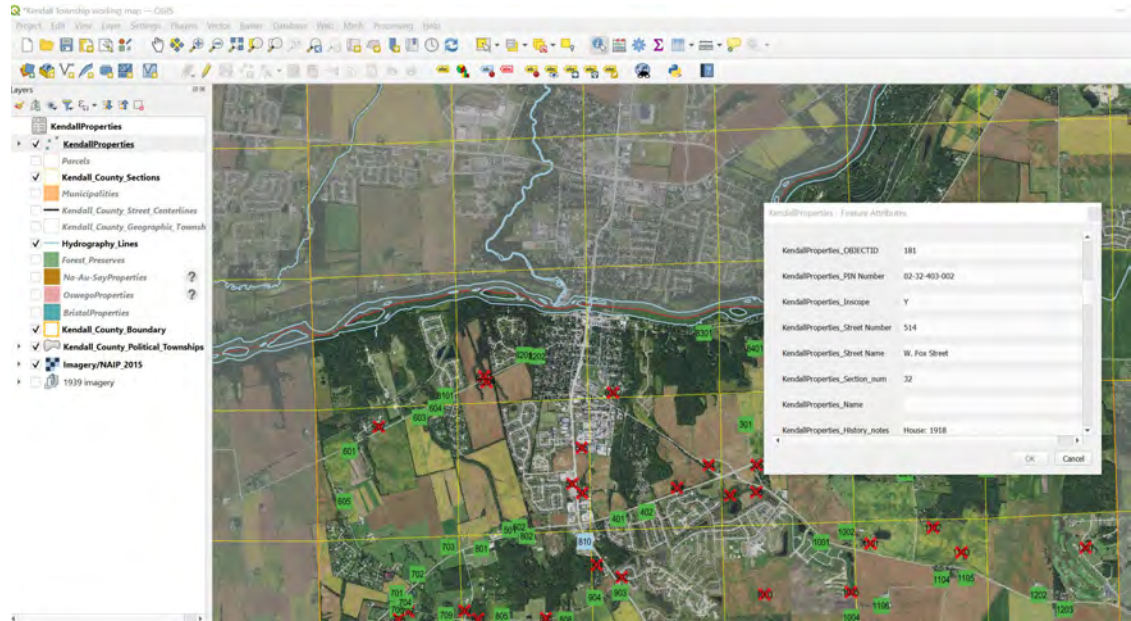

Aerial photographs (1939 to present)



Survey maps

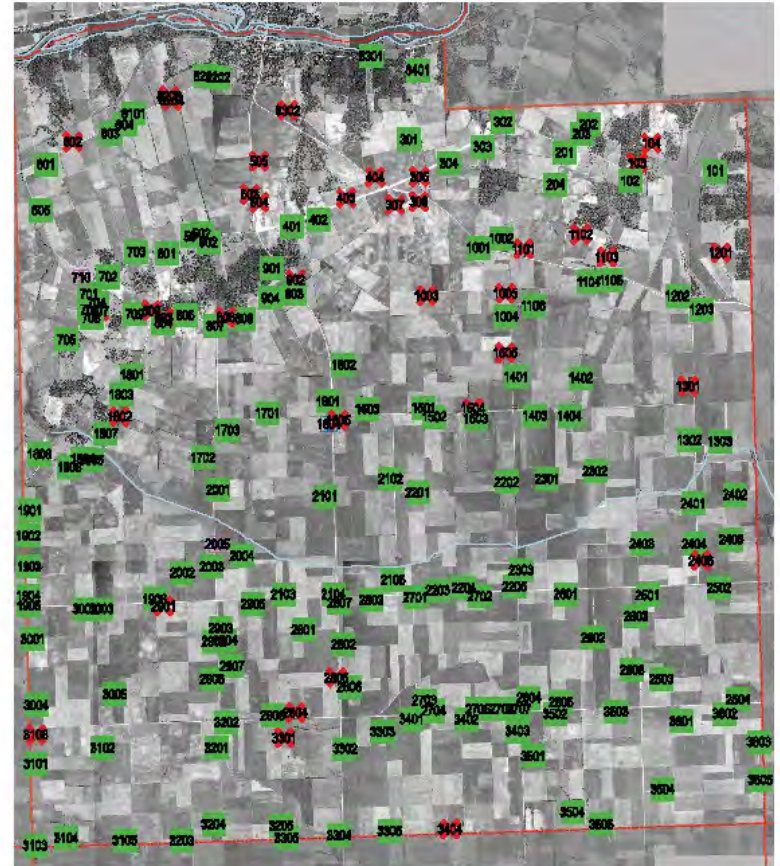

Field survey



Momence Township Rural Historic Structures Survey

Address Property Name

ID No. PIN No. Survey Date Surveyor(s)

T31N R14E

Section

Parcel

W 1/2 of NE 1/4

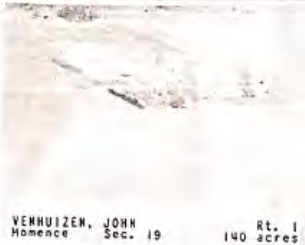

photo
0737-40

History Notes

[Walter Brown (1934) refers to this as the old home of Dr. David Lynds, an early settler, now owned by Mr. Peterson.]

1955



VENHUIZEN, JOHN
Momence, Sec. 19 Rt. 1
140 acres

List Each Structure List Materials of Foundation, Walls, Roof, Porches, and Trim

- ① Garage
conc. parq. found walls, wood trim, mtl windows
asp sh hip roof

- ② ~~main~~ out building
vertical mtl siding, mtl roof
wood post found.

- ③ outbuilding machine storage
conc. post found, mtl siding + roof





Field work

- Talk to owner/resident
- Gather any historical info
- Photograph each structure
- Make notes about building materials



Report preparation



Report preparation

- Correlate historical research and field survey information
- Finalize database and mapping
- Assess significance: Potential National Register-eligible, potential local landmark, contributing, non-contributing
- Compile narrative summary report

Typical report contents

- Background and methodology
- Historic context
 - History of local area in general
- Architectural context
 - Styles and construction types, building types
- Survey summary
 - Listing of potential landmarks
 - Description of notable properties
 - Tabulated survey results

HISTORIC AND ARCHITECTURAL SURVEY OF MOMENCE TOWNSHIP, KANKAKEE COUNTY, ILLINOIS

September 2020



MOMENCE TOWNSHIP HISTORIC STRUCTURES SURVEY

5967 East 5000N Road		Property Name	Novack Farmstead	
PIN No.	11-02-100-005	201	Survey Date	8/26/2020
			Surveyor(s)	TMP

Township T31N Range R14E Orientation West

Section 2 Parcel NW 1/4 of NW 1/4

Historic Use Agricultural

Current Use Agricultural

Significance Local landmark potential

Fieldnotes

A small portion of this farmstead extends into Yellowhead Township, PDN 04-35-300-027

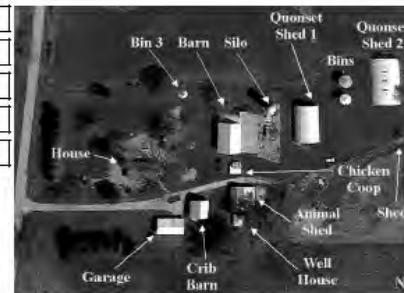

House

House Type	Bungalow
House Style	
Number of stories	1
Roof Type	Hip
Window Type(s)	Vinyl double-hung
Dormer Type	Hipped
Date or Approx. Decade of Construction	1930s
Foundation	Concrete masonry
Wall Material(s)	Vinyl siding
Trim Material(s)	Vinyl
Porch Material(s)	None
Roof Material(s)	Asphalt shingle
Significance	Contributing

Notes

Original front porch enclosed.



Outcomes

- Record of existing conditions
- Overview of history and historic themes
- Identification of potential landmarks or districts

Volunteers Needed!

- Field survey team: 1 professional and 1 volunteer
- Typically survey on weekdays, 9:00 to 5:00
- Estimated 158 sites in Kendall Township and 80 sites in Bristol Township. Estimated 16 to 20 days of field work.
- **10 or more volunteers needed!**



Volunteers Needed!

Matthew H. Asselmeier, Senior Planner
Kendall County Planning, Building & Zoning
111 West Fox Street
Yorkville, IL 60560
(630) 553-4139
masselmeier@kendallcountyil.gov

Kenneth Itle, Associate Principal
Wiss, Janney, Elstner Associates, Inc.
330 Pfingsten Road
Northbrook, IL 60062
(847) 753-6465
kitle@wje.com

PBZ Line Item ~~11001902~~
11001902-63830



Thanks for your order!

Order Number
425771

Business
Retail

Order Type
Rapid Pickup

Fulfillment Time
8/15/2022@5:00 PM

Date Received
Aug.8@3:42 PM

If you need assistance with your order, please contact:

Yorkville
Cafe #204010
1206 North Bridge Street
Yorkville, IL 60560
(630)553-2355

Customer Information

Ordered By
Matt Asselmeier

Phone Number
630-553-4139
MyPanera #
0

Order Summary

Pickup/Delivery
Rapid Pickup
People Served
1
Contact Name
Matt Asselmeier

Pickup Address
1206 North Bridge Street
Yorkville, IL 60560
Cafe Phone
(630)553-2355

Payment Information

Subtotal	\$41.38
Discount	\$0.00
Tax	\$0.00
Tip	\$0.00
Total	\$41.38

Type	Card Number	Name	Amount
VISA	[REDACTED]	scott koepfel	\$41.38

Signature _____ **Total** _____

Please consume, or refrigerate promptly

Order Checked By _____ **Bag** _____ **Of** _____

Order Details

Qty	Description	Price
<input type="checkbox"/> 1	Dzn Mix Cookies	\$20.69
<input type="checkbox"/> 1	Dzn Mix Cookies	\$20.69

Included in your order: Napkins, utensils and plates for 1 person. **Subtotal** \$41.38

From: [MICHAEL BORTEL](#)
To: [VALERIA TARKA](#); [DANIEL SEGGEBRUCH](#); [JAYNE M. BERNHARD](#); [Matt Asselmeier](#)
Cc: [JONATHAN PROULX](#); [JAKE MELROSE](#); [SUZANNE DERRICK](#)
Subject: [External]Commission Assistance & Mentoring Program (CAMP)
Date: Sunday, August 7, 2022 2:30:45 PM
Attachments: [HPC - 2017 CAMP PROPOSAL.docx](#)

CAUTION - This email originated from outside the organization. Do not click links or open attachments unless you recognize the sender and know the content is safe.

Good morning,

Let me introduce myself - I am the Chair of the Plainfield Historic Preservation Commission and I tried to call all of you on Friday afternoon, August 5 to speak to you about the possibility of co-sponsoring a **CAMP** on Historic Preservation in 2023 with Plainfield's Historic Preservation Commission for you, your Commissioners and other staff interested in learning more about historic preservation.

I was able to speak to Jayne Bernhard, the staff person at Joliet and Valeria Tarka, the new staff person at Oswego & introduced myself to both of them & told them that I would be sending out this email to the four area historic preservation Commissions - **Joliet, Kendall County, Oswego & Will County**. I have previously spoken to Matt Asselmeier & attended several meetings with the Kendall County HPC before they became one of Illinois' newest CLG communities & have spoken & worked with the new Chair of the Will County HPC, Dan Seggebruch.

I was appointed to Plainfield's Historic Preservation Commission in the Fall of 2004 after having retired from teaching high school for 34 years. My wife & I built a new house in Plainfield & moved there in 2002. As a teacher, I taught World History, World Geography, U.S. History & World Cultures. I was appointed Vice-Chairperson & was the only retired member of the Commission. Because of my interest in history, my research into local properties became valuable for the Commission & I have continued to pursue that passion & try to educate local residents about preservation & dispel pre-conceived & misinformation about historic preservation when ever & where ever possible. Initially I was a novice when it came to historic preservation however through mentoring by the Commission's former Chair & attending meetings & CAMPs I have become more knowledgeable & passionate about the subject. Since most of my Commissioners have full-time jobs & I am retired, I have considerably more time to do research where needed for the Commission, co-write Landmark nominations & work with our Staff on preservation business.

I attended my first **CAMP** training session at the 2013 all-day Illinois State Convention for preservation in Evanston and in the Spring of 2015, Plainfield & Will County co-sponsored a CAMP at the I & M Canal Office in Lockport on a Saturday morning which is the home of the Will County Historical Society. In 2017, Plainfield, Will County & Joliet sponsored another CAMP in downtown Plainfield at the 1892 Masonic Block Building. We had Commissioners & Staff from those 3 Commissions, plus other

Commissioners from Kankakee, Oswego, Lockport & Kendall County. Both **CAMPs** lasted all day with lunch & were partially paid by a CLG Grant from the State & National Park Service with the remainder paid by the 3 attending Commissions.

I recently spoke to Marie Snyder, the Program Manager for the National Alliance of Preservation Commissions (**NAPC**) to inquire about the cost of having a **CAMP** next year. The cost for a 2023 face-to-face **CAMP** with 3 presenters from NAPC covering 6 topics (**plus we can choose those topics**) that fits best with the needs of our Commissions would be \$7,000 & a CLG grant in the past covered 70% of the cost or \$4,900 & the remaining \$2,100 would be paid by the 3 Commissions at \$700 each & if we had 4 or 5 commissions attending, that cost would be lower. Camps normally accommodate 30 & extra attendees would pay \$35 each plus the cost of lunch - but we will worry about that later since our previous experiences has been that not all Commissioners/staff are able to attend either during the week or wish to give up a Saturday since most Commissioners work full-time during the week. I do know that in Plainfield we have 2 new Staff & possibly 1 new Commissioner & our Commission was recently been reduced to 7 from 9 & I believe that Oswego also has a Commission of 7, Kendall County has 6, Joliet & Will County each have 9.

Right now I am asking which Commissions might be interested in co-sponsoring with Plainfield to create a CAMP Meeting in 2023? - Send me an email or give me a call on my cell. I have also attached a copy of the 2017 Camp proposal

Three other notes for interested Chairs/Staff -

1. **Landmarks Illinois** is sponsoring a meeting of the Suburban Preservation Alliance on Saturday, September 17 in Naperville at 9 - 11 am. The meeting is free & this is an attempt to get this organization back on track. If you are interested you should contact Bonnie McDonald at ***Landmarksillinois.org*** - ***(bmcDonald@landmarksillinois.org*** - ***312-515-1545)*** & mention that you would like to attend.

2. For those of you who are not familiar with ***NAPC - National Alliance of Preservation Commissions*** & their CAMPs or website, I offer you this.....***NAPC can provide additional digital copies of their Alliance Review - NAPC quarterly journal to your Commission members & there are individual memberships as well as memberships for the City or Village Commission; NAPC, P.O.Box 1011, Virginia Beach, Virginia 23451 - 757-802-4141; napcommissions.org*** You can also reach out to Marie Snyder - ***marie@napcommission.org*** - Program Manager & Stephanie Paul - ***stephanie@napcommissions.org*** - Program Director - both can be reached at ***757-802-4141***

3. Also Commission members & Staff may want to join ***The National Trust for Historic Preservation*** - they have a quarterly magazine celebrating preservation &

locally they

have been instrumental in putting the ***Farnsworth House in Plano, IL*** back in order after recent floods few years ago. If you have never visited this historic house, you should!

SavingPlaces.org

Mike Bortel

Chair - Plainfield Historic Preservation Commission



2017 CAMP PROPOSAL

Plainfield, Joliet, Will County Historic Preservation Commissions

Timeline:

We have secured a site to host the 2017 **CAMP** presentation – we will use the second floor of the 1892 Masonic Block Building in Plainfield’s Downtown Historic District which was placed on the National Register of Historic Places in September 2013. The building was built by the Masons, who are still the owners – construction was begun in March 1892 and completed in November 1892. The building was recently restored to its original 1892 appearance and was designated a local Village Landmark in October 2014.

For lunch we would like to walk the attendees and **CAMP** personnel over to the recently restored 1899 Opera House and eat in the restaurant that occupies the second floor of the 1899 building along with the 2016 addition that houses the kitchen, bathrooms, elevator and offices

Participants:

The three Historic Preservation Commissions listed above have agreed to sponsor a Commission Assistance & Mentoring Program (**CAMP**) for 2017. Each Commission has 9 members plus a staff person to provide logistical support and who acts as a Liaison between the Commission and their local Governmental body to which they provide the necessary expertise in historic preservation. There are a total of 30 possible participants that could ideally be included in the **CAMP** presentation, however it is unlikely that a date for our proposed **CAMP** could possibly accommodate every member. Once the date has been set, the chairs of each Commission can poll their members to ascertain the number of Commissioners that can attend and should we have less than 30 participants, we will reach out to other area local Historic Preservation Commissions and invite their members to fill our quota of 30 participants for this **CAMP**:

Oswego HPC Kendall County HPC Lockport HPC Naperville HPC
Aurora HPC Kane County HPC St. Charles HPC Geneva HPC

In April 2015, the Historic Preservation Commissions of Will County and Plainfield sponsored a **CAMP** in Lockport at the I&M Canal Office which is the home of the Will County Historical Society. Five Commissioners from Plainfield attended that **CAMP** and 3 other Commissioners had attended the **CAMP** program at the State Conference held in Evanston in 2013. Within the past eighteen months, the Plainfield Historic Preservation Commission has added two new Commissioners and has gained a new Staff person who has very limited formal training in Historic Preservation after our previous staff person took a new position in Antioch, Illinois. Our Commissioners who have attended these **CAMP** presentations have learned a great deal and are willing to attend these programs provided they can adjust their schedules; thus we have a need and are hoping to get everyone on board with this Camp. The Joliet HPC is looking for a new planner/secretary and hopefully their new hire might be onboard when we convene this **CAMP** and their current staff person along with their Commissioners would also benefit. The Staff Person for Will County HPC worked with the Plainfield HPC to set up the Spring 2015 conference and when we received the email notifying the CLG Commissions of this **CAMP** opportunity, we agreed to look for a third local sponsor and ask our Commissioners if they might be interested in attending.

Budget:

The 3 sponsoring Commissions will equally share the 30% local share expense of the **CAMP** or \$700 each and each Commission's attending participants will have their meals paid by their respective communities; the cost for each meal would be between \$10 - \$20 each. The probabilities exist that we would need to invite additional Commissioners from neighboring CLG communities to reach our quota of 30 participants since finding that date when all Commissioners would be available on any given Saturday. We would invite Commissioners from those Commissions listed under Participants to give them the opportunity to benefit from this experience and have their Community pay for their individual Commissioner's workshop fee and lunch

CAMP Topics:

Based on a list of programs and topics listed on the website for CAMP, it seems appropriate that the CAMP personnel could cover these topics for our personalized day-long program:

CAMP CORE

1. Building Public Support
2. Standards & Guidelines
3. Hands on Design Review Exercise
4. Procedures & Process Sessions
5. CAMP for Real Estate Professionals

Staff Personnel:

Jonathan Proulx, Plainfield Senior Planner – 815-609-6139 – jproulx@goplainfield.com

Michael J. Schwarz, Joliet Planning Director – 815-724-4041 – mschwarz@jolietcity.org

Janine Wilkosz, Will County Preservation Manager – 815-774-7896 – jwilkosz@willcountylanduse.com

Contact person:

Mike Bortel, Chairman of Plainfield HPC – [REDACTED]



Abraham Lincoln

PRESIDENTIAL LIBRARY AND MUSE

[Shopping](#) > [Event Details](#)

24th Annual Conference on Illinois History -
 Conference Registration
 Thursday October 6 at 8:30am 
 Prices: \$0.00 - \$90.00
 Share This:

Abraham Lincoln Library Atrium
 112 North 6th Street
 Springfield, IL 62701
[Map & Directions](#)
 Phone: 2175588844
 Email: clare.thorpe@illinois.gov
 Website:
<https://www.PresidentLincoln.illinois.gov>

Conference on Illinois History

The 24th Conference on Illinois History is an annual conference hosted by the Abraham Lincoln Presidential Library and Museum, highlighting the research of any aspect of Illinois's history, culture, politics, geography, or archaeology.

All sessions will be held at the Abraham Lincoln Presidential Library. Attendees may visit the museum for the reduced rate of \$10 per person.

Credit card sales only. No cash or check will be accepted.

(Conference sessions begin at 8:30am and run until 5:00pm each day.)

Type	Price	Fee	Quantity
Member Thursday & Friday	\$80.00	\$0.00	<input type="text" value="0"/>
Member Thursday Only	\$40.00	\$0.00	<input type="text" value="0"/>
Member Friday Only	\$40.00	\$0.00	<input type="text" value="0"/>
Thursday & Friday	\$90.00	\$0.00	<input type="text" value="0"/>
Thursday Only	\$50.00	\$0.00	<input type="text" value="0"/>
Friday Only	\$50.00	\$0.00	<input type="text" value="0"/>
Student Thursday & Friday	\$45.00	\$0.00	<input type="text" value="0"/>
Student Thursday Only	\$25.00	\$0.00	<input type="text" value="0"/>
Student Friday Only	\$25.00	\$0.00	<input type="text" value="0"/>
Presenter/Moderator	\$0.00	\$0.00	<input type="text" value="0"/>

Count: 0

How would you like to receive your tickets?

E-Ticket/Print at Home

Free









And to 











powered by 

Click on 'Accept' to consent to the use of cookies for analysis or advertisement purposes or 'Refuse' to oppose these uses on this site at the exception of those strictly necessary.

Accept

Refuse

[3]	Name on the Register	Image		City or Town
1	Bristol Congregational Church	 More images	107 W. Center St.,  41°38'51"N 88°26'50"W	Yorkville
2	Chicago, Burlington & Quincy Railroad Depot	 More images	101 W. Main St.  41°39'44"N 88°32'17"W	Plano
3	Evelyn Site		Midway between Newark and Lisbon Center Rds., east of Big Grove Rd. ^[3]  41°31'49"N 88°30'26"W	Newark
4	Farnsworth House	 More images	14520 River Rd.  41°38'15"N 88°32'07"W	Plano
5	Kendall County Courthouse	 More images	109 W. Ridge St.  41°38'25"N 88°26'53"W	Yorkville

131	Name on the Register	Image		City or Town
6	Plano Hotel	 More images	120 W. Main St.  41°39'44"N 88°32'21"W	Plano
7	Reorganized Church of Jesus Christ of Latter Day Saints	 More images	304 S. Center Ave.  41°39'33"N 88°32'09"W	Plano
8	Albert H. Sears House	 More images	603 E. North St.  41°39'55"N 88°31'49"W	Plano
9	Lewis Steward House	 More images	611 E. Main St.  41°39'54"N 88°31'47"W	Plano
10	Yorkville School	 More images	201 W. Center St.  <u>41°38'52"N 88°26'53"W</u>	Yorkville

20 Historic sites to be marked

Kendall County Record

July 1, 1976

Plaques will be placed at 20 locations in Kendall County this year marking important spots in county history.

In Yorkville, a plaque will be placed on the lawn of the County Office Building marking the spot the time capsule is buried.

The site of the first Kendall County Courthouse will be marked with a plaque. The home of Mr. and Mrs. Jesse Ketchum now stands on the property at the northeast corner of State Street and Fox Road in Yorkville. A private dwelling on the site was rented shortly after Kendall County was formed in 1841. At the time, \$30 was set aside for fitting up the courthouse. The original building consisted of a brick basement and a frame second story. It was tom down in 1898. That first courthouse, which housed county government until 1845, was the scene of the county's first murder trial and also the only slave auction in the county.

A plaque honoring the first mill in the county will be placed in the Yorkville City Park where that mill's stone now sits. The mill was started by John Schneider in 1834 along the Blackberry Creek.

The Yorkville Congregational Church, West Center Street, Yorkville, will be marked with a plaque as the oldest standing church in the county. The church traces its history back to early settlers in Pavillion in 1834. The present sanctuary of the church was dedicated in June 1855.

A plaque will also be placed on the Kendall County Record building, 222 S. Bridge St., Yorkville. It is the oldest existing business in the county. John R. Marshall printed the first issue of the Record on May 7, 1864 in the building, which now houses the Variety Shop. In 1868, he built the present building. Marshall's son, Hugh, and grandson's, John and Robert, published the paper until 1966, when it was sold to Howard Pine. Present owners are Jeff and Kathy Farren. Among early items in the Record were Civil War news and black-bordered pages announcing the assassination of President Abraham Lincoln in April, 1865.

A plaque in Oswego will mark it as the oldest village. It was laid out in 1835 by L.F. Arnold and L.B. Judson, who planned to name it Hudson. The name was changed in a vote by early settlers, some of whom were from Oswego, N.Y.

Oswego was the county seat from 1845 to 1864. Petitions had been sent to the state legislature asking for the change in January 1845 and in an election Sept. 1, 1845, Oswego received a majority of the votes for county seat. A contract was let to Luke W. Swan for the construction of a courthouse there, which was paid off in 1852. By 1859,

pressure grew to move the county seat to a more central location and in 1862 a site in Yorkville was chosen. The move was completed in 1864 after which the Oswego courthouse building was used as a village hall and later a school. Now the site is the location of the post office, bank and city park. Both Oswego plaques are at this site.

Two Indian reservations will be marked with Boulders, the Waish-kee-shaw in NaAuSay and Mo-ah-way in Oswego Township. Waish-kee-shaw, a Potowatomi, was the wife of David Laughton who it is believed settled in the county about 1828. She was granted one and a half section at or near the source of the Aux Sable Creek in an 1829 treaty. Mo-ah-way was granted one quarter section adjoining the north edge of Waish-kee-shaw land in the same treaty. There is no information available now on Mo-ah-way, but it is believed that the name was a woman's.

The Chicago to Ottawa Trail will be marked with a plaque on the Ray Vickery farm on Chicago Road in Seward Township. This stagecoach route was established by Dr. John L. a weekly stage from Chicago to Galena through Little Rock. That route "is marked with a plaque on the Charles O. Smith property on Galena Road.

The home of Jean Morrison, Joliet Road, Lisbon, will be marked with a plaque, as it was once a stagecoach stop.

The V. F. W. hall in Plattville site will be marked as the site of the National Guard Armory.

Representatives of the Underground Railroad In Kendall County who lived in Lisbon will be commemorated at the Lisbon Grade School. Some of the early families believed to have worked on the underground were Bushnell, Kendall, Hills, Russell, Kellogg, Holderman, Sherrill, Wright, Caton and Moore families.

A plaque to mark the site of the first settlers' cabin, built by Robert Beresford, will go on the Gerald Vogen farm In Section 31 of Big Grove Township, in the far southwest corner of the county. Beresford arrived in the county in 1826 and settled In Holderman's Grove.

Another plaque has been dedicated at the Pearl Coomer home, 102 Van Buren in Newark, the site of the first store in the county. The store was opened by George Hollenback in 1831. Called Hollenback's Trading Post, it was burned down during the Blackhawk War.

The first schoolhouse in the county was opened in a log cabin at Pavillion in 1834. Classes were taught by C.B. Alvard. The plaque to mark this first school will be at the site of Pavillion.

A plaque will be placed on the Plano Molding building in Plano because the company had its beginnings in the early reaper company in the county's first factory.

WSPY's radio station will have a plaque as the county's first radio station.

The Illinois Midland Railroad, which ran for two miles between Newark and Millington
In about 1917, will be marked with a plaque.

Matt Asselmeier

From: Matt Asselmeier
Sent: Wednesday, September 14, 2022 7:59 AM
To: Itle, Ken
Subject: RE: [External]Kendall County Survey - volunteer training and field survey start-up

Ken:

There should be 4 volunteers (Susan Kritzberg (Bristol Township), Jeff Farren, Jeff Nakaerts, and Mark Harrington).

The HPC meets on September 19th and my meeting with Kendall Township is September 20th. Let's see how those meetings go and discuss the matter more on September 21st.

Thanks,

Matthew H. Asselmeier, AICP, CFM
Senior Planner
Kendall County Planning, Building & Zoning
111 West Fox Street
Yorkville, IL 60560-1498
PH: 630-553-4139
Fax: 630-553-4179

From: Itle, Ken <kitle@wje.com>
Sent: Tuesday, September 13, 2022 8:32 PM
To: Matt Asselmeier <masselmeier@kendallcountyil.gov>
Subject: [External]Kendall County Survey - volunteer training and field survey start-up

CAUTION - This email originated from outside the organization. Do not click links or open attachments unless you recognize the sender and know the content is safe.

Hello Matt:

I have not had anyone contact me directly, so the volunteers will just be the three people that have reached out to you. In addition to those three, will any of the commissioners also be available? (I hope a few of them can volunteer or be persuaded to help.)

Some possible training dates:

- Friday, September 23
- Wednesday, September 28
- Friday, September 30
- **Saturday, October 1** if a weekend is better.

Let me know what you think, and I can reach out to the volunteers (and any commissioners that we should include).

The training will just be a couple of hours. Morning is best. We can meet somewhere in Yorkville at 9:00 a.m. for a brief meeting, then carpool over to a couple representative sites to "learn by doing." Once everyone is trained, we can march forward with field survey work in October and November. (This is usually the perfect time of year for field work as the trees shed their leaves but it's not too cold yet.)

Kenneth M. Itle

Associate Principal

Wiss, Janney, Elstner Associates, Inc.

Engineers | Architects | Materials Scientists

330 Pflugstein Road, Northbrook, Illinois 60062

tel 847.272.7400 | direct 847.753.6465

www.wje.com

kitle@wje.com

From: Matt Asselmeier <masselmeier@kendallcountyil.gov>

Sent: Tuesday, September 13, 2022 2:36 PM

To: Itle, Ken <kitle@wje.com>

Subject: RE: [External]RE: Draft Volunteer Email

Ken:

Any update on when you would like to have the kick-off meeting?

Have you received any additional volunteers other than the ones I sent you?

Thanks,

Matthew H. Asselmeier, AICP, CFM

Senior Planner

Kendall County Planning, Building & Zoning

111 West Fox Street

Yorkville, IL 60560-1498

PH: 630-553-4139

Fax: 630-553-4179

From: Itle, Ken <kitle@wje.com>

Sent: Wednesday, August 17, 2022 4:07 PM

To: Matt Asselmeier <masselmeier@kendallcountyil.gov>

Subject: RE: [External]RE: Draft Volunteer Email

Uh, I'd rather skip those. You don't need me.

Kenneth M. Itle

Associate Principal

Wiss, Janney, Elstner Associates, Inc.

Engineers | Architects | Materials Scientists

330 Pflugstein Road, Northbrook, Illinois 60062

tel 847.272.7400 | direct 847.753.6465

pin	name	location	town	status	active	notes
02-26-300-006	Cowdrey Cemetery	SE SW Sec 26	Oswego	1.61 Re-Activat	Y	
02-24-401-003	Doud Cemetery	NW SE Sec 24	Oswego	0.58 Inact, Inat	N	
03-23-201-001	Evegreen Cemetery	NW NE Sec 23	Oswego	1.16 Inact, Inat	N	
03-01-351-001,03-02-400-005	Lincoln Memorial Cemetery	NE SE Sec 2 & NW SW Sec 1	Oswego	73.3 Active sinc	Y	
03-19-228-001	Oswego Cemetery	NW NE Sec 19	Oswego	6.75 Active	Y	
03-17-229-022	Pearce Cemetery	NW NE Sec 19	Oswego	2.2 Active	Y	
03-05-353-005	Wornley Cemetery	SW SW Sec 5	Oswego	0.75 Inact, Inat	N	
02-29-451-008	Elmwood Cemetery	SE SE Sec 29	Bristol	22.3 Active sinc	Y	
02-01-200-001	Keck Memorial Cemetery: 1841-1936	NW NE Sec 1	Bristol	1.13 Burials from	Y	
02-16-476-003	Oak Grove Cemetery	SE SE Sec 16	Bristol	4.76 Active	Y	
02-16-476-005	St Patricks Cemetery	SE SE Sec 16	Bristol	2.28 Active, Not	Y	
01-30-476-008	Hart Cemetery	SE SE Sec 30	Little Rock	0.11 Inact, Inat	N	
01-06-100-003	Hubbell Cemetery	SW NW Sec 6	Little rock	13.3 Despoiled	N	
01-06-200-002	Orbit Cemetery	NE NE Sec 6	Little Rock	11.4 Despoiled	N	
01-15-300-003,01-15-300-004,01-15-300-006,01-22-126-001,01-22-126-008	Piano Township Cemetery	SW SW Sec 15 & NW Sec 22	Little Rock	16.4 Active	Y	
06-18-200-003	Aux Sable Grove Cemetery	SE NE Sec 18	Na-Au-Say	4.55 Active	Y	
06-26-200-001	Bronk Cemetery	SE NW Sec 26	Na-Au-Say	1.5 Abandoner	N	
06-16-100-003	Sullivan Cemetery	W1/2 NE Sec 16	Na-Au-Say	45.3 Despoiled	N	
05-16-300-009	Cross Lutheran Cemetery	NE SW Sec 16	Kendall	16.4 Active	Y	
05-20-400-001	Immanuel Lutheran Cemetery	NW SE Sec 20	Kendall	2.25 Active	Y	
05-07-176-010	Pavillion Cemetery	NE NW Sec 7	Kendall	2.25 Active	Y	
04-30-335-013,04-31-126-001,04-31-126-002	Millington-Newark Cemetery	NE NW Sec 31	Fox	14.1 Active	Y	
04-08-200-008	Sacred Bluff Cemetery AKA Darnell Cemetery	SE NE Sec 8	Fox	1.47 Abandoner	N	
09-19-400-001	Plattville Lutheran Cemetery	NW SE Sec 19	Seward	3.33 Active	Y	
09-16-200-002	Seward Mound	SW NE Sec 26	Seward	3.37 Active	Y	
08-32-200-002	Munger Cemetery	E1/2 NW Sec 32	Lisbon	0.1 Abandoner	N	
08-02-176-001	Plattville Cemetery	SE SE Sec 2	Lisbon	5.11 Active	Y	
07-01-300-003,07-02-200-004	Helmar Lutheran Cemetery	NW NW Sec 1 & NE NE Sec 2	Big Grove	2.99 Active	Y	
07-27-300-002,07-27-300-004	West Lisbon Cemetery	NE SW Sec 27	Big Grove	6.17 Active	Y	
07-24-400-005,07-24-400-018,07-25-228-001	Lisbon Cemetery	SE SE Sec 24 & NE NE Sec 25	Big Grove	3.86 Active	Y	
03-26-300-003	Risen Lord Cemetery	SW Sec 26	Oswego	80.3 Active	Y	
01-35-251-001	Griswold Cemetery	SW NE Sec 35	Little Rock	1.09 Active	Y	
05-16-100-016	Cross Lutheran Cemetery	Unknown	Oswego	Active, Inat	Y	Approximate location - inactive before 1870
	Albert Hassel	SE NW Sec 26	Na-Au-Say	DE	N	Also known as Bronk. Also known as Bingham
	Bingham	SE NW Sec 26	Na-Au-Say	DE	N	Also known as Bronk. Also known as Albert Hassel.
	Bristol Burying Ground	SE SW Sec 28	Bristol	DE	N	This cemetery no longer exists. The gravestones were moved to Elmwood Cemetery in Yorkville.
	Collins Cemetery	SW NE Sec 26	Oswego	DE	N	
	Griswold Springs Cemetery	SW NE Sec 35	Little Rock	1.09 Active	Y	Also known as Griswold Cemetery.
	Hafenrichter Cemetery	SW SE Sec 14	Oswego	Active	Y	Also known as the Oswego Prairie Cemetery.
	Kohlman Cemetery	NE SW Sec 16	Kendall	Active	Y	Also known as Cross Lutheran Church Cemetery.
	Long Grove Cemetery	NE NW Sec 7	Kendall	Active	Y	Also known as Pavillion Cemetery.
	Millford Graveyard	NE NW Sec 31	Fox	Active	Y	Also known as Millington-Newark Cemetery
	Minhler Road Cemetery	NW SE Sec 24	Oswego	Inactive	N	Also known as Doud Cemetery.
	Nakusky Cemetery	SE NE Sec 18	Na-Au-Say	Active	Y	Also known as Aux Sable Grove Cemetery
	North Lisbon Cemetery	NE NE Sec 25	Big Grove	3.86 Active	Y	Also known as Lisbon Cemetery
	North Prairie Cemetery	NW NW Sec 1	Big Grove	Active	Y	Also known as Helmar Lutheran Cemetery
	Piano Cemetery	NE NW Sec 22	Little Rock	16.4 Active	Y	Also known as Piano Township Cemetery.
	Sandy Bluff Cemetery	SE SE Sec 30	Little Rock	0.11 Inactive	N	Also known as Hart Cemetery.
	Sprints Cemetery	SW SW Sec 1	Little Rock	DE	N	Despoiled and abandoned.
	Howland Cemetery	SW NE Sec 32	Little Rock	DE	N	Despoiled and abandoned.
	Oswego Cemetery	SW SW Sec 17	Oswego	DE	N	Despoiled and abandoned.
	Chapman Cemetery	SW NE Sec 26	Seward	Active	Y	Also known as Seward Mound.
	Union Burying Ground	SE NE Sec 18	Na-Au-Say	Active	Y	Also known as Nakusky Cemetery. Also known as Aux Sable Grove Cemetery.

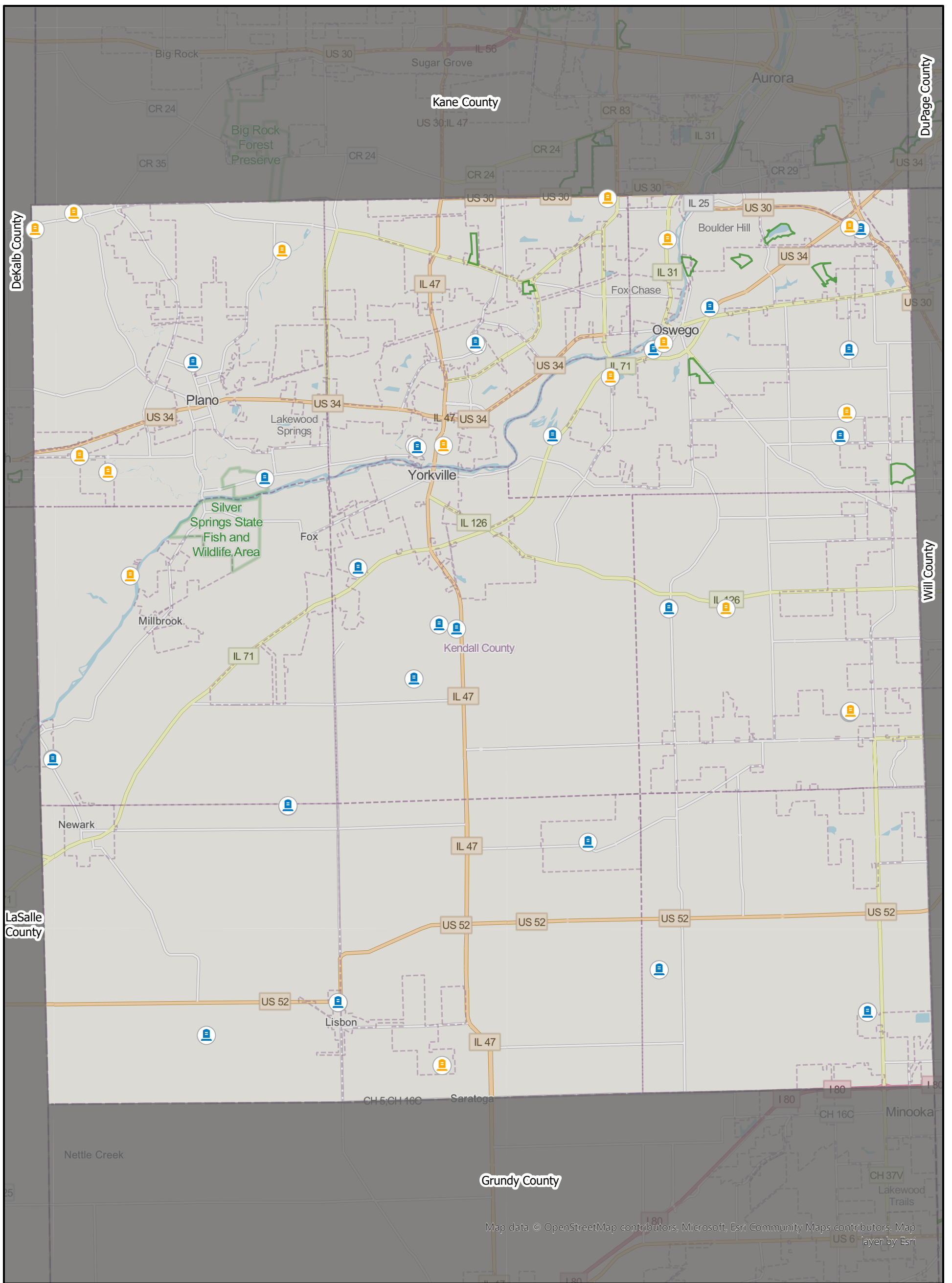

Active

 Yes

 No

Kendall County Cemeteries

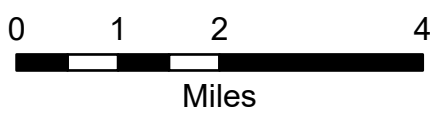

Kendall County GIS
 111 West Fox Street - Room 308
 Yorkville, Illinois 60560
 630.553.4212

Map data © OpenStreetMap contributors, Microsoft, Esri Community Maps contributors, Map layer by Esri

WEEKLY LIST OF ACTIONS TAKEN ON PROPERTIES: 8/12/2022 THROUGH 8/18/2022

Effective (4/10/20), the National Register program launched an electronic-only submission process for the duration of the COVID-19 situation while our staff and the staff of our preservation partners engage in extended telework operations. Instructions for (1) the organization of submissions and (2) how to access and upload submissions via the designated FTP site were distributed to recipients of this distribution list and posted on the National Register Website landing page at <https://www.nps.gov/subjects/nationalregister/index.htm>

KEY: State, County, Property Name, Address/Boundary, City, Vicinity, Reference Number, NHL, Action, Date, Multiple Name

ILLINOIS

Motor Row, Chicago, Illinois MPS,
MC100008000,
COVER DOCUMENTATION APPROVED, 8/15/2022

ILLINOIS, COOK COUNTY,
Chicago Vocational School,
2100 East 87th St.,
Chicago, SG100007996,
LISTED, 8/15/2022

ILLINOIS, COOK COUNTY,
James E. Plew Building,
2635-2645 South Wabash Ave.,
Chicago, MP100007999,
LISTED, 8/15/2022
(Motor Row, Chicago, Illinois MPS)

ILLINOIS, JO DAVIESS COUNTY,
Bishop's Busy Big Store-Lyric Opera House,
137 North Main St.,
Elizabeth, SG100008001,
LISTED, 8/15/2022

ILLINOIS, KANE COUNTY,
Crego, George M., Farm,
3S854 Finley Rd.,
Sugar Grove vicinity, SG100007994,
LISTED, 8/15/2022

ILLINOIS, KENDALL COUNTY,
Downtown Oswego Historic District,
Roughly bounded by one-half blk. north of Jackson St., the alleys immediately west and east of Main St.,
and one-half block south of Washington St.,
Oswego vicinity, SG100007995,
LISTED, 8/15/2022

Key to Prefix Codes:

AD - Additional documentation

BC - Boundary change (increase, decrease, or both)

FD - Federal DOE property under the Federal DOE project

FP - Federal DOE Project

MC - Multiple cover sheet

MP - Multiple nomination (a nomination under a multiple cover sheet)

MPS - Multiple Property Submission

MV - Move request

NL - NHL

OT - All other requests (appeal, removal, delisting, direct submission)

RS - Resubmission

SG - Single nomination

Matt Asselmeier

From: Fern Dell <ferndell1835@gmail.com>
Sent: Monday, August 29, 2022 10:50 AM
To: Eldon (Doc) Anderson; Arlene Corneils; Art & Charlene Behrens; Alice Olson; Ben Moe; Karen & Scott Breunig; Craig Stevenson; Carol J. Johnson; Lindsay & Chris Ammenhauser; Christopher Sharp; ROBERT & DIANE POTTINGER; Darald Nelson; Deb Wild; Dave & Kay Elmore; Darrell Peterson; Emma Smith; Michael Merline; Ed Hatteberg; Dave & Dolores Matel; Scott Gengler; Gary Harvala; Cathy Goddard; Mike Hopkins; Joan Hardekopf; Halfwaydown@yahoo.com; Joe Steffen; James Skinner; Kelvin & Patricia Johnson; Julie Kennedy; Karen Olson; Larry & Sharon Larson; Matt Asselmeier; Nadine Spear; James Norem; Kenneth & Annette Olson; Pam Watts; Roger Toftoy; Scott Koepfel; Victor Stott; Tom Martin; Tricia Wood; Jeff Wehrli
Subject: [External]Fern Dell Historic Association Annual Meeting

CAUTION - This email originated from outside the organization. Do not click links or open attachments unless you recognize the sender and know the content is safe.

Fern Dell will hold their Annual meeting on Monday, Oct 3 at 7 p.m. at the Fern Dell Museum.. A representative from North Grove School, Sycamore will present the program. Election of Directors will also be held.

It has been a busy year for Fern Dell. We look forward to seeing you. We will have copies of the New book, by Jeff Kehoe, about the Illinois Midland Railway, also copies of the DVD of the Illinois Midland Railroad. There are new displays in the museum.
For more information please call Marilynn at 815-736-6190

From: [Susan Kritzberg](#)
To: [Matt Asselmeier](#)
Subject: [External]OPEN HOUSE at the Chapel on the Green
Date: Wednesday, September 7, 2022 1:03:26 PM

CAUTION - This email originated from outside the organization. Do not click links or open attachments unless you recognize the sender and know the content is safe.

Hello Matt,

Attached is an invitation to join the Chapel on the Green for an OPEN HOUSE on September 25, 2022 from 1 - 3 p.m.
We will be honoring the late Elmer G. Dickson, and recognizing his generous financial contribution to the Chapel.

Please share this invitation with others in your department - or anyone you may know who is interested in historic preservation here in Kendall County. We look forward to seeing you there!

Best Regards,
Susan Kritzberg
Chapel on the Green, nfp
107 W. Center St.
Yorkville, IL 60560

**Mark your calendars!*



Please join us at the

CHAPEL ON THE GREEN

107 West Center Street
Yorkville, IL 60560

for a special

OPEN HOUSE

Sunday

September 25, 2022

1:00 - 3:00 p.m.

The Chapel on the Green will recognize a substantial donation from the late Elmer G. Dickson during an open house on Sunday, Sept. 25 from 1 to 3 p.m. Visitors will be able to tour the building and enjoy refreshments. Dickson will be remembered during a brief program at 2 p.m.



A Kendall County native and 1949 graduate of Yorkville High School, Dickson went on to earn undergraduate and graduate degrees from the University of Illinois after his Air Force service. He taught at California State University at Chico for 20 years, ending as chairman of the Department of Finance and Marketing. In retirement, he furthered his lifelong interest in history and genealogy and started the website kendallkin.com. He died in 2018 and his wife, Sydney, in 2020.

Built in 1855 as the Bristol Congregational Church, Chapel on the Green is listed on the National Register of Historic Places. The building is now used for community meetings, programs, and is available as a wedding venue.

There is no admission charge for the open house and everyone is welcome.