

F.A. RTE:	SECTION	COUNTY	TOTAL SHEETS	SHEET NO.
CH 22	23-00172-00-TL	KENDALL	12	1
		ILLINOIS		

**INDEX OF SHEETS**

- 1 COVER SHEET
- 2 HIGHWAY STANDARDS, GENERAL NOTES, & SCHEDULES
- 3 SUMMARY OF QUANTITIES
- 4-12 TRAFFIC SIGNAL PLANS

**THIS PROJECT IS LOCATED IN:  
VILLAGE OF OSWEGO**

**KENDALL COUNTY HIGHWAY DEPARTMENT**

**PROPOSED  
TRAFFIC SIGNAL  
INSTALLATION PLANS**

**C.H. 22 (PLAINFIELD ROAD) & WOOLLEY ROAD INTERSECTION  
SECTION 23-00172-00-TL  
KENDALL COUNTY**

**TRAFFIC DATA**

**PLAINFIELD ROAD**  
POSTED SPEED 35 MPH /45 MPH  
ADT: 13,100 /8,150 (2019)

**WOOLLEY ROAD**  
POSTED SPEED 35 MPH  
ADT: 3,000 (2019)

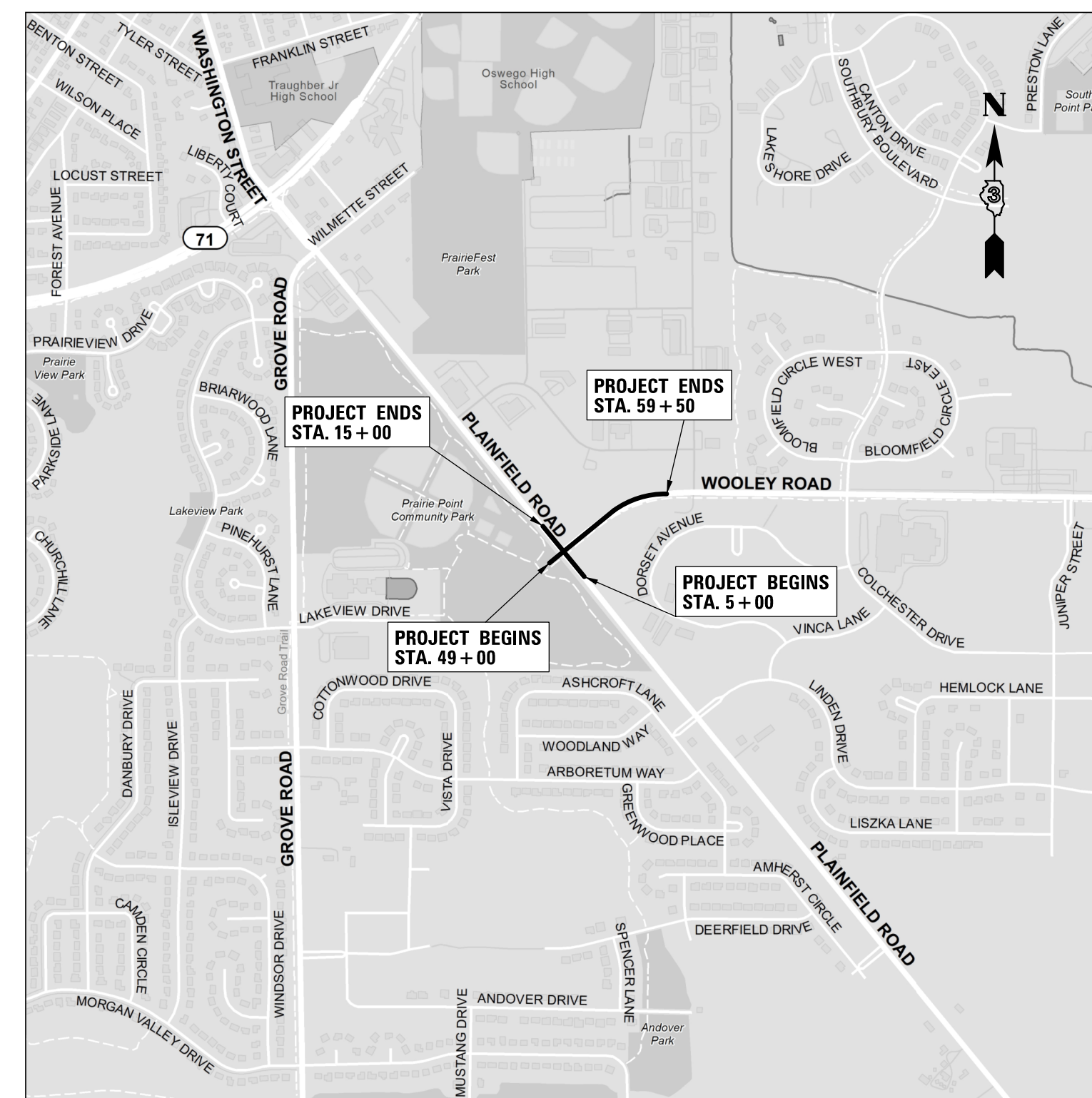

LOCATION MAP  
N.T.S.

GROSS & NET LENGTH = 2,050 FT. = 0.39 MILE

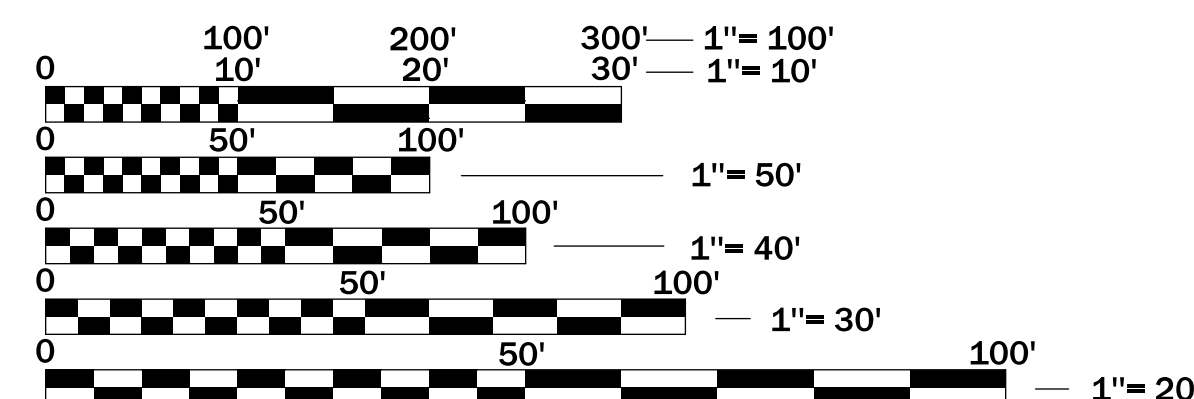

FULL SIZE PLANS HAVE BEEN PREPARED USING STANDARD ENGINEERING SCALES. REDUCED SIZED PLANS WILL NOT CONFORM TO STANDARD SCALES. IN MAKING MEASUREMENTS ON REDUCED PLANS, THE ABOVE SCALES MAY BE USED.

J.U.L.I.E.  
JOINT UTILITY LOCATION INFORMATION FOR EXCAVATION  
1-800-892-0123  
OR 811

*George M. Ziegler*  
ENGINEER 10/03/2023 DATE  
GEORGE M. ZIEGLER  
ILLINOIS REGISTRATION No. 062-045853  
EXPIRATION DATE: 11-30-2025

KENDALL COUNTY HIGHWAY DEPARTMENT

APPROVED *October 3, 2023*  
*Jim C. [Signature]*  
KENDALL COUNTY ENGINEER

**CHRISTOPHER B. BURKE ENGINEERING, LTD.**  
16221 W. 159th Street, Suite 201  
Lockport, Illinois 60441  
(815) 770-2850  
PROFESSIONAL DESIGN FIRM NO. 184-001175  
EXPIRATION DATE: 04/30/25

**TRAFFIC SIGNAL GENERAL NOTES:**

1. THE CONTRACTOR SHALL BE RESPONSIBLE FOR PROTECTING UTILITY PROPERTY DURING CONSTRUCTION OPERATIONS AS OUTLINED IN ARTICLE 107.39 OF THE STANDARD SPECIFICATIONS. A MINIMUM OF 48 HOURS ADVANCE NOTICE IS REQUIRED FOR NON-EMERGENCY WORK. THE JULIE NUMBER IS 800-892-0123.
2. ALL TRAFFIC CONTROL AND OTHER ADVISORY SIGNS NEEDED FOR CONSTRUCTION ARE TO BE FURNISHED BY THE CONTRACTOR IN ACCORDANCE WITH SECTION 701 OF THE STANDARD SPECIFICATIONS.
3. ALL VEHICLE AND PEDESTRIAN SIGNAL HEADS SHALL HAVE POLYCARBONATE BLACK HOUSING AND STEEL OR ALUMINUM BRACKETS.
4. TRAFFIC SIGNAL HEADS SHALL BE PROPERLY COVERED PRIOR TO INTERSECTION TURN-ON OR AS DIRECTED BY THE ENGINEER. THIS COST SHALL BE INCLUDED WITH THE COST OF THE ASSOCIATED TRAFFIC SIGNAL PAY ITEMS.
5. A 1/4" DIAMETER CONTINUOUS RODENT RESISTANT NYLON ROPE SHALL BE FURNISHED AND LEFT IN PLACE IN ALL CONDUITS BETWEEN HANDHOLES AND FOUNDATIONS OR CONTROLLER. THIS COST SHALL BE INCLUDED IN THE COST OF CONDUIT PAY ITEM.
6. THE CONTRACTOR SHALL ARRANGE FOR A FACTORY OR SUPPLIER REPRESENTATIVE TO BE PRESENT AT THE INTERSECTION WHEN THE SIGNAL IS TURNED ON. COST TO BE INCLUDED IN THE TRAFFIC SIGNAL CONTROLLER PAY ITEM.
7. ALL CONDUIT IN TRENCH SHALL BE PVC. GALVANIZED STEEL OR SCHEDULE 80 PVC SHALL BE USED UNDER PAVEMENT, STABILIZED SHOULDER, PAVED MEDIAN, PAVED DRIVEWAY, CURB AND/OR GUTTER, AND SIDEWALK. CONDUIT ATTACHED TO STRUCTURES SHALL BE GALVANIZED STEEL.
8. NO ADDITIONAL COMPENSATION WILL BE ALLOWED FOR PLACING CONDUIT AT A GREATER THAN 2' MINIMUM DEPTH TO AVOID OBSTACLES SUCH AS UNDERGROUND UTILITIES.
9. THE ELECTRICAL CONDUCTORS FOR ALL TRAFFIC SIGNAL HEADS SHALL BE SOLID, SOFT COPPER.
10. ALL THREADS OF BOLTS USED IN THE ASSEMBLY OF TRAFFIC SIGNAL COMPONENTS SHALL BE COATED WITH A NON-LEAD BASED ANTI-SEIZE COMPOUND, SIMILAR TO LEAD PLATE, PRIOR TO ASSEMBLY.
11. ALL HARDWARE SHALL BE TIGHTENED AND WELL SECURED, CABLES SHALL BE NEATLY WOUND IN HANDHOLES. CABLES SHALL BE NEATLY TRAINED IN THE CONTROLLER CABINET.
12. ALL TRAFFIC SIGNAL WIRING SHALL EXTEND FROM CONTROLLER TO SIGNAL. SPLICES IN HANDHOLE AND JUNCTION BOXES WILL NOT BE ALLOWED.
13. THE CONTROLLER CABINET SHALL BE PLACED SO THAT A TECHNICIAN MAY SEE THE INTERSECTION OVER THE TOP OF THE CABINET WHILE WATCHING THE COMPONENTS IN THE CABINET.
14. THE PROPOSED TRAFFIC SIGNAL CONTROLLER CABINET SHALL BE FURNISHED WITH A MANUAL CONTROL SWITCH AND MANUAL CONTROL CHORD WITHIN THE POLICE DOOR COMPARTMENT. THIS WORK SHALL BE INCLUDED IN THE CONTROLLER CABINET PAY ITEM.
15. THE CONTRACTOR SHALL PROVIDE A SELF-ADHERED PHASE DIAGRAM ON THE INSIDE OF THE CONTROLLER CABINET DOOR.
16. THE CONTRACTOR SHALL BE RESPONSIBLE FOR OBTAINING ELECTRICAL SERVICE FOR THE TRAFFIC SIGNALS. THE CONTRACTOR SHALL CONTACT THE UTILITY COMPANY PRIOR TO BEGINNING WORK TO OBTAIN THE UTILITY COMPANY REQUIREMENTS FOR THE SERVICE INSTALLATION.
17. THE ELEVATION OF THE TOP OF THE DOUBLE HANDHOLE SHALL BE LESS THAN THE ELEVATION OF THE TOP OF THE CONTROLLER FOUNDATION. THE DOUBLE HANDHOLES INSTALLED CLOSE TO THE ROADWAY SHALL NOT OPEN UP TOWARDS THE ROADWAY SO THE ELECTRICAL MAINTAINER IS NOT EXPOSED TO TRAFFIC WHEN WORKING.
18. ALL UNINTERRUPTIBLE POWER SUPPLIES SHALL BE EQUIPPED WITH ALPHA GUARD MONITORS.
19. ALL GROUNDING MATERIALS FOR CONCRETE FOUNDATIONS SHALL REFER TO SECTION 806 OF THE STANDARD SPECIFICATIONS.
20. ALL AREAS DISTURBED BY THE CONTRACTOR SHALL BE RESTORED WITH SEED OR SOD TO THE SATISFACTION OF THE ENGINEER. SEEDING OR SODDING SHALL NOT BE PERMITTED AT ANY TIME WHEN THE GROUND IS FROZEN, WET OR IN AN UNTILLABLE CONDITION.
21. THE SURGE PROTECTOR IN THE CONTROLLER CABINET SHALL HAVE AN INDICATOR LIGHT.
22. THE MAST ARM FOUNDATIONS SHALL BE LOCATED A MINIMUM 6' FROM THE FACE OF THE CURB OR A MINIMUM OF 18' FROM THE EDGE OF PAVEMENT TO THE FACE OF THE FOUNDATION WHERE THERE IS NO CURB, UNLESS OTHERWISE DIRECTED BY THE ENGINEER. IN CURB AREA, GET MORE THAN 6' IF POSSIBLE IF THE SIGNAL HEAD STILL LINES UP IN THE CENTER OF LANE.
23. ONE WEEK PRIOR TO SIGNAL TURN-ON FOR ALL DIRECTIONS, THE CHANGEABLE MESSAGE SIGNS SHOULD READ "NEW SIGNAL AHEAD / TURN ON DATE" FOR THREE WEEKS. AFTER THE SIGNALS ARE TURNED ON THE MESSAGE SIGN SHOULD READ "NEW SIGNAL AHEAD / BE PREPARED TO STOP", FOR FOUR WEEKS.
24. ALL MAST ARM MOUNTED SIGNAL HEADS ON AN INDIVIDUAL MAST ARM SHALL BE MOUNTED SO THAT THE RED INDICATIONS ARE LEVEL WITH EACH OTHER.
25. ALL SIGNAL HEADS SHALL HAVE BACKPLATES. BACKPLATES SHALL BE POLYCARBONATE, LOUVERED FORMED BACKPLATES WITH FLUORESCENT YELLOW SHEETING.

**HIGHWAY STANDARDS**

000001-08	STANDARD SYMBOLS, ABBREVIATIONS AND PATTERNS
701701-10	URBAN LANE CLOSURE, MULTILANE INTERSECTION
701801-06	SIDEWALK CORNER OR CROSSWALK CLOSURE
701901-08	TRAFFIC CONTROL DEVICES
720001-01	SIGN PANEL MOUNTING DETAILS
720006-04	SIGN PANEL ERECTION DETAILS
780001-05	TYPICAL PAVEMENT MARKINGS
805001-01	ELECTRICAL SERVICE INSTALLATION DETAILS
814001-03	HANDHOLES
814006-03	DOUBLE HANDHOLES
821101-02	LUMINAIRE WIRING IN POLE
857001-01	STANDARD PHASE DESIGNATION DIAGRAMS AND PHASE SEQUENCES
862001-01	UNINTERRUPTABLE POWER SUPPLY (UPS)
873001-02	TRAFFIC SIGNAL GROUNDING AND BONDING
877001-08	STEEL MAST ARM ASSEMBLY & POLE, 16' THRU 55'
877011-10	STEEL COMBINATION MAST ARM ASSEMBLY AND POLE, 16' THRU 55'
878001-11	CONCRETE FOUNDATION DETAILS
880006-01	TRAFFIC SIGNAL MOUNTING DETAILS

<b>PROFILE</b> SURVEYED _____ GRADES CHECKED _____ E.M. NOTED _____ STRUCTURE NOTATIONS CHKO	BY _____ DATE _____	<b>PLAIN</b> SURVEYED _____ ALIGNMENT CHECKED _____ RT. OF WAY CHECKED _____ CAD FILE NAME: B:\KENDALLCOUNTY\230085\Traffic\16.12 - 08R\23085.dgn	BY _____ DATE _____
NOTE BOOK NO. _____		NOTE BOOK NO. _____	

**CHRISTOPHER B. BURKE** ENGINEERING LTD.  
 16221 W. 159th Street, Suite 201  
 Lockport, Illinois 60441  
 (815) 770-8888



FILE NAME =	USER NAME = pandrews	DESIGNED - PA	REVISED -	<b>KENDALL COUNTY HIGHWAY DEPARTMENT</b>	<b>CH 22 (PLAINFIELD ROAD) AND WOOLLEY ROAD GENERAL NOTES AND LIST OF HIGHWAY STANDARDS</b>	F.A.P RTE.	SECTION	COUNTY	TOTAL SHEETS	SHEET NO.
N:\kendallcounty\230085\Traffic\2 - GEN	230085.dgn	DRAWN - FPB	REVISED -			CH 22	23-00172-00-TL	KENDALL	12	2
	PLOT SCALE = 20'	CHECKED - GMZ	REVISED -			CONTRACT NO.				
	PLOT DATE = 10/4/2023	DATE -	REVISED -			SCALE: 1" = N.T.S.	SHEET NO. OF SHEETS STA. TO STA.	FED. ROAD DIST. NO.	ILLINOIS	FED. AID PROJECT



### SUMMARY OF QUANTITIES

ITEM NO.	SP	CODE NO.	ITEM	UNIT	TOTAL QUANTITY
1		67100100	MOBILIZATION	L SUM	1
2		70102635	TRAFFIC CONTROL AND PROTECTION, STANDARD 701701	L SUM	1
3		70102640	TRAFFIC CONTROL AND PROTECTION, STANDARD 701801	L SUM	1
4		70107025	CHANGEABLE MESSAGE SIGN	CAL DA	30
5		72000100	SIGN PANEL - TYPE 1	SQ FT	87
6		72400100	REMOVE SIGN PANEL ASSEMBLY - TYPE A	EACH	2
7		72400310	REMOVE SIGN PANEL - TYPE 1	SQ FT	19
8		78009024	MODIFIED URETHANE PAVEMENT MARKING - LINE 24"	FOOT	80
9	SP	80500010	SERVICE INSTALLATION - GROUND MOUNTED	EACH	1
10	SP	81028240	UNDERGROUND CONDUIT, GALVANIZED STEEL, 4" DIA.	FOOT	357
11	SP	81028350	UNDERGROUND CONDUIT, PVC, 2" DIA.	FOOT	32
12	SP	81028370	UNDERGROUND CONDUIT, PVC, 3" DIA.	FOOT	185
13	SP	81028390	UNDERGROUND CONDUIT, PVC, 4" DIA.	FOOT	20
14		81400700	HANDHOLE, PORTLAND CEMENT CONCRETE	EACH	2
15		81400720	DOUBLE HANDHOLE, PORTLAND CEMENT CONCRETE	EACH	2
16		81702110	ELECTRIC CABLE IN CONDUIT, 600V (XLP-TYPE USE) 1/C NO. 10	FOOT	2171
17	SP	85000500	MAINTENANCE OF EXISTING FLASHING BEACON INSTALLATION	EACH	1
18		87301215	ELECTRIC CABLE IN CONDUIT, SIGNAL NO. 14 2C	FOOT	561
19		87301225	ELECTRIC CABLE IN CONDUIT, SIGNAL NO. 14 3C	FOOT	860
20		87301245	ELECTRIC CABLE IN CONDUIT, SIGNAL NO. 14 5C	FOOT	1120
21		87301255	ELECTRIC CABLE IN CONDUIT, SIGNAL NO. 14 7C	FOOT	2191
22		87301805	ELECTRIC CABLE IN CONDUIT, SERVICE, NO. 6 2 C	FOOT	98
23	SP	87301900	ELECTRIC CABLE IN CONDUIT, EQUIPMENT GROUNDING CONDUCTOR, NO. 6 1C	FOOT	791
24		87502500	TRAFFIC SIGNAL POST, GALVANIZED STEEL 16 FT.	EACH	4
25		87700250	STEEL MAST ARM ASSEMBLY AND POLE, 42 FT.	EACH	1
26		87702890	STEEL COMBINATION MAST ARM ASSEMBLY AND POLE 32 FT.	EACH	1
27		87702910	STEEL COMBINATION MAST ARM ASSEMBLY AND POLE 36 FT.	EACH	1
28		87702920	STEEL COMBINATION MAST ARM ASSEMBLY AND POLE 38 FT.	EACH	1
29		87800100	CONCRETE FOUNDATION, TYPE A	FOOT	20
30		87800200	CONCRETE FOUNDATION, TYPE D	FOOT	4

ITEM NO.	SP	CODE NO.	ITEM	UNIT	TOTAL QUANTITY
31		87800415	CONCRETE FOUNDATION, TYPE E 36-INCH DIAMETER	FOOT	46
32	SP	88040070	SIGNAL HEAD, POLYCARBONATE, LED, 1-FACE, 3-SECTION, BRACKET MOUNTED	EACH	2
33	SP	88040090	SIGNAL HEAD, POLYCARBONATE, LED, 1-FACE, 3-SECTION, MAST ARM MOUNTED	EACH	4
34	SP	88040110	SIGNAL HEAD, POLYCARBONATE, LED, 1-FACE, 4-SECTION, BRACKET MOUNTED	EACH	4
35	SP	88040120	SIGNAL HEAD, POLYCARBONATE, LED, 1-FACE, 4-SECTION, MAST ARM MOUNTED	EACH	4
36	SP	88040150	SIGNAL HEAD, POLYCARBONATE, LED, 1-FACE, 5-SECTION, BRACKET MOUNTED	EACH	2
37	SP	88040160	SIGNAL HEAD, POLYCARBONATE, LED, 1-FACE, 5-SECTION, MAST ARM MOUNTED	EACH	2
38	SP	88102825	PEDESTRIAN SIGNAL HEAD, POLYCARBONATE, LED, 1-FACE, BRACKET MOUNTED WITH COUNT DOWN TIMER	EACH	4
39	SP	88200510	TRAFFIC SIGNAL BACKPLATE, RETROREFLECTIVE	EACH	18
40	SP	88700200	LIGHT DETECTOR	EACH	2
41	SP	88700300	LIGHT DETECTOR AMPLIFIER	EACH	1
42	SP	88800100	PEDESTRIAN PUSH-BUTTON	EACH	4
43		89502385	REMOVE EXISTING CONCRETE FOUNDATION	EACH	2
44	SP	X0324085	EMERGENCY VEHICLE PRIORITY SYSTEM LINE SENSOR CABLE, NO. 20 3/C	FOOT	271
45	SP	X0325476	RADAR VEHICLE DETECTION SYSTEM	EACH	1
46	SP	X0325839	SIGNAL TIMING	L SUM	1
47	SP	X0327698	LED INTERNALLY ILLUMINATED STREET NAME SIGN	EACH	4
48	SP	X1400238	LUMINAIRE, LED, SPECIAL	EACH	3
49	SP	X8570226	FULL-ACTUATED CONTROLLER AND TYPE IV CABINET, SPECIAL	EACH	1
50	SP	X8620250	UNINTERRUPTABLE POWER SUPPLY AND CABINET, SPECIAL	EACH	1
51	SP	X1400424	ELECTRIC CABLE IN CONDUIT, STREET NAME SIGN, NO. 14 3C, TYPE SOOW	FOOT	730
52	SP	X8809005	LED SIGNAL FACE, LENS COVER	EACH	10
53	SP	XX005703	REMOVE EXISTING TRAFFIC SIGNAL EQUIPMENT, SPECIAL	L SUM	1
54	SP	XX005206	EXPLORATORY EXCAVATION	FOOT	20
55	SP	Z0013798	CONSTRUCTION LAYOUT	L SUM	1
56	SP	Z0033020	LUMINAIRE SAFETY CABLE ASSEMBLY	EACH	3

**CHRISTOPHER B. BURKE** ENGINEERING LTD.  
 16221 W. 159th Street, Suite 201  
 Greenwood Village 80441  
 (303) 770-8888  
 SURVEYED \_\_\_\_\_ DATE \_\_\_\_\_  
 ALIGNED \_\_\_\_\_  
 RT. OF WAY CHECKED \_\_\_\_\_  
 CAD FILE NAME: B:\MIDWEST\230085\Traffic\3 - SUM\230085.dgn  
 PLAN NO. \_\_\_\_\_  
 NOTE BOOK NO. \_\_\_\_\_  
 PROFILE SURVEYED \_\_\_\_\_ DATE \_\_\_\_\_  
 GRADES CHECKED \_\_\_\_\_  
 E.M. NOTED \_\_\_\_\_  
 STRUCTURE NOTATIONS CHKO

FILE NAME =	USER NAME = pandrews	DESIGNED - PA	REVISED -
N:\kendallcounty\230085\Traffic\3 - SUM	230085.dgn	DRAWN - FPB	REVISED -
	PLOT SCALE = 20'	CHECKED - GMZ	REVISED -
	PLOT DATE = 10/4/2023	DATE -	REVISED -

**KENDALL COUNTY  
HIGHWAY DEPARTMENT**

**CH 22 (PLAINFIELD ROAD) AND WOOLLEY ROAD  
SUMMARY OF QUANTITIES**

SCALE: 1" = N.T.S. SHEET NO. OF SHEETS STA. TO STA.

F.A.P. RTE.	SECTION	COUNTY	TOTAL SHEETS	SHEET NO.
CH 22	23-00172-00-TL	KENDALL	12	3
		CONTRACT NO.		
FED. ROAD DIST. NO.		ILLINOIS FED. AID PROJECT		

# TRAFFIC SIGNAL LEGEND

(NOT TO SCALE)

ITEM	EXISTING	PROPOSED	ITEM	EXISTING	PROPOSED	ITEM	EXISTING	PROPOSED
CONTROLLER CABINET			HANDHOLE -SQUARE -ROUND	 	 	SIGNAL HEAD -(P) PROGRAMMABLE SIGNAL HEAD		
COMMUNICATION CABINET			HEAVY DUTY HANDHOLE -SQUARE -ROUND	 	 	SIGNAL HEAD WITH BACKPLATE -(P) PROGRAMMABLE SIGNAL HEAD -(RB) RETROREFLECTIVE BACKPLATE	 	 
MASTER CONTROLLER			DOUBLE HANDHOLE			PEDESTRIAN SIGNAL HEAD AT RAILROAD INTERSECTIONS		
MASTER MASTER CONTROLLER			JUNCTION BOX			PEDESTRIAN SIGNAL HEAD WITH COUNTDOWN TIMER		
UNINTERRUPTABLE POWER SUPPLY			RAILROAD CANTILEVER MAST ARM			ILLUMINATED SIGN "NO LEFT TURN"/"NO RIGHT TURN"		
SERVICE INSTALLATION -(P) POLE MOUNTED			RAILROAD FLASHING SIGNAL			NUMBER OF CONDUCTORS, ELECTRIC CABLE NO. 14, UNLESS NOTED OTHERWISE. ALL DETECTOR LOOP CABLE TO BE SHIELDED		
SERVICE INSTALLATION -(G) GROUND MOUNTED -(GM) GROUND MOUNTED METERED	 	 	RAILROAD CROSSING GATE			GROUND CABLE IN CONDUIT, NO. 6 SOLID COPPER (GREEN)		
TELEPHONE CONNECTION			RAILROAD CROSSBUCK			ELECTRIC CABLE IN CONDUIT, TRACER NO. 14 1/C		
STEEL MAST ARM ASSEMBLY AND POLE			RAILROAD CONTROLLER CABINET			COAXIAL CABLE		
ALUMINUM MAST ARM ASSEMBLY AND POLE			UNDERGROUND CONDUIT (UC), GALVANIZED STEEL			VENDOR CABLE		
STEEL COMBINATION MAST ARM ASSEMBLY AND POLE WITH LUMINAIRE			TEMPORARY SPAN WIRE, TETHER WIRE, AND CABLE			COPPER INTERCONNECT CABLE, NO. 18, 3 PAIR TWISTED, SHIELDED		
SIGNAL POST -(BM) BARREL MOUNTED - TEMPORARY			SYSTEM ITEM			FIBER OPTIC CABLE -NO. 62.5/125, MM12F -NO. 62.5/125, MM12F SM12F -NO. 62.5/125, MM12F SM24F	  	  
WOOD POLE			INTERSECTION ITEM			GROUND ROD -(C) CONTROLLER -(M) MAST ARM -(P) POST -(S) SERVICE	   	   
GUY WIRE			REMOVE ITEM					
SIGNAL HEAD			RELOCATE ITEM					
SIGNAL HEAD WITH BACKPLATE			ABANDON ITEM					
SIGNAL HEAD OPTICALLY PROGRAMMED			CONTROLLER CABINET AND FOUNDATION TO BE REMOVED					
FLASHER INSTALLATION -(FS) SOLAR POWERED	 	 	MAST ARM POLE AND FOUNDATION TO BE REMOVED					
PEDESTRIAN SIGNAL HEAD			SIGNAL POST AND FOUNDATION TO BE REMOVED					
PEDESTRIAN PUSH BUTTON -(APS) ACCESSIBLE PEDESTRIAN PUSH BUTTON			DETECTOR LOOP, TYPE I					
RADAR DETECTION SENSOR			PREFORMED DETECTOR LOOP					
VIDEO DETECTION CAMERA			SAMPLING (SYSTEM) DETECTOR					
RADAR/VIDEO DETECTION ZONE			INTERSECTION AND SAMPLING (SYSTEM) DETECTOR					
PAN, TILT, ZOOM (PTZ) CAMERA			QUEUE AND SAMPLING (SYSTEM) DETECTOR					
EMERGENCY VEHICLE LIGHT DETECTOR			WIRELESS DETECTOR SENSOR					
CONFIRMATION BEACON			WIRELESS ACCESS POINT					
WIRELESS INTERCONNECT								
WIRELESS INTERCONNECT RADIO REPEATER								

PROFILE SURVEYED \_\_\_\_\_ DATE \_\_\_\_\_  
 NOTE BOOK \_\_\_\_\_  
 NO. \_\_\_\_\_  
 STRUCTURE NOTATIONS CHKO  
 CH 22 (PLAINFIELD ROAD) AND WOOLLEY ROAD  
 TRAFFIC SIGNAL LEGEND  
 16221 W. 159th Street, Suite 201  
 Loganville, Georgia 30041  
 (770) 770-8888  
**CB**  
**CHRISTOPHER B. BURKE**  
 ENGINEERING LTD.  
 SURVEYED \_\_\_\_\_ DATE \_\_\_\_\_  
 ALIGNED CHECKED \_\_\_\_\_  
 RT. OF WAY CHECKED \_\_\_\_\_  
 CADD FILE NAME: \\s01\cadd\13230085\Traffic\4 - LEGEND.dgn

PROFILE SURVEYED \_\_\_\_\_ DATE \_\_\_\_\_  
 NOTE BOOK GRADES CHECKED \_\_\_\_\_  
 NO. \_\_\_\_\_ STRUCTURE NOTATIONS CHKD \_\_\_\_\_  
 PLAN SURVEYED \_\_\_\_\_ DATE \_\_\_\_\_  
 NOTE BOOK ALIGNMENT CHECKED \_\_\_\_\_  
 NO. \_\_\_\_\_ RT. OF WAY CHECKED \_\_\_\_\_  
 CH 22 (PLAINFIELD ROAD) AND WOOLLEY ROAD EXISTING TRAFFIC SIGNAL EQUIPMENT REMOVAL PLAN  
 16221 W. 159th Street, Suite 201  
 Lockport, Illinois 60441  
 (815) 770-8888  
**CHRISTOPHER B. BURKE** ENGINEERING LTD.  
 SURVEYED \_\_\_\_\_ DATE \_\_\_\_\_  
 NOTE BOOK ALIGNMENT CHECKED \_\_\_\_\_  
 NO. \_\_\_\_\_ RT. OF WAY CHECKED \_\_\_\_\_  
 CH 22 (PLAINFIELD ROAD) AND WOOLLEY ROAD EXISTING TRAFFIC SIGNAL EQUIPMENT REMOVAL PLAN  
 16221 W. 159th Street, Suite 201  
 Lockport, Illinois 60441  
 (815) 770-8888  
**CHRISTOPHER B. BURKE** ENGINEERING LTD.

**REMOVAL NOTES:**

THE FOLLOWING ITEMS SHALL BE REMOVED BY THE CONTRACTOR, SHALL BECOME THE PROPERTY OF THE VILLAGE OF OSWEGO, AND SHALL BE DELIVERED BY THE CONTRACTOR TO THE VILLAGE OF OSWEGO PUBLIC WORKS FACILITY, 100 THEODORE DRIVE, OSWEGO, IL 60543 BETWEEN 7:00 AM AND 3:00 PM MONDAY THROUGH FRIDAY. THIS WORK SHALL BE INCLUDED IN THE CONTRACT UNIT PRICE FOR REMOVE EXISTING TRAFFIC SIGNAL EQUIPMENT, SPECIAL.

- 2 EACH RRFB POST (COMPLETE)
- 2 EACH ADVANCE FLASHING BEACON SIGN ASSEMBLY (COMPLETE)

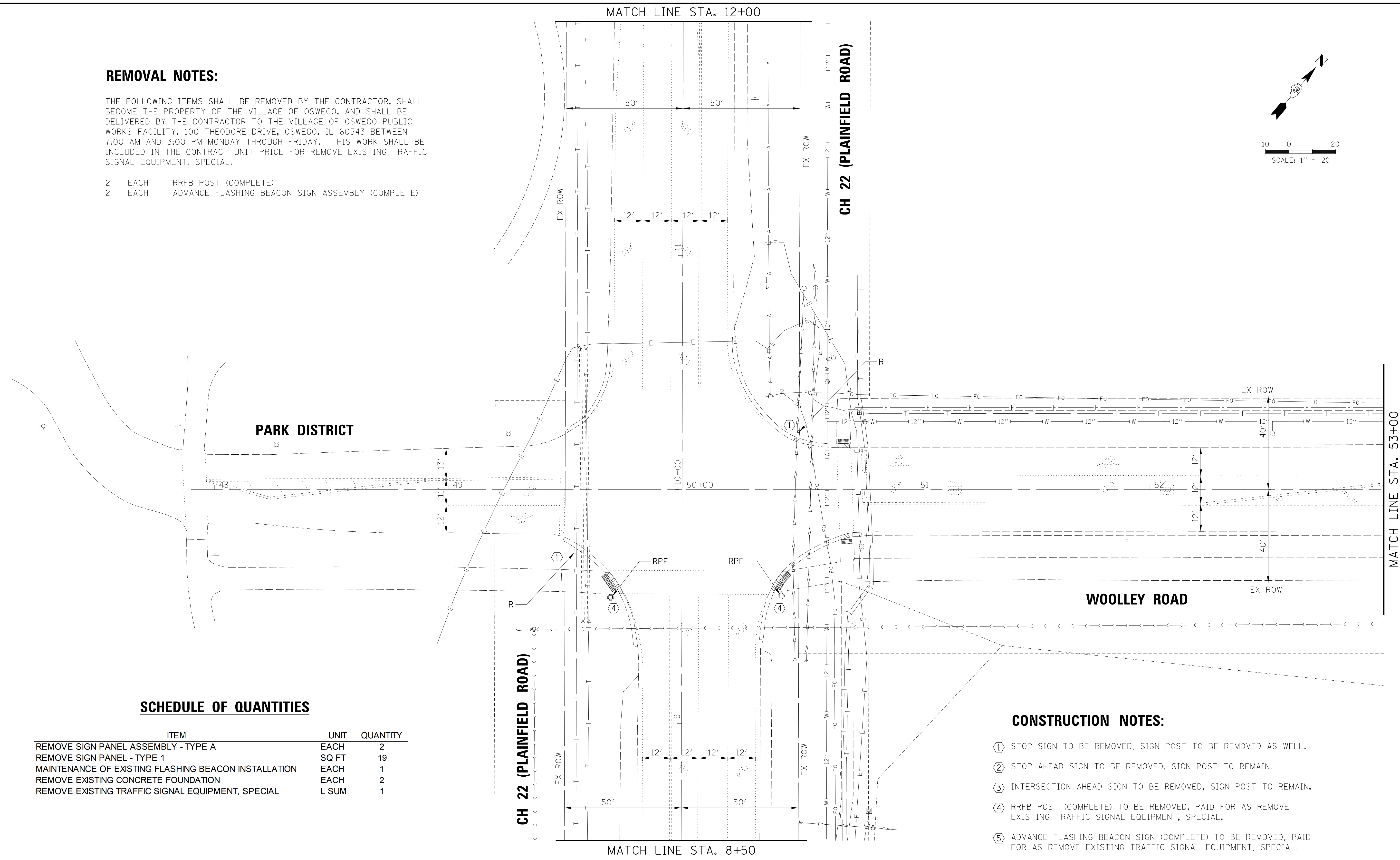
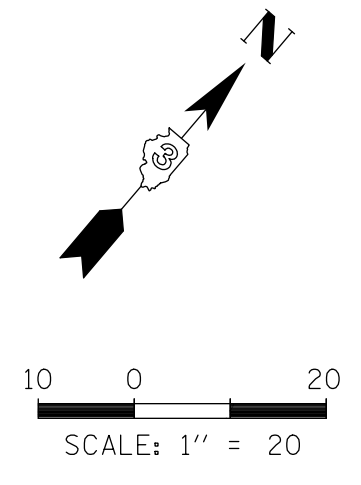

**SCHEDULE OF QUANTITIES**

ITEM	UNIT	QUANTITY
REMOVE SIGN PANEL ASSEMBLY - TYPE A	EACH	2
REMOVE SIGN PANEL - TYPE 1	SQ FT	19
MAINTENANCE OF EXISTING FLASHING BEACON INSTALLATION	EACH	1
REMOVE EXISTING CONCRETE FOUNDATION	EACH	2
REMOVE EXISTING TRAFFIC SIGNAL EQUIPMENT, SPECIAL	L SUM	1

**CONSTRUCTION NOTES:**

- ① STOP SIGN TO BE REMOVED, SIGN POST TO BE REMOVED AS WELL.
- ② STOP AHEAD SIGN TO BE REMOVED, SIGN POST TO REMAIN.
- ③ INTERSECTION AHEAD SIGN TO BE REMOVED, SIGN POST TO REMAIN.
- ④ RRFB POST (COMPLETE) TO BE REMOVED, PAID FOR AS REMOVE EXISTING TRAFFIC SIGNAL EQUIPMENT, SPECIAL.
- ⑤ ADVANCE FLASHING BEACON SIGN (COMPLETE) TO BE REMOVED, PAID FOR AS REMOVE EXISTING TRAFFIC SIGNAL EQUIPMENT, SPECIAL.

FILE NAME = N:\kendallcounty\230085\Traffic\5 - TS-01\REMI-230085.dgn	USER NAME = pandrews	DESIGNED - PA	REVISED -	<b>KENDALL COUNTY HIGHWAY DEPARTMENT</b>	<b>CH 22 (PLAINFIELD ROAD) AND WOOLLEY ROAD EXISTING TRAFFIC SIGNAL EQUIPMENT REMOVAL PLAN</b>	F.A.P. RTE.	SECTION	COUNTY	TOTAL SHEETS	SHEET NO.
PLOT SCALE = 20'	CHECKED - GMZ	REVISED -	CH 22			23-00172-00-TL	KENDALL	12	5	
PLOT DATE = 10/4/2023	DATE -	REVISED -	CONTRACT NO.							
			FED. ROAD DIST. NO.			ILLINOIS	FED. AID PROJECT			

PROFILE	SURVEYED	BY	DATE
NOTE BOOK	GRADES CHECKED		
NO.	STRUCTURE NOTATIONS CHK'D		
PLAN	SURVEYED	BY	DATE
NOTE BOOK	ALIGNMENT CHECKED		
NO.	RT. OF WAY CHECKED		
	DRAWN FILE NAME		

**CHRISTOPHER B. BURKE** ENGINEERING LTD.  
 16221 W. 158th Street, Suite 201  
 Lincoln, NE 68441  
 (402) 770-8686

PROJECT: 230085.dgn  
 DATE: 10/4/2023  
 DRAWN: FPB  
 CHECKED: GMZ

MATCH LINE STA. 8+50

CH 22 (PLAINFIELD ROAD)

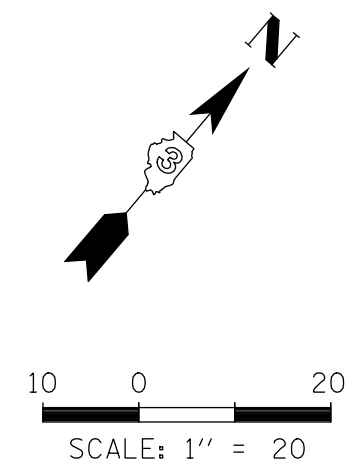
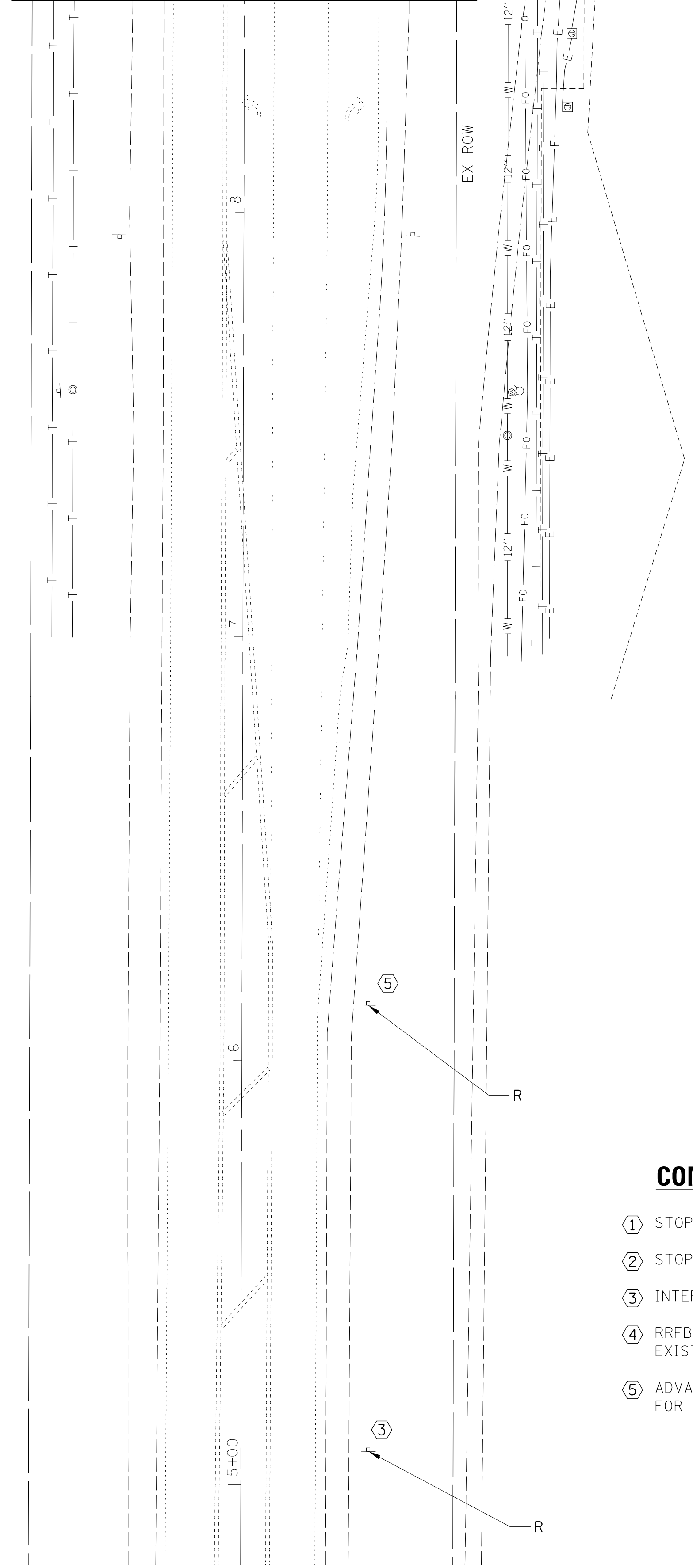

**CONSTRUCTION NOTES:**

- ① STOP SIGN TO BE REMOVED, SIGN POST TO BE REMOVED AS WELL.
- ② STOP AHEAD SIGN TO BE REMOVED, SIGN POST TO REMAIN.
- ③ INTERSECTION AHEAD SIGN TO BE REMOVED, SIGN POST TO REMAIN.
- ④ RRFB POST (COMPLETE) TO BE REMOVED, PAID FOR AS REMOVE EXISTING TRAFFIC SIGNAL EQUIPMENT, SPECIAL.
- ⑤ ADVANCE FLASHING BEACON SIGN (COMPLETE) TO BE REMOVED, PAID FOR AS REMOVE EXISTING TRAFFIC SIGNAL EQUIPMENT, SPECIAL.

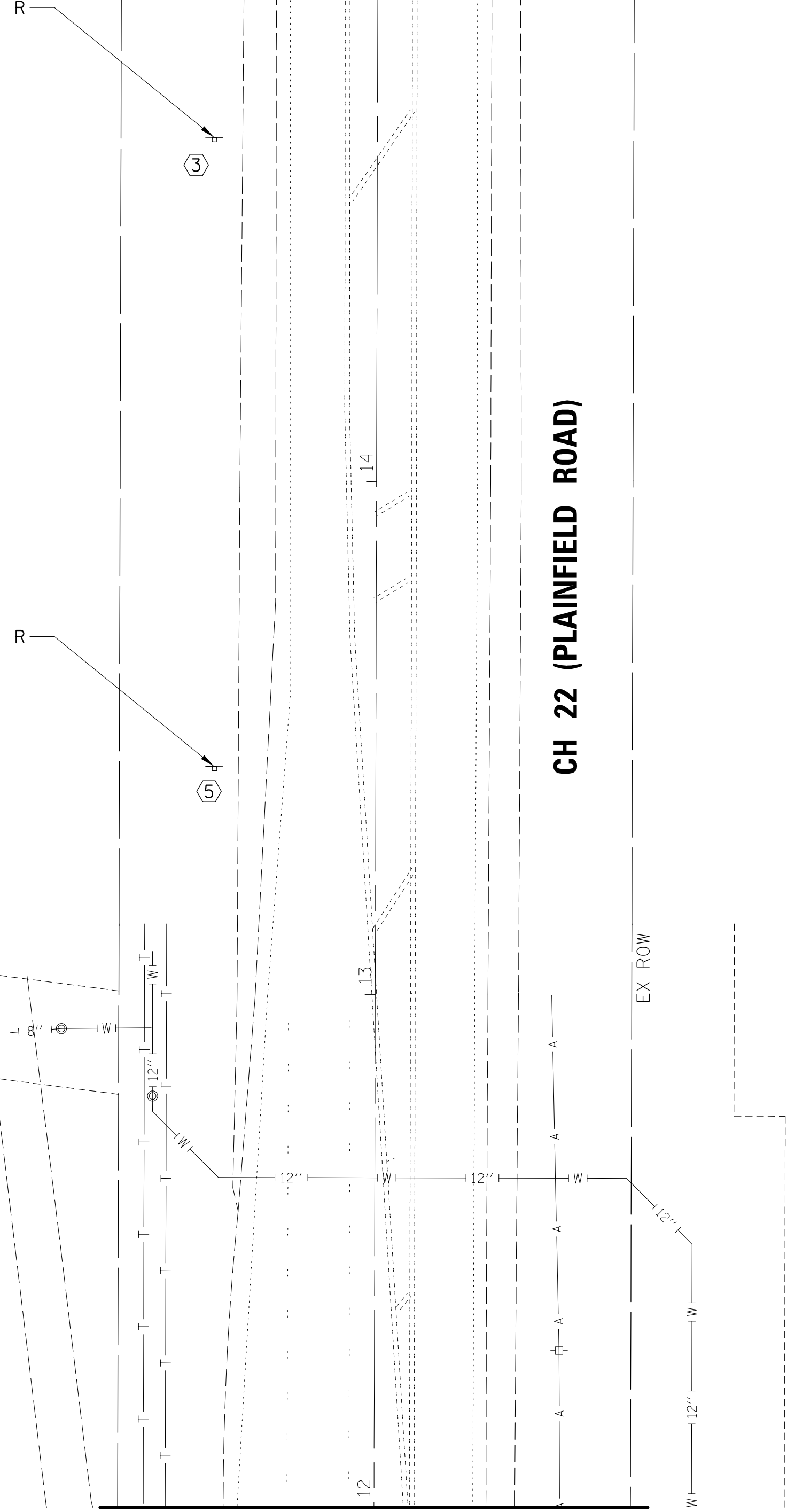

MATCH LINE STA. 12+00

CH 22 (PLAINFIELD ROAD)

FILE NAME =	USER NAME = pandrews	DESIGNED - PA	REVISED -
N:\kendallcounty\230085\Traffic\6 - TS-02_REM2-230085.dgn		DRAWN - FPB	REVISED -
	PLOT SCALE = 20'	CHECKED - GMZ	REVISED -
	PLOT DATE = 10/4/2023	DATE -	REVISED -

**KENDALL COUNTY  
HIGHWAY DEPARTMENT**

**CH 22 (PLAINFIELD ROAD)  
EXISTING TRAFFIC SIGNAL EQUIPMENT REMOVAL PLAN**

SCALE: 1" = SHEET NO. OF SHEETS STA. TO STA.

F.A.P R.T.E.	SECTION	COUNTY	TOTAL SHEETS	SHEET NO.
CH 22	23-00172-00-TL	KENDALL	12	6
FED. ROAD DIST. NO.		ILLINOIS FED. AID PROJECT		CONTRACT NO.



PROFILE SURVEYED \_\_\_\_\_ DATE \_\_\_\_\_  
 NOTE BOOK \_\_\_\_\_  
 NO. \_\_\_\_\_  
 ELEM. NOTED \_\_\_\_\_  
 STRUCTURE NOTATIONS CHKD \_\_\_\_\_  
 BY \_\_\_\_\_  
 DATE \_\_\_\_\_  
 PLAN SURVEYED \_\_\_\_\_ DATE \_\_\_\_\_  
 NOTE BOOK \_\_\_\_\_  
 NO. \_\_\_\_\_  
 RT. OF WAY CHECKED \_\_\_\_\_  
 CADD FILE NAME: \\kendallcounty\2300085\Traffic\7 - TS-03\_REM3-230085.dgn

**CHRISTOPHER B. BURKE** ENGINEERING LTD.  
 16221 W. 159th Street, Suite 201  
 Lincoln, Illinois 60441  
 (630) 770-8650

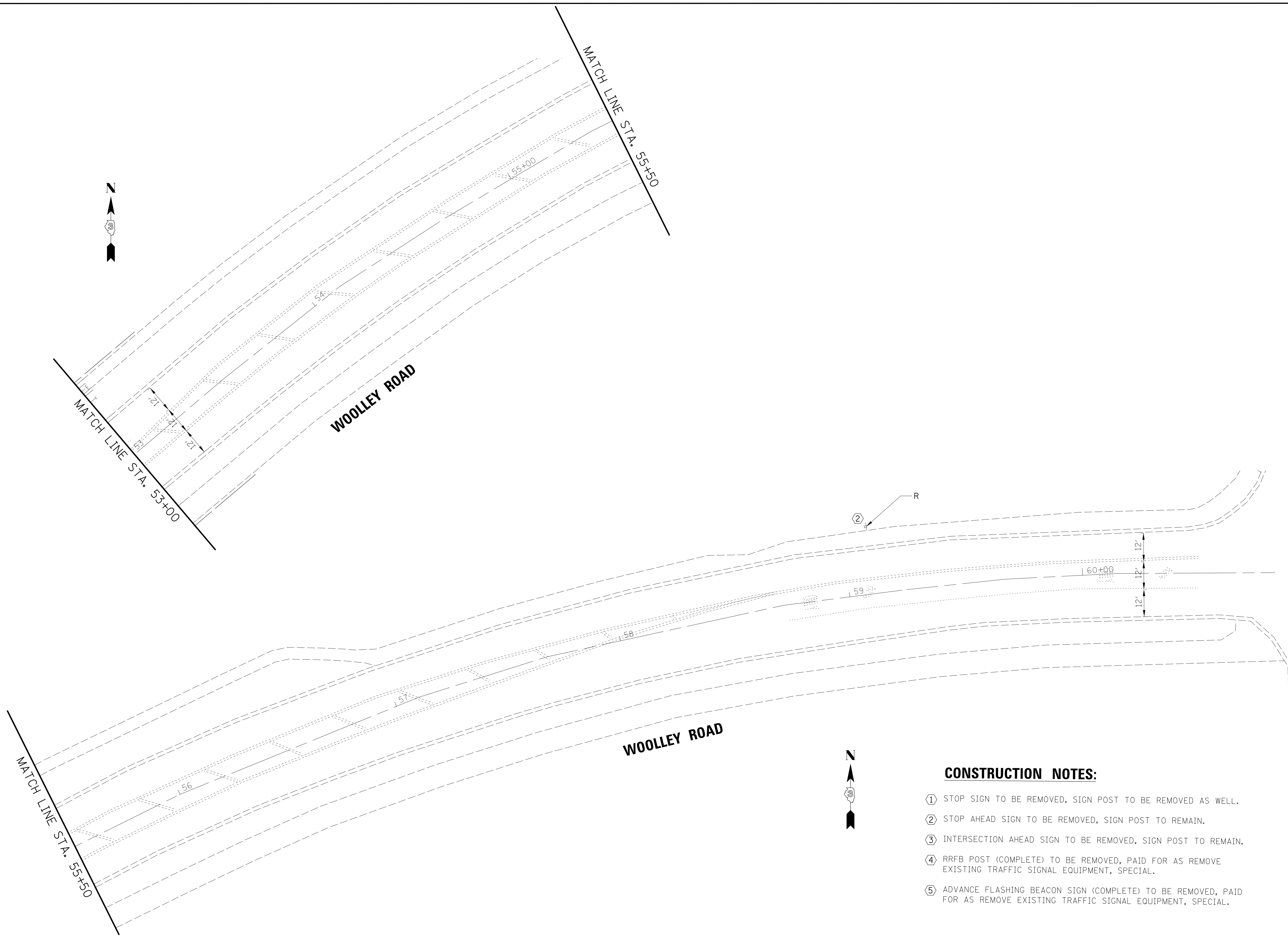

- CONSTRUCTION NOTES:**
- ① STOP SIGN TO BE REMOVED, SIGN POST TO BE REMOVED AS WELL.
  - ② STOP AHEAD SIGN TO BE REMOVED, SIGN POST TO REMAIN.
  - ③ INTERSECTION AHEAD SIGN TO BE REMOVED, SIGN POST TO REMAIN.
  - ④ RRFB POST (COMPLETE) TO BE REMOVED, PAID FOR AS REMOVE EXISTING TRAFFIC SIGNAL EQUIPMENT, SPECIAL.
  - ⑤ ADVANCE FLASHING BEACON SIGN (COMPLETE) TO BE REMOVED, PAID FOR AS REMOVE EXISTING TRAFFIC SIGNAL EQUIPMENT, SPECIAL.

FILE NAME = N:\kendallcounty\2300085\Traffic\7 - TS-03_REM3-230085.dgn	USER NAME = pandrews	DESIGNED - PA	REVISED -	<b>KENDALL COUNTY HIGHWAY DEPARTMENT</b>	<b>WOOLLEY ROAD EXISTING TRAFFIC SIGNAL EQUIPMENT REMOVAL PLAN</b>	F.A.P. RTE.	SECTION	COUNTY	TOTAL SHEETS	SHEET NO.	
	PLOT SCALE = 20'	DRAWN - FPB	REVISED -			CH 22	23-00172-00-TL	KENDALL	12	7	
	PLOT DATE = 10/4/2023	CHECKED - GMZ	REVISED -			CONTRACT NO.					
		DATE -	REVISED -			SCALE: 1" =	SHEET NO. OF SHEETS	STA. TO STA.	FED. ROAD DIST. NO.   ILLINOIS FED. AID PROJECT		

PROFILE SURVEYED BY DATE  
 GRADES CHECKED BY NOTED  
 STRUCTURE NOTATIONS CHK'D  
 NOTE BOOK NO.  
 PLAN SURVEYED BY DATE  
 ALIGNMENT CHECKED BY  
 RT. OF WAY CHECKED BY  
 CADD FILE NAME: N:\KENDALLCOUNTY\230085\TRAFFIC\8 - TS-04.TSD1-230085.dgn  
 CH 22 (PLAINFIELD ROAD) ENGINEERING LTD.  
 16221 W. 159th Street, Suite 201  
 Lockport, Illinois 60441  
 (815) 770-8685

SCHEDULE OF POLE/MAST ARM ASSEMBLIES

LOCATION	LENGTH
A	36.0'
B	16.0'
C	42.0'
D	16.0'
E	32.0'
F	16.0'
G	38.0'
H	16.0'

SCHEDULE OF SIGNAL HEAD QUANTITIES

LOCATION	ITEM	UNIT	QUANTITY
2, 5, 9, 12	SH, 1F, 3S, MAM	EACH	4
15, 17	SH, 1F, 3S, BM	EACH	2
1, 4, 8, 11,	SH, 1F, 4S, MAM	EACH	4
3, 7, 10, 14	SH, 1F, 4S, BM	EACH	2
6, 13	SH, 1F, 5S, MAM	EACH	2
16, 18	SH, 1F, 5S, BM	EACH	2

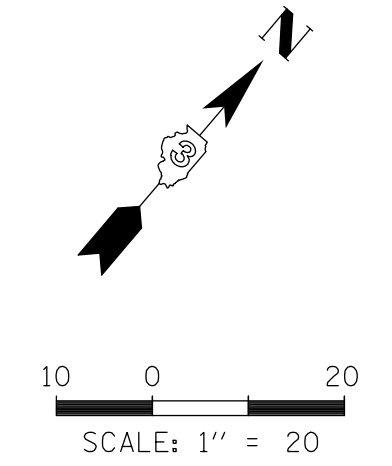

- NOTES:
1. THE EXISTING STOP SIGNS SHALL REMAIN IN PLACE UNTIL TRAFFIC SIGNAL TURN ON.
  2. BEFORE STARTING ANY EXCAVATION, THE CONTRACTOR SHALL CALL "J.U.L.I.E." AT (800) 892-0123 FOR FIELD LOCATIONS OF BURIED ELECTRIC, TELEPHONE, AND GAS. 48 HOUR NOTIFICATION IS REQUIRED.
  3. THE CONTRACTOR SHALL CHECK THE PROPOSED TRAFFIC SIGNAL EQUIPMENT LOCATIONS FOR UNDERGROUND AND OVERHEAD UTILITY CONFLICTS. THE CONTRACTOR SHALL NOTIFY THE RESIDENT ENGINEER AND ANY IMPACTED UTILITY COMPANY OF THE CONFLICT AND SHALL COORDINATE AND RESOLVE THE ISSUE PRIOR TO ORDERING MATERIALS AND PRIOR TO POURING FOUNDATIONS.
  4. RESTORATION OF THE TRAFFIC SIGNAL WORK AREA SHALL BE INCLUDED IN THE RELATED PAY ITEM SUCH AS FOUNDATION, CONDUIT, HANDHOLE, ETC., AND NO EXTRA COMPENSATION SHALL BE ALLOWED. ALL DAMAGE TO MOWED LAWNS SHALL BE REPLACED WITH AN APPROVED SOD, AND ALL DAMAGE TO UNMOWED FIELDS SHALL BE SEEDED IN ACCORDANCE WITH STANDARD SPECIFICATIONS 252 AND 250 RESPECTIVELY. IF NEEDED, EROSION CONTROL BLANKET SHALL BE INCIDENTAL ALONG WITH THE SEEDING OR SOD.
  5. THE MOUNTING LOCATIONS OF THE RADAR DETECTORS WILL BE DETERMINED PER THE MANUFACTURER'S RECOMMENDATIONS.
  6. NEW SERVICE CONNECTION TO EXISTING POLE TO BE COORDINATED WITH COMED.
  7. THE TRAFFIC SIGNAL CONTROLLER EQUIPMENT FOR THIS PROJECT SHALL BE "ECONOLITE".

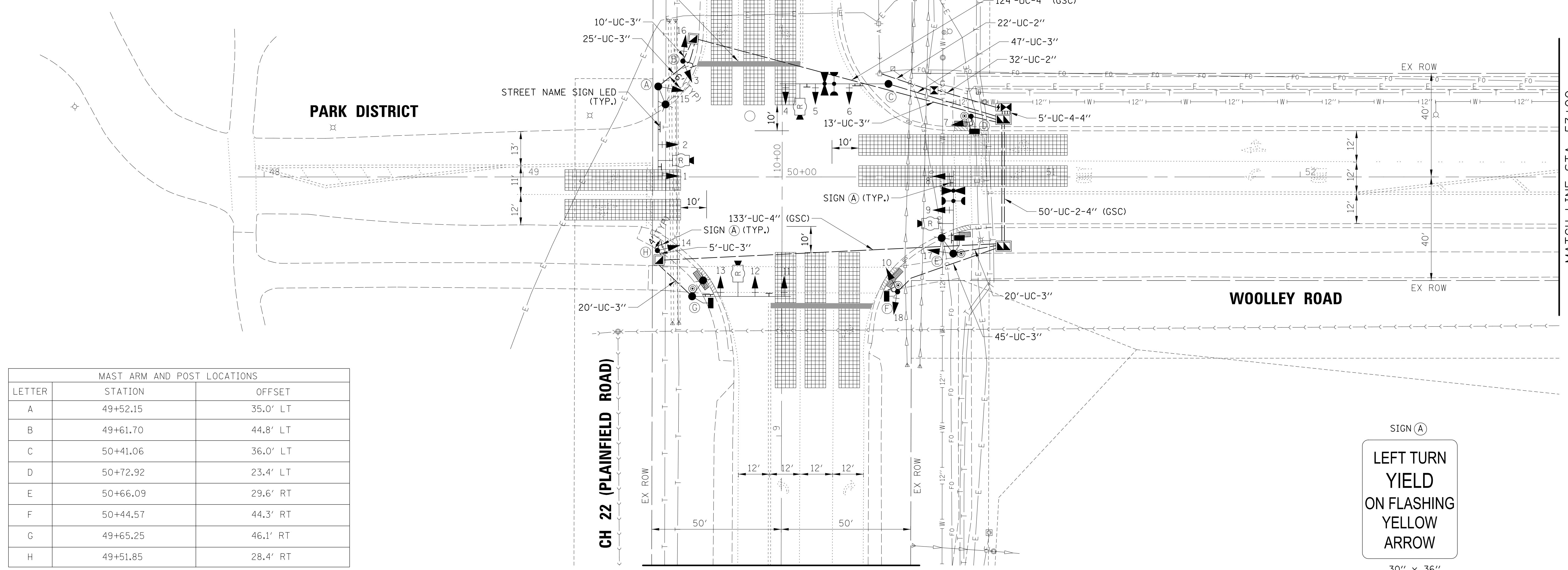

MAST ARM AND POST LOCATIONS

LETTER	STATION	OFFSET
A	49+52.15	35.0' LT
B	49+61.70	44.8' LT
C	50+41.06	36.0' LT
D	50+72.92	23.4' LT
E	50+66.09	29.6' RT
F	50+44.57	44.3' RT
G	49+65.25	46.1' RT
H	49+51.85	28.4' RT

NOTE: LOCATIONS OF TRAFFIC SIGNAL POSTS AND MAST ARM ASSEMBLIES MAY BE CHANGED IN THE FIELD AS NECESSARY TO AVOID UTILITIES. THE NEW LOCATIONS SHALL BE COORDINATED WITH THE ENGINEER AND APPROVED BY THE COUNTY TRAFFIC SIGNAL SECTION TO ENSURE THE NEW LOCATIONS MEET OPERATIONAL OFFSET/CLEAR ZONE REQUIREMENTS AND MAINTAIN PROPER POSITION OF SIGNAL HEADS IN RELATION TO THE TRAVELED LANES.

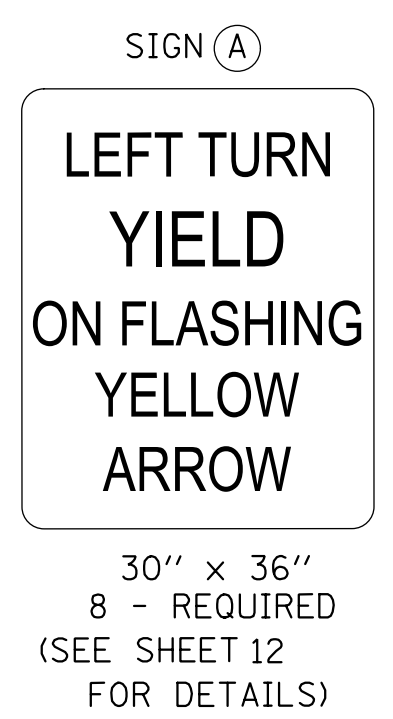



PROFILE SURVEYED \_\_\_\_\_ DATE \_\_\_\_\_  
 NOTE BOOK GRADES CHECKED \_\_\_\_\_  
 NO. \_\_\_\_\_ STRUCTURE NOTATIONS CHKD \_\_\_\_\_  
 BY \_\_\_\_\_  
 PLAN SURVEYED \_\_\_\_\_ DATE \_\_\_\_\_  
 NOTE BOOK ALIGNMENT CHECKED \_\_\_\_\_  
 NO. \_\_\_\_\_ RT. OF WAY CHECKED \_\_\_\_\_  
 DUDY FILE NAME: B:\Kendall\230085\Traffic\9 - TS-05.TSD2-230085.dgn

**CHRISTOPHER B. BURKE** ENGINEERING LTD.  
 16221 W. 158th Street, Suite 201  
 Greenwood, Illinois 60441  
 (815) 770-8858

CH 22 (PLAINFIELD ROAD)

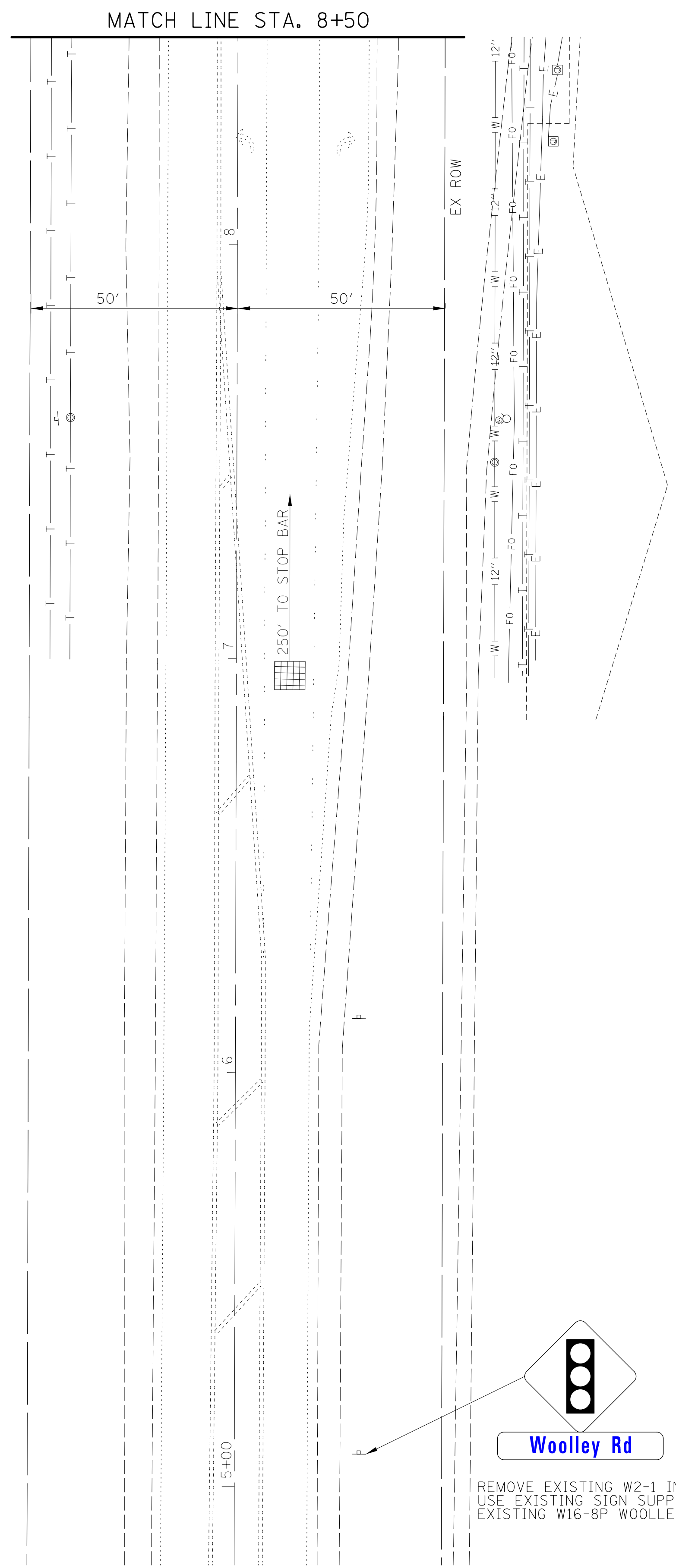

W3-3  
 TYPE AC SHEETING  
 36"x36"

EXISTING W16-8P  
 TO REMAIN IN PLACE

REMOVE EXISTING W2-1 INTERSECTION AHEAD SIGN PANEL  
 USE EXISTING SIGN SUPPORT FOR NEW W3-3 SIGN PANEL  
 EXISTING W16-8P WOOLLEY RD SIGN PANEL TO REMAIN IN PLACE

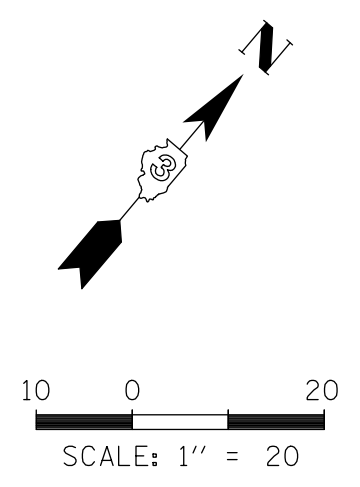

W3-3  
 TYPE AC SHEETING  
 36"x36"

EXISTING W16-8P  
 TO REMAIN IN PLACE

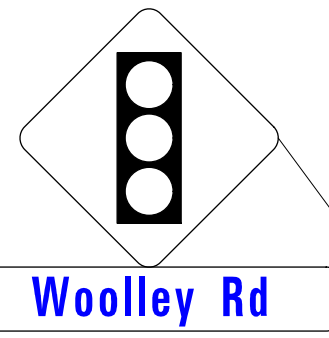

REMOVE EXISTING W2-1 INTERSECTION AHEAD SIGN PANEL  
 USE EXISTING SIGN SUPPORT FOR NEW W3-3 SIGN PANEL  
 EXISTING W16-8P WOOLLEY RD SIGN PANEL TO REMAIN IN PLACE

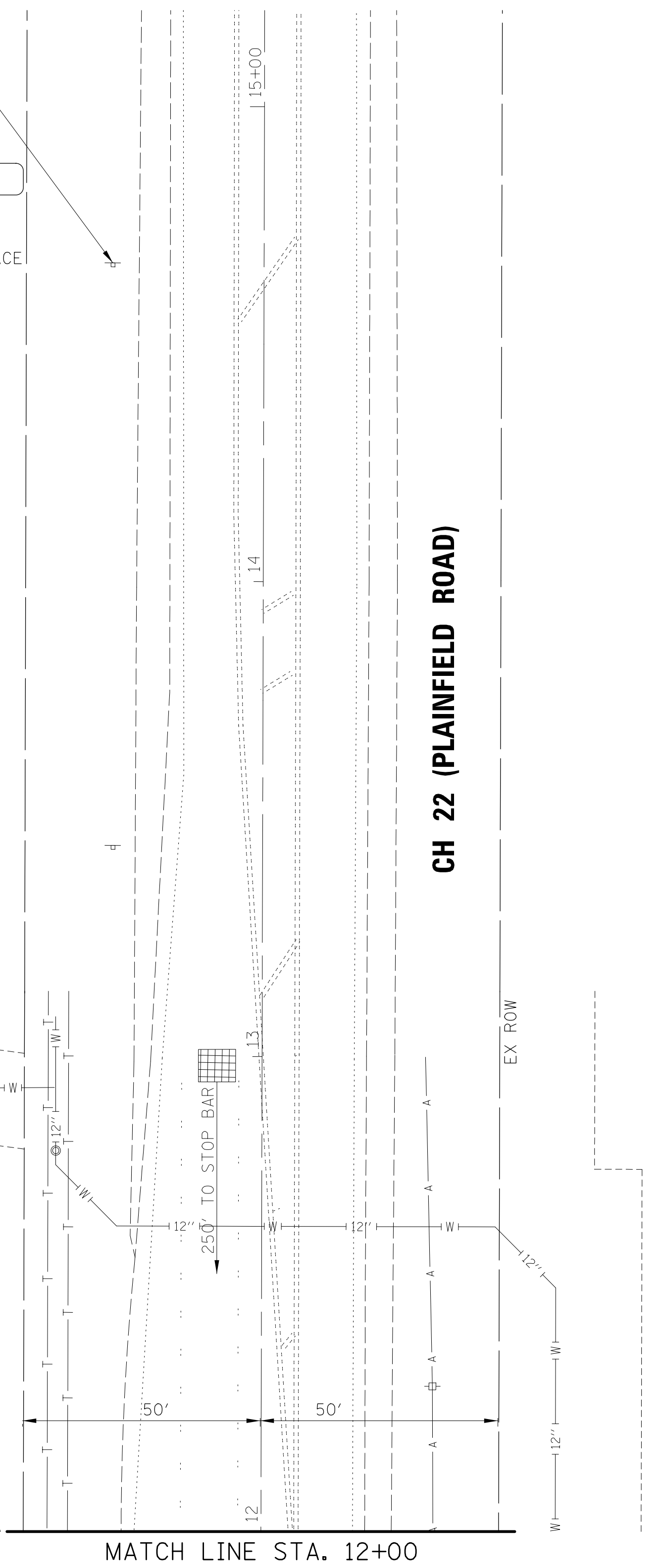

W3-3  
 TYPE AC SHEETING  
 36"x36"

EXISTING W16-8P  
 TO REMAIN IN PLACE

REMOVE EXISTING W2-1 INTERSECTION AHEAD SIGN PANEL  
 USE EXISTING SIGN SUPPORT FOR NEW W3-3 SIGN PANEL  
 EXISTING W16-8P WOOLLEY RD SIGN PANEL TO REMAIN IN PLACE

FILE NAME =	USER NAME = pandrews	DESIGNED - PA	REVISED -
N:\kendallcounty\230085\Traffic\9 - TS-05.TSD2-230085.dgn		DRAWN - FPB	REVISED -
	PLOT SCALE = 20'	CHECKED - GMZ	REVISED -
	PLOT DATE = 10/4/2023	DATE -	REVISED -

**KENDALL COUNTY**  
**HIGHWAY DEPARTMENT**

<b>CH 22 (PLAINFIELD ROAD)</b>			
<b>PROPOSED TRAFFIC SIGNAL INSTALLATION PLAN</b>			
SCALE: 1" = 20'	SHEET NO. OF SHEETS	STA. TO STA.	

F.A.P. RTE.	SECTION	COUNTY	TOTAL SHEETS	SHEET NO.
CH 22	23-00172-00-TL	KENDALL	12	9
FED. ROAD DIST. NO.		ILLINOIS FED. AID PROJECT		

CONTRACT NO.



SURVEYED \_\_\_\_\_  
 ALIGNED \_\_\_\_\_  
 CHECKED \_\_\_\_\_  
 DATE \_\_\_\_\_  
 BY \_\_\_\_\_  
 FILE NAME: N:\KendallCounty\230085\Traffic\11 - TS-07\_CAB-230085.dgn  
 PROJECT: CH 22 (PLAINFIELD ROAD) AND WOOLLEY ROAD  
 SHEET: CH 22 PHASE DIAGRAM, CABLE DIAGRAM, SCHEDULE OF QUANTITIES AND EMERGENCY VEHICLE PREEMPTION SEQUENCE  
 CONTRACT NO. \_\_\_\_\_  
 F.A.P. DIST. NO. \_\_\_\_\_  
 ILLINOIS FED. AID PROJECT \_\_\_\_\_

**PROPOSED CONTROLLER SEQUENCE**

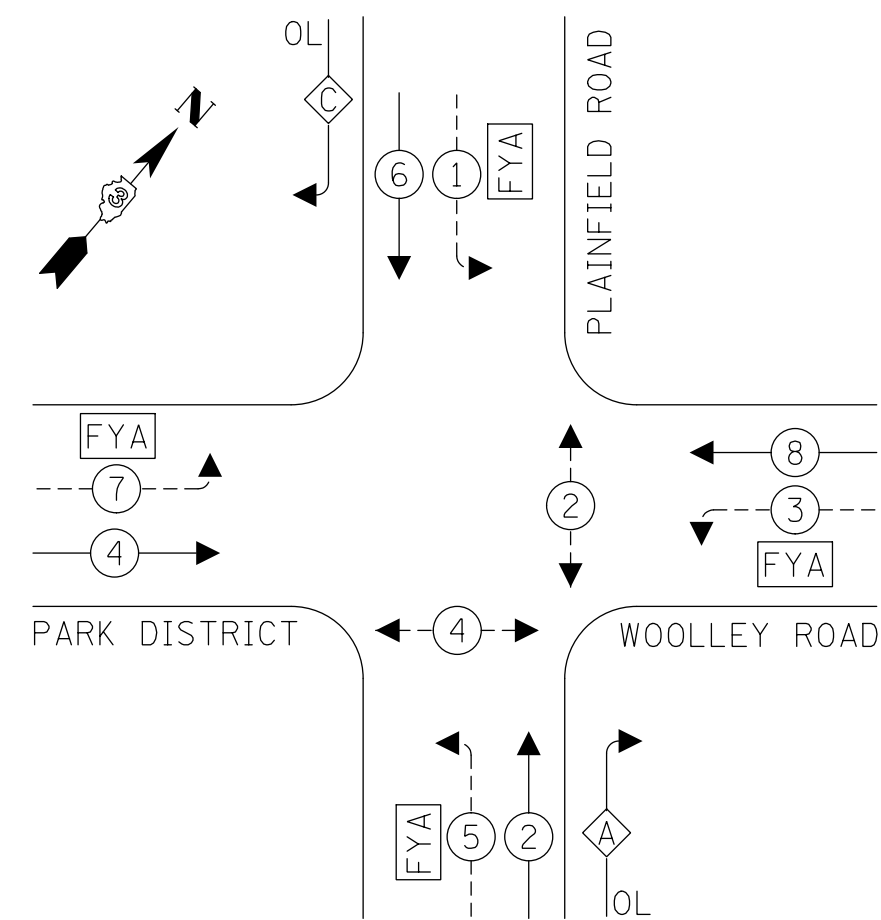

**PROPOSED EMERGENCY VEHICLE PREEMPTION SEQUENCE**

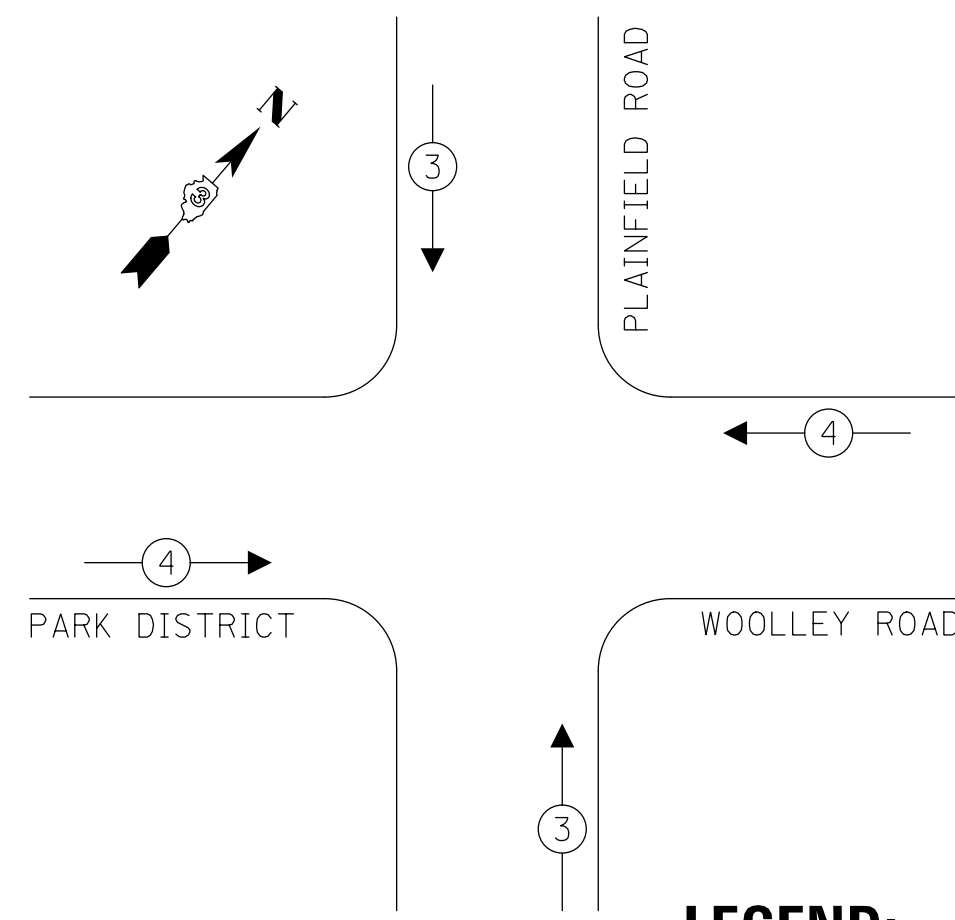

IDOT TRAFFIC SIGNAL INSTALLATION ELECTRICAL SERVICE REQUIREMENTS				
TYPE	NO. LAMPS	LED WATTAGE	% OPERATION	TOTAL WATTAGE
SIGNAL (RED)	10	11	0.50	55.00
(YELLOW)	10	20	0.05	10.00
(GREEN)	10	12	0.45	54.00
SOLID ARROW (RED)	8	11	0.50	44.00
(GREEN & YELLOW)	12	11	0.05	6.60
FLASHING YELLOW	8	12	0.45	43.20
PED. SIGNAL	4	25	1.00	100.00
CONTROLLER	1	100	1.00	100.00
UPS	1	25	1.00	25.00
STREET NAME SIGN	4	120	0.50	240.00
LUMINAIRE	3	160	0.50	240.00
RADAR DETECTION	4	25	1.00	100.00
FLASHER			0.50	
TOTAL =				1017.80

**RIGHT TURN OVERLAP PHASE DESIGNATION:**

OVERLAP LETTER	PERMISSIVE PHASE	PROTECTED PHASE
A	= 2	+ 3
C	= 6	+ 7

- LEGEND:**
- ← \* → PROTECTED PHASE
  - ← \* - - \* → PROTECTED/PERMITTED PHASE
  - ← \* → PEDESTRIAN PHASE
  - ← OL → OVERLAP

**SCHEDULE OF QUANTITIES**

ITEM	UNIT	QUANTITY
SIGN PANEL - TYPE 1	SQ FT	87
MODIFIED URETHANE PAVEMENT MARKING - LINE 24"	FOOT	80
SERVICE INSTALLATION - GROUND MOUNTED	EACH	1
UNDERGROUND CONDUIT, GALVANIZED STEEL, 4" DIA.	FOOT	357
UNDERGROUND CONDUIT, PVC, 2" DIA.	FOOT	32
UNDERGROUND CONDUIT, PVC, 3" DIA.	FOOT	185
UNDERGROUND CONDUIT, PVC, 4" DIA.	FOOT	20
HANDHOLE, PORTLAND CEMENT CONCRETE	EACH	2
DOUBLE HANDHOLE, PORTLAND CEMENT CONCRETE	EACH	2
ELECTRIC CABLE IN CONDUIT, 600V (XLP-TYPE USE) 1/C NO. 10	FOOT	2171
ELECTRIC CABLE IN CONDUIT, SIGNAL NO. 14 2C	FOOT	561
ELECTRIC CABLE IN CONDUIT, SIGNAL NO. 14 3C	FOOT	860
ELECTRIC CABLE IN CONDUIT, SIGNAL NO. 14 5C	FOOT	1120
ELECTRIC CABLE IN CONDUIT, SIGNAL NO. 14 7C	FOOT	2191
ELECTRIC CABLE IN CONDUIT, SERVICE, NO. 6 2C	FOOT	98
ELECTRIC CABLE IN CONDUIT, EQUIPMENT GROUNDING CONDUCTOR, NO. 6 1C	FOOT	791
TRAFFIC SIGNAL POST, GALVANIZED STEEL 16 FT.	EACH	4
STEEL MAST ARM ASSEMBLY AND POLE, 42 FT.	EACH	1
STEEL COMBINATION MAST ARM ASSEMBLY AND POLE 32 FT.	EACH	1
STEEL COMBINATION MAST ARM ASSEMBLY AND POLE 36 FT.	EACH	1
STEEL COMBINATION MAST ARM ASSEMBLY AND POLE 38 FT.	EACH	1
CONCRETE FOUNDATION, TYPE A	FOOT	20
CONCRETE FOUNDATION, TYPE D	FOOT	4
CONCRETE FOUNDATION, TYPE E 36-INCH DIAMETER	FOOT	46
SIGNAL HEAD, POLYCARBONATE, LED, 1-FACE, 3-SECTION, BRACKET MOUNTED	EACH	2
SIGNAL HEAD, POLYCARBONATE, LED, 1-FACE, 3-SECTION, MAST ARM MOUNTED	EACH	4
SIGNAL HEAD, POLYCARBONATE, LED, 1-FACE, 4-SECTION, BRACKET MOUNTED	EACH	4
SIGNAL HEAD, POLYCARBONATE, LED, 1-FACE, 4-SECTION, MAST ARM MOUNTED	EACH	4
SIGNAL HEAD, POLYCARBONATE, LED, 1-FACE, 5-SECTION, BRACKET MOUNTED	EACH	2
SIGNAL HEAD, POLYCARBONATE, LED, 1-FACE, 5-SECTION, MAST ARM MOUNTED	EACH	2
PEDESTRIAN SIGNAL HEAD, POLYCARBONATE, LED, 1-FACE, BRACKET MOUNTED WITH COUNT DOWN TIMER	EACH	4
TRAFFIC SIGNAL BACKPLATE, RETROREFLECTIVE	EACH	18
LIGHT DETECTOR	EACH	2
LIGHT DETECTOR AMPLIFIER	EACH	1
PEDESTRIAN PUSH-BUTTON	EACH	4
EMERGENCY VEHICLE PRIORITY SYSTEM LINE SENSOR CABLE, NO. 20 3/C	FOOT	271
RADAR VEHICLE DETECTION SYSTEM	EACH	1
SIGNAL TIMING	L SUM	1
LED INTERNALLY ILLUMINATED STREET NAME SIGN	EACH	4
LUMINAIRE, LED, SPECIAL	EACH	3
FULL-ACTUATED CONTROLLER AND TYPE IV CABINET, SPECIAL	EACH	1
UNINTERRUPTABLE POWER SUPPLY AND CABINET, SPECIAL	EACH	1
ELECTRIC CABLE IN CONDUIT, STREET NAME SIGN, NO. 14 3C, TYPE SOOW	FOOT	730
LED SIGNAL FACE, LENS COVER	EACH	10
LUMINAIRE SAFETY CABLE ASSEMBLY	EACH	3

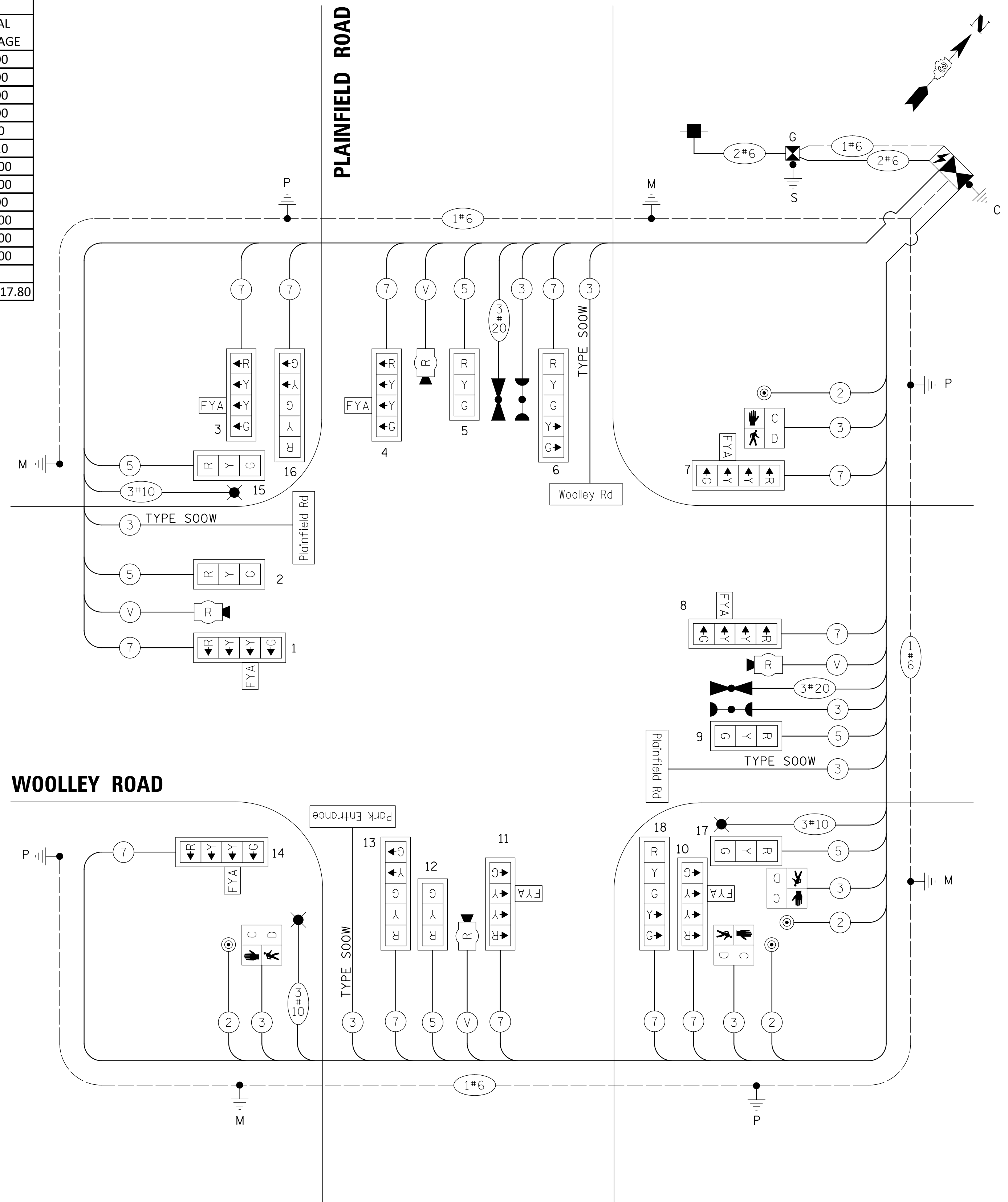

**CABLE PLAN**  
(NOT TO SCALE)

FILE NAME = N:\kendallcounty\230085\Traffic\11 - TS-07_CAB-230085.dgn	USER NAME = pandrews	DESIGNED - PA	REVISED -
		DRAWN - FPB	REVISED -
		CHECKED - GMZ	REVISED -
		DATE -	REVISED -

**KENDALL COUNTY  
HIGHWAY DEPARTMENT**

**CH 22 (PLAINFIELD ROAD) AND WOOLLEY ROAD  
PHASE DIAGRAM, CABLE DIAGRAM, SCHEDULE OF QUANTITIES  
AND EMERGENCY VEHICLE PREEMPTION SEQUENCE**

SCALE: 1" = N.T.S. SHEET NO. OF SHEETS STA. TO STA.

F.A.P. RTE. CH 22	SECTION 23-00172-00-TL	COUNTY KENDALL	TOTAL SHEETS 12	SHEET NO. 11
FED. ROAD DIST. NO.		ILLINOIS FED. AID PROJECT		



FILE NAME = N:\kendallcounty\230085\Traffic\12 - TS-23\_Mast Arm Detail-230085.dgn  
 USER NAME = pandrows  
 DESIGNED - PA  
 DRAWN - FPB  
 CHECKED - GMZ  
 DATE - 10/4/2023  
 SURVEYED  
 GRADES CHECKED  
 ELEM. NOTED  
 STRUCTURE NOTATIONS OK'KO  
 NOTE BOOK NO.  
 PLAN NOTE BOOK NO.  
 SURVEYED  
 ALIGNMENT CHECKED  
 R.T. OF WAY CHECKED  
 CADD FILE NAME: B:\Kendall\230085\Traffic\12 - TS-23\_Mast Arm Detail-230085.dgn  
 BY: DATE:

PROFILE  
 SURVEYED  
 GRADES CHECKED  
 ELEM. NOTED  
 STRUCTURE NOTATIONS OK'KO  
 NOTE BOOK NO.  
 PLAN NOTE BOOK NO.  
 SURVEYED  
 ALIGNMENT CHECKED  
 R.T. OF WAY CHECKED  
 CADD FILE NAME: B:\Kendall\230085\Traffic\12 - TS-23\_Mast Arm Detail-230085.dgn  
 BY: DATE:

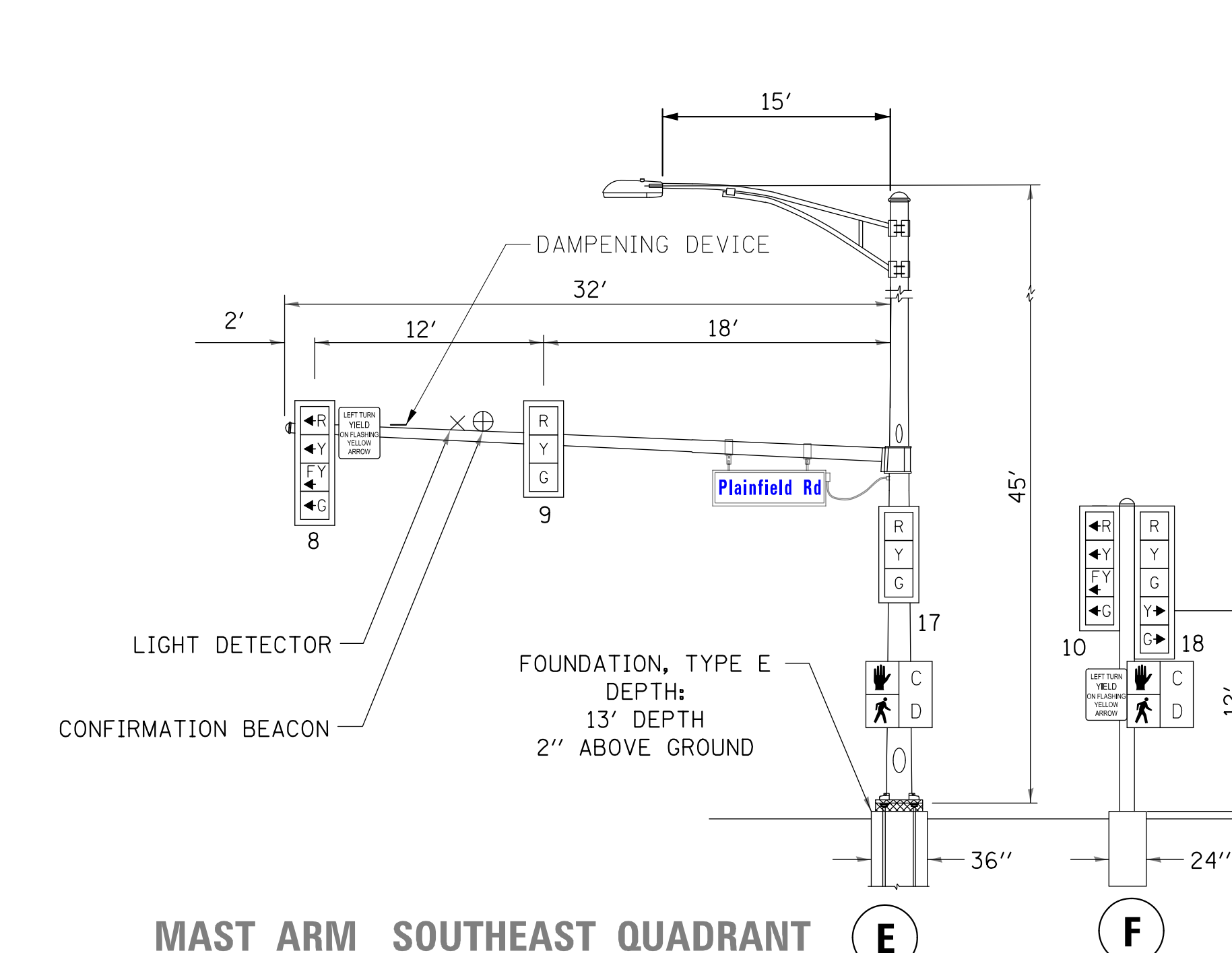
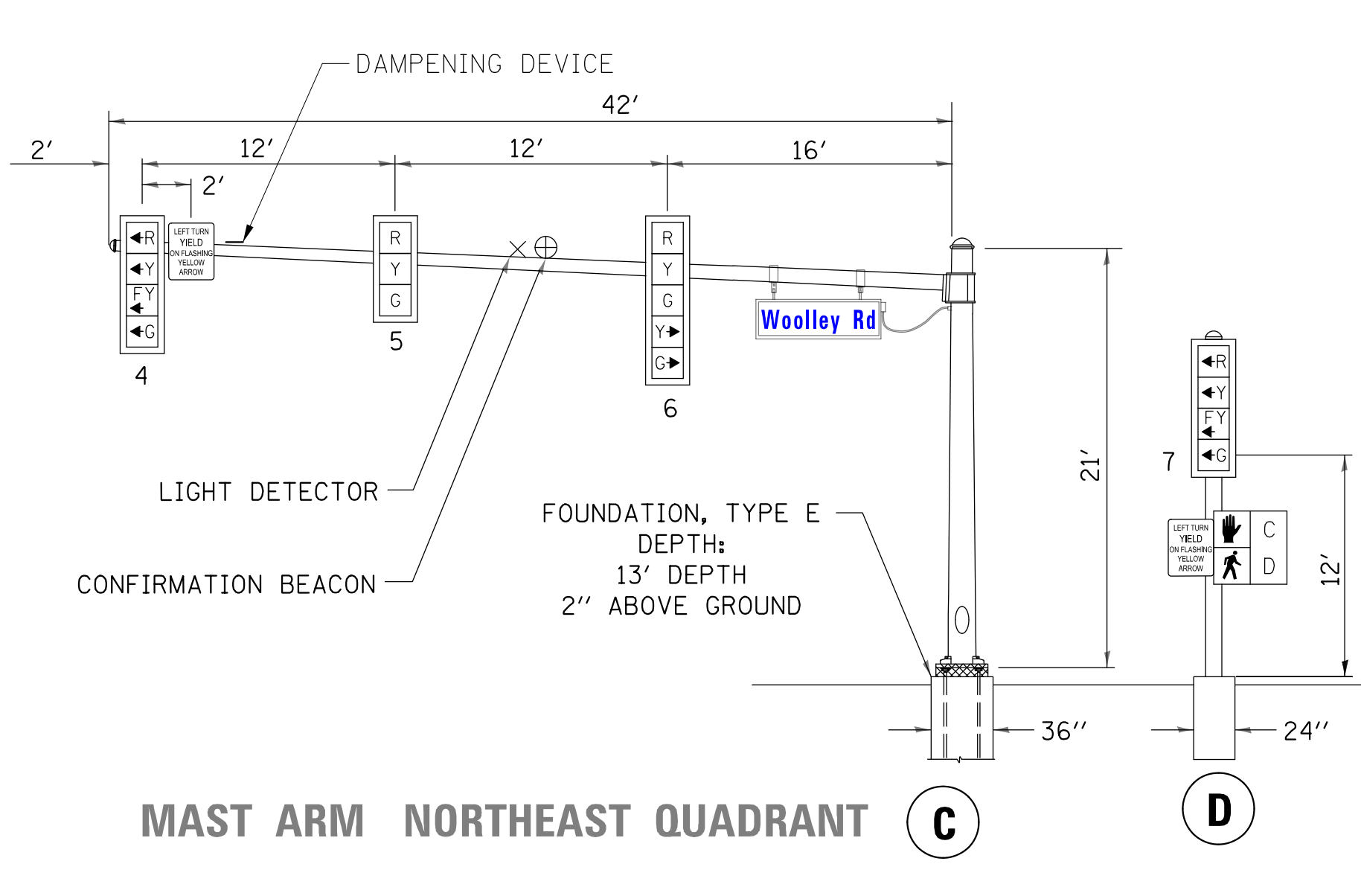
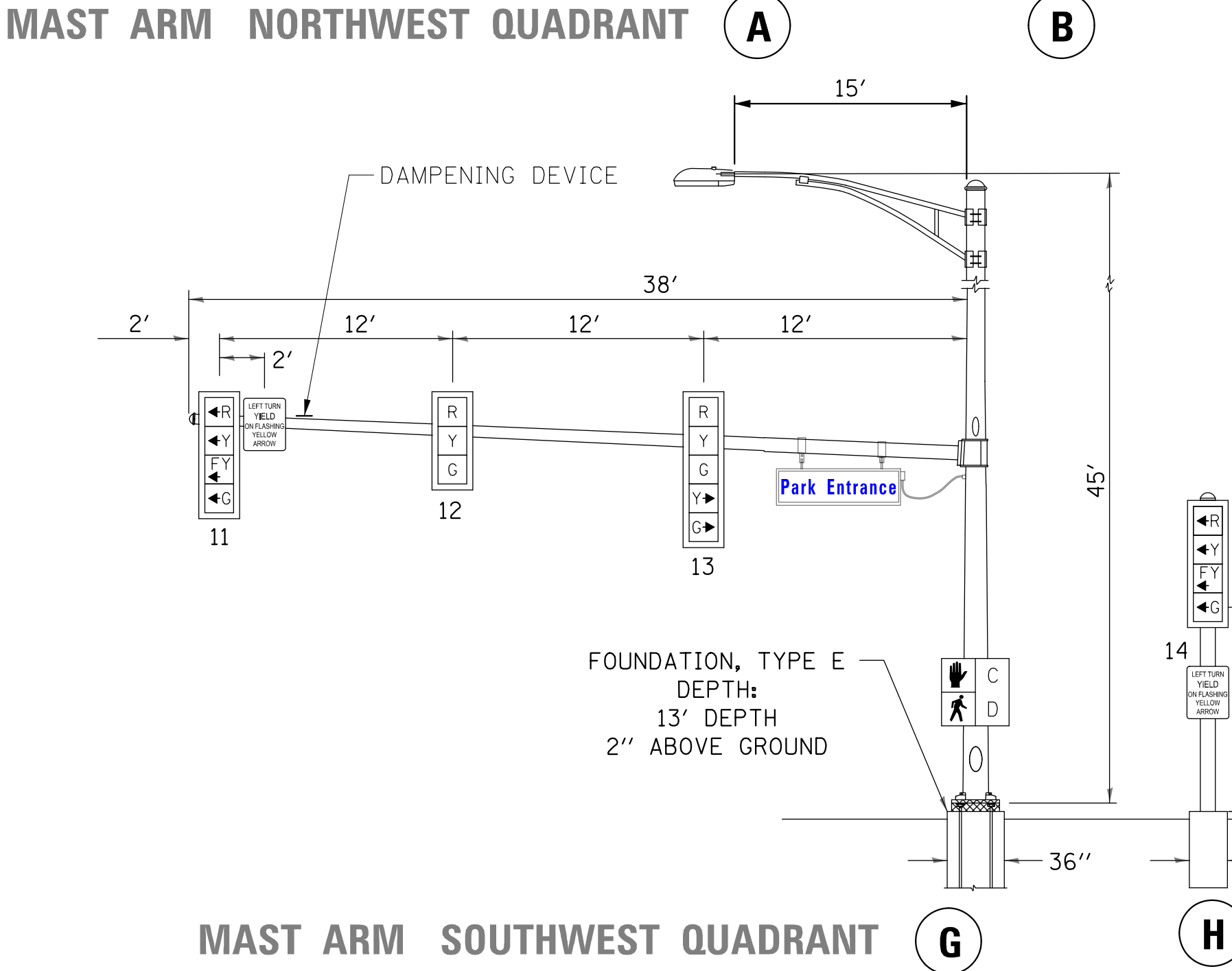
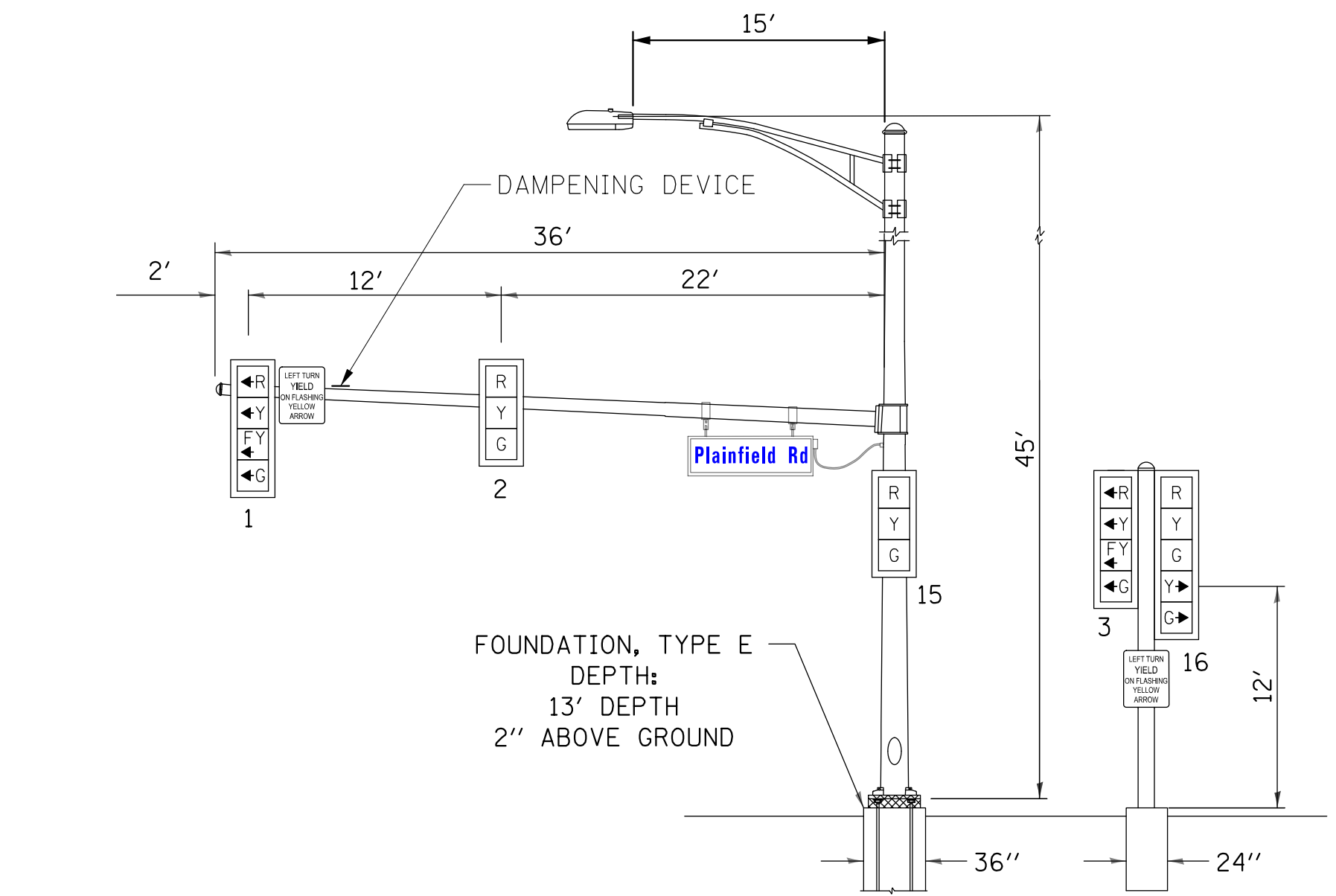

**LED ILLUMINATED STREET NAME SIGNS**

ALL DIMENSIONS ARE IN INCHES UNLESS NOTED OTHERWISE

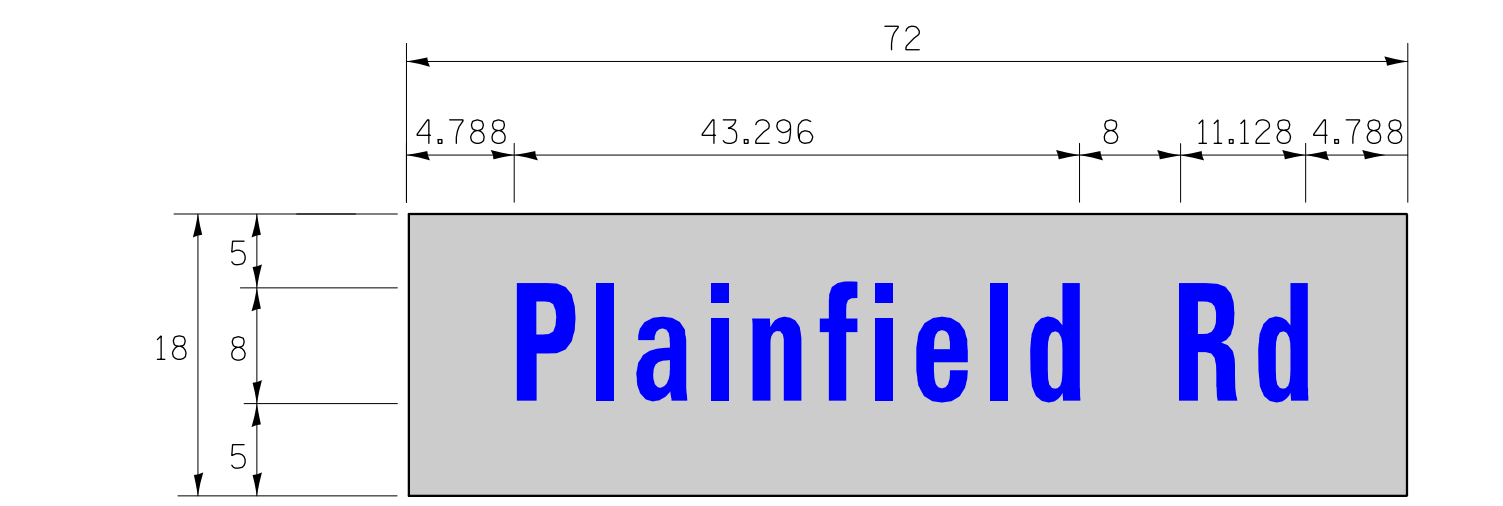

DESIGN SERIES	AREA (SQ FT)	SHEETING TYPE	QTY. REQUIRED
D	9.0	ZZ	2

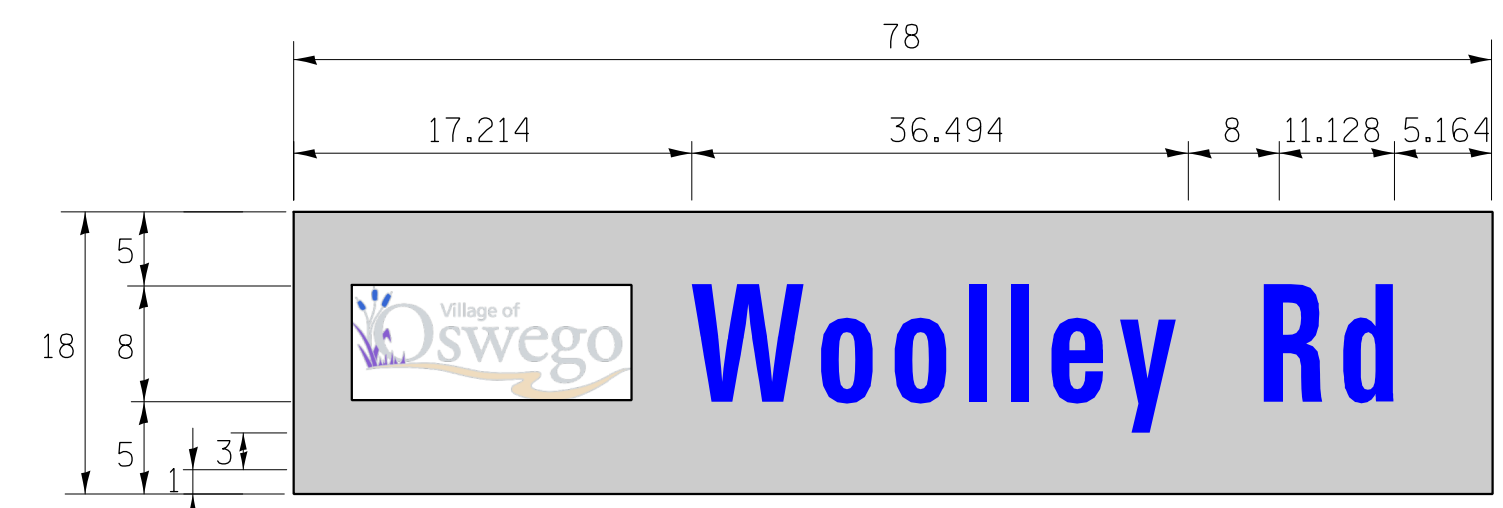

DESIGN SERIES	AREA (SQ FT)	SHEETING TYPE	QTY. REQUIRED
D	9.75	ZZ	1

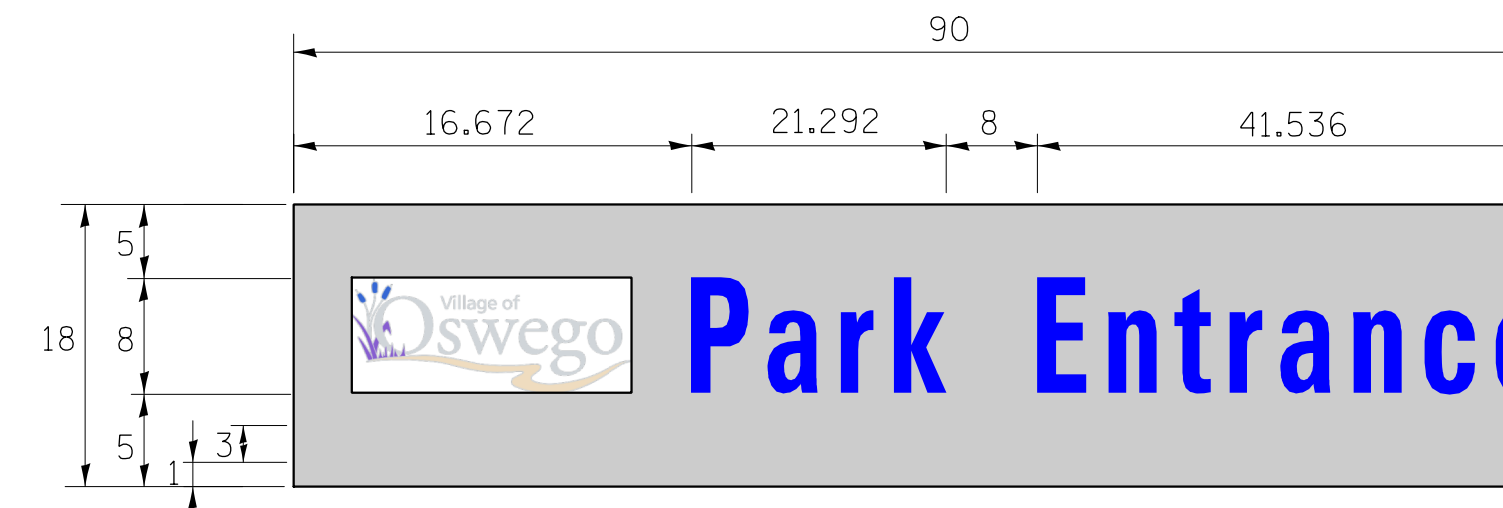

DESIGN SERIES	AREA (SQ FT)	SHEETING TYPE	QTY. REQUIRED
D	12.0	ZZ	1

NOTE:  
 DAMPENING DEVICE SHALL CONSIST OF A 24" X 30" TYPE 1, UNPAINTED ALUMINUM SIGN STOCK MOUNTED HORIZONTALLY ON TOP OF MAST ARM WITH THE 30" LENGTH PERPENDICULAR TO THE ARM. COST OF THE DAMPENING DEVICE IS INCLUDED IN THE MAST ARM PAY ITEM.

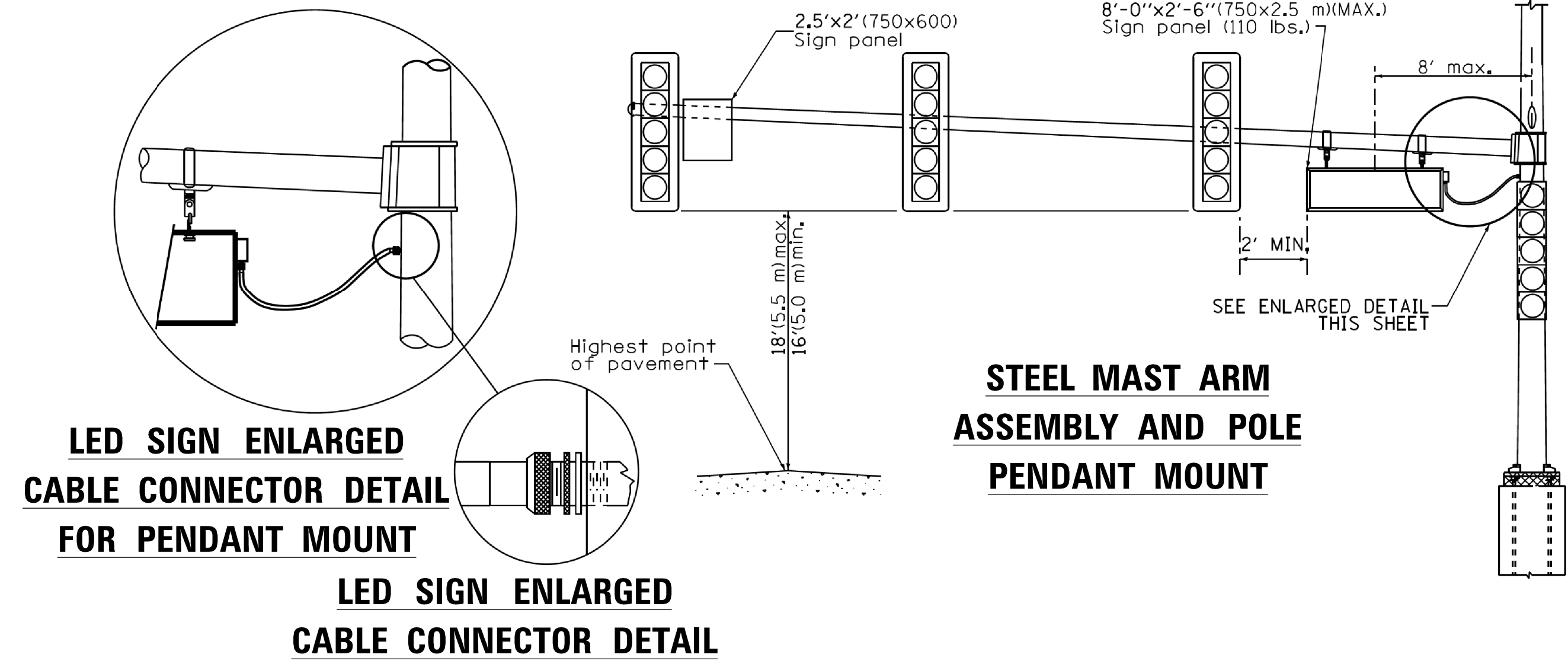
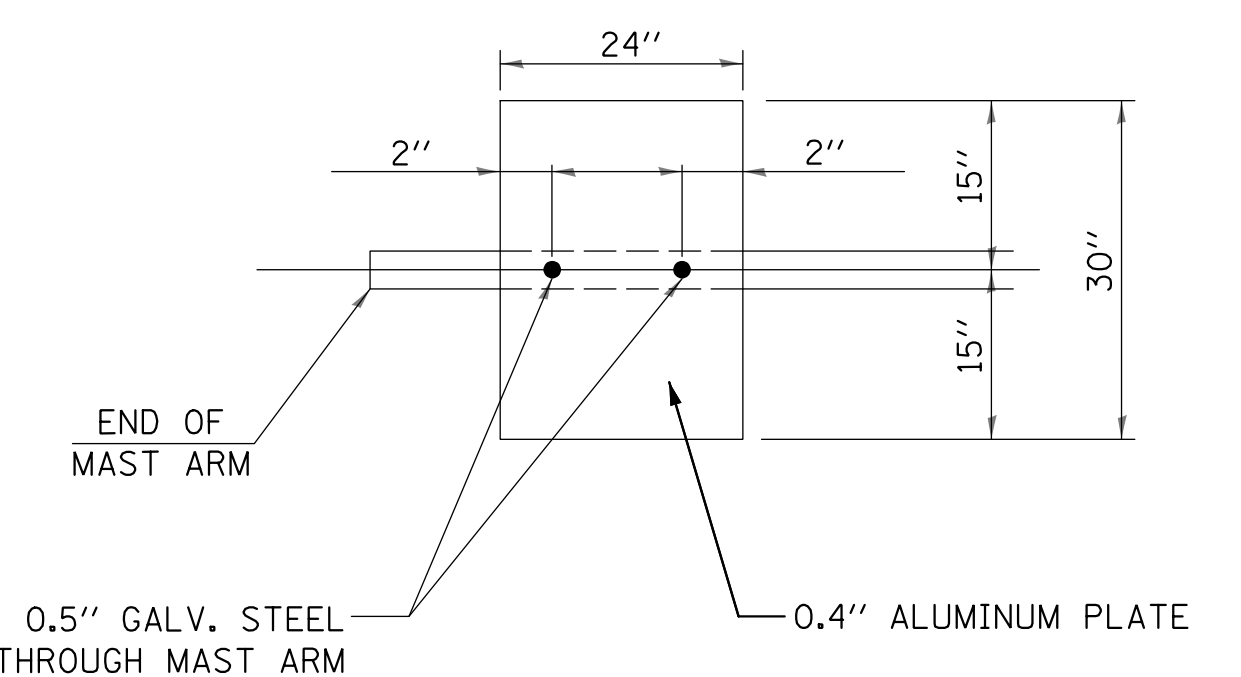

**FLASHING YELLOW ARROW SIGN DETAIL**

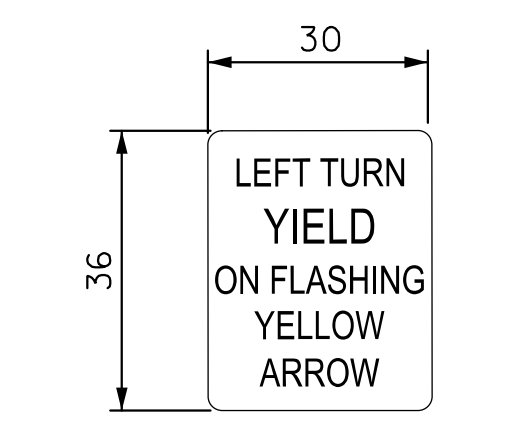

7.50 SQ. FT. EACH  
 8 REQUIRED  
 TYPE AP SHEETING REQUIRED

FILE NAME = N:\kendallcounty\230085\Traffic\12 - TS-23_Mast Arm Detail-230085.dgn	USER NAME = pandrows	DESIGNED - PA	REVISED -
PLOT SCALE = 20'	DRAWN - FPB	CHECKED - GMZ	REVISED -
PLOT DATE = 10/4/2023	DATE -		REVISED -

**KENDALL COUNTY HIGHWAY DEPARTMENT**

**CH 22 (PLAINFIELD ROAD) AND WOOLLEY ROAD MAST ARM LOADING DIAGRAM AND SIGN DETAILS**

SCALE: 1" = N.T.S. SHEET NO. OF SHEETS STA. TO STA.

F.A.P. RTE.	SECTION	COUNTY	TOTAL SHEETS	SHEET NO.
CH 22	23-00172-00-TL	KENDALL	12	12

CONTRACT NO. FED. ROAD DIST. NO. ILLINOIS FED. AID PROJECT