

Kendall County Forest Preserve
Income Statement
For Period Ended 1/31/18

2 Month Budget Percent = 16.7%

FOREST PRESERVES & PROGRAMS

	Current Year FY18		Prior Year FY17		YTD Variance	
	Budget	YTD	Budget	YTD	\$ Change	% Change
Beginning Balance	\$ 309,838	\$ 309,838	\$ 317,672	\$ 317,672		
Revenue						
Revenue - Administration	739,247	20,505	719,815	522	19,983	3828%
Revenue - Ellis House & Equestrian Center	118,247	17,878	138,005	8,929	8,949	100%
Revenue - Hoover FP	64,275	15,686	60,025	6,816	8,870	130%
Revenue - Env. Education	154,146	27,060	165,038	9,545	17,515	183%
Revenue - Natural Area Volunteers	2,000	-	2,000	2,425	-2,425	-100%
Revenue - Grounds & Natural Resources	20,200	935	7,200	280	655	234%
Total Revenue	1,098,115	82,065	1,092,083	28,517	53,548	188%
Expenditure						
Expenditure - Administration	310,345	33,647	289,117	36,706	-3,059	-8%
Expenditure - Ellis House & Equestrian Center	157,310	18,036	183,716	33,089	-15,053	-45%
Expenditure - Hoover FP	170,628	23,751	165,465	25,556	-1,805	-7%
Expenditure - Env. Education	142,478	22,392	148,213	25,607	-3,215	-13%
Expenditure - Natural Area Volunteers	500	-	500	-	311	1%
Expenditure - Grounds & Natural Resources	306,353	48,209	293,706	47,898	311	1%
Total Expenditure	1,087,614	146,035	1,080,717	168,856	-22,821	-14%
ENDING BAL	\$320,339	\$245,868	\$329,038	\$177,333	\$68,535	38.6%
Surplus/(Deficit)	\$ 10,501	-\$63,970	\$11,366	-\$140,339		

Kendall County Forest Preserve
Income Statement
For Period Ended 1/31/18

2 Month Budget Percent = 16.7%

FOREST PRESERVE CATEGORIES

	Current Year FY18		Prior Year FY17		YTD Variance	
	Budget	YTD	Budget	YTD	\$ Change	% Change
Beginning Balance						
Revenue						
Property Tax	576,247	-	552,815	18	13	73%
Interest Income	170	31	170	18	-70	-48%
Other Income	14,000	77	2,000	147	2,425	34.6%
Donations	10,000	365	7,000	6,344	5,192	82%
Rental Revenue	59,975	11,536	59,725	6,344	23,709	130%
Program Revenue	253,793	41,933	282,943	18,224	19,695	13968%
Grants	3,500	-	1,000	141	6,723	671%
Farm License Revenue	151,030	19,836	161,030	1,002	345	160%
Security Deposits	26,100	7,725	22,100	216	53,548	188%
Credit Card Revenue	3,300	561	3,300	216		
Total Revenue	1,098,115	82,065	1,092,083	28,517		
Expenditure						
Personnel	615,212	91,286	586,064	101,911	-10,625	-10%
Employee Benefits	237,097	30,212	227,277	26,978	3,234	12%
Contractual	56,395	3,101	63,690	19,948	-16,847	-84%
Commodities	124,110	16,560	139,310	14,720	1,840	13%
Other	54,800	4,875	64,373	5,299	-424	-8%
Total Expenditure	1,087,614	146,035	1,080,714	168,856	-22,821	-14%
ENDING BAL	\$320,339	\$ 245,868	\$329,041	\$ 177,333	\$68,535	38.6%
Surplus/(Deficit)	\$ 10,501	-\$63,970	\$11,369	-\$140,339		

Kendall County Forest Preserve
Income Statement
For Period Ended 1/31/18

2 Month Budget Percent = 16.7%

ADMINISTRATION

	Current Year FY18		Prior Year FY17		YTD Variance	
	Budget	YTD	Budget	YTD	\$ Change	% Change
Revenue						
Property Tax	576,247	-	552,815	18	13	73%
Interest Income	170	31	170	18	-70	-48%
Other Income	8,000	77	2,000	147		
Donations	500	-	500			
Farm License Revenue	151,030	19,836	161,030	141	19,695	13968%
Security Deposit Revenue						
Credit Card Revenue	3,300	561	3,300	216	345	160%
Program Revenue						
Total Revenue	739,247	20,505	719,815	522	19,983	3828%
Expenditure						
Personnel	143,428	21,537	134,330	24,718	-3,181	-13%
Employee Benefits	117,017	8,227	100,784	7,548	679	9%
Contractual	17,800	415	20,450	1,480	-1,065	-72%
Commodities	20,900	3,467	21,100	2,961	506	17%
Other	11,200	-	12,453	-		
Total Expenditure	310,345	33,647	289,117	36,707	-3,060	-8%
Surplus/(Deficit)	\$ 428,902	-\$13,141	\$430,698	-\$36,185		

Kendall County Forest Preserve
Income Statement
For Period Ended 1/31/18

2 Month Budget Percent = 16.7%

HOOVER FOREST PRESERVE

	Current Year FY18		Prior Year FY17		YTD Variance	
	Budget	YTD	Budget	YTD	\$ Change	% Change
Revenue						
Donations	-	-				
Rental Revenue	53,775	10,961	53,525	6,064	4,897	81%
Security Deposit Rev	10,500	4,725	6,500	752	3,973	528%
Program Revenue	-	-				
Total Revenue	64,275	15,686	60,025	6,816	8,870	130%
Expenditure						
Personnel	88,400	13,058	84,916	13,950	-892	-6%
Employee Benefits	26,829	4,440	26,119	4,106	334	8%
Contractual	-	-				
Commodities	48,900	5,170	47,900	6,643	-1,473	-22%
Other	6,500	1,083	6,500	858	225	26%
Total Expenditure	170,629	23,751	165,435	25,557	-1,806	-7%
Surplus/(Deficit)	-\$106,354	-\$8,065	-\$105,410	-\$18,741		

Kendall County Forest Preserve
Income Statement
For Period Ended 1/31/18

2 Month Budget Percent = 16.7%

ENVIRONMENTAL EDUCATION

Revenue
 Donations
 Security Deposit
 Credit Card Revenue
 Program Revenue
Total Revenue
Expenditure
 Personnel
 Employee Benefits
 Contractual
 Commodities
 Other
Total Expenditure
Surplus/(Deficit)

	Current Year FY18		
	Budget	YTD	%
	2,500	5	0.2%
	-	27,055	17.8%
	151,646	27,060	17.6%
	117,788	18,574	15.8%
	17,090	3,043	17.8%
	-	775	10.2%
	142,478	22,392	15.7%
	\$11,668	\$4,668	

	Prior Year FY17		
	Budget	YTD	%
	2,500		
	162,538	9,545	5.9%
	165,038	9,545	5.8%
	120,543	21,714	18.0%
	18,270	3,169	17.3%
	9,400	724	7.7%
	148,213	25,607	17.3%
	\$16,825	-\$16,062	

	YTD Variance	
	\$ Change	% Change
	5	
	17,510	183%
	17,515	183%
	-3,140	-14%
	-126	-4%
	51	7%
	-3,215	-13%

Kendall County Forest Preserve
Income Statement
For Period Ended 1/31/18

2 Month Budget Percent = 16.7%

NATURAL AREA VOLUNTEERS

Revenue
 Donations
 Security Deposit
 Credit Card Revenue
 Program Revenue
Total Revenue

Expenditure
 Personnel
 Employee Benefits
 Contractual
 Commodities
 Other
Total Expenditure

Surplus/(Deficit)

	Current Year FY18		Prior Year FY17		YTD Variance	
	Budget	YTD	YTD	%	\$ Change	% Change
100.0%	2,000	-	2,425		(2,425)	-100%
100.0%	2,000	-	2,425	121.3%	(2,425)	-100%
100.0%	-	-	-		-	
100.0%	-	-	-		-	
100.0%	500	-	500		-	
100.0%	500	-	500		-	
	\$ 1,500	\$ -	\$ 2,425			

Kendall County Forest Preserve
Income Statement
For Period Ended 1/31/18

2 Month Budget Percent = 16.7%

ELLIS GROUNDS - 101

	Current Year FY18		Prior Year FY17		YTD Variance	
	Budget	YTD	Budget	YTD	\$ Change	% Change
Revenue						
Donations	-	-	-	-	-	
Security Deposit	-	-	-	-	-	
Credit Card Revenue	-	-	-	-	-	
Program Revenue	16,066	1,193	15,925	1,206	(13)	-1%
Total Revenue	24,182	1,396	20,905	1,611	(183)	-100%
					(215)	-13%
Expenditure						
Personnel						
Employee Benefits						
Contractual						
Commodities						
Other						
Total Expenditure	24,182	1,396	20,905	1,611	(183)	-100%
Surplus/(Deficit)	-\$24,182	-\$1,396	-\$20,905	-\$1,611		

ELLIS CAMPS - 110

	Current Year FY18		Prior Year FY17		YTD Variance	
	Budget	YTD	Budget	YTD	\$ Change	% Change
Revenue						
Donations	-	-	-	-	-	
Security Deposit	-	-	-	-	-	
Credit Card Revenue	-	-	-	-	-	
Program Revenue	9,897	-	13,000	-	65	8
Total Revenue	9,897	-	13,000	-	65	8
Expenditure						
Personnel						
Employee Benefits						
Contractual						
Commodities						
Other						
Total Expenditure	8,515	372	12,454	(79)	379	-479%
Surplus/(Deficit)	\$1,382	-\$372	\$546	\$79	451	-571%

Kendall County Forest Preserve
Income Statement
For Period Ended 1/31/18

2 Month Budget Percent = 16.7%

ELLIS RIDING LESSONS - 111

	Current Year FY18		Prior Year FY17		YTD Variance	
	Budget	YTD	Budget	YTD	\$ Change	% Change
Revenue						
Donations	500	-	2,000			
Security Deposit	-	-				
Credit Card Revenue	-	-				
Program Revenue	25,130	5,708	24,905	2,530	3,178	126%
Total Revenue	25,630	5,708	26,905	2,530	3,178	126%
Expenditure						
Personnel	18,580	2,151	16,000	5,545	-3,394	-61%
Employee Benefits	1,982	307	2,327	809	-502	-62%
Contractual	2,400	95	2,750	175	-80	-46%
Commodities	1,190	468	1,815	388	80	21%
Other	-	-				
Total Expenditure	24,152	3,022	22,892	6,917	-3,895	-56%
Surplus/(Deficit)	\$1,478	\$2,686	\$4,013	-\$4,387		

ELLIS BIRTHDAY PARTIES - 112

	Current Year FY18		Prior Year FY17		YTD Variance	
	Budget	YTD	Budget	YTD	\$ Change	% Change
Revenue						
Donations	-	-				
Security Deposit	-	-				
Credit Card Revenue	-	-				
Program Revenue	9,500	1,762	9,500		1,762	
Total Revenue	9,500	1,762	9,500		1,762	
Expenditure						
Personnel	3,816	682	6,456	187	495	265%
Employee Benefits	407	89	1,164	35	54	154%
Contractual	1,000	95	1,375		95	
Commodities	1,980	217	3,405	-81	298	-368%
Other	-	-				
Total Expenditure	7,203	1,083	12,400	141	942	668%
Surplus/(Deficit)	\$2,297	\$679	-\$2,900	-\$141		

Kendall County Forest Preserve
Income Statement
For Period Ended 1/31/18

2 Month Budget Percent = 16.7%

ELLIS PUBLIC PROGRAMS - 113

	Current Year FY18		Prior Year FY17		YTD Variance	
	Budget	YTD	Budget	YTD	\$ Change	% Change
Revenue						
Donations	-	-	-	-	-	
Security Deposit	-	-	-	-	-	
Credit Card Revenue	-	-	-	-	-	
Program Revenue	2,520	420	2,100	300	120	40%
Total Revenue	2,520	420	2,100	300	120	40%
Expenditure						
Personnel	1,190	338	1,890	106	232	219%
Employee Benefits	127	26	14	14	12	88%
Contractual	-	-	-	-	-	
Commodities	-	-	-	-	-	
Other	-	-	-	-	-	
Total Expenditure	1,317	365	1,890	120	245	204%
Surplus/(Deficit)	\$1,203	\$55	\$210	\$180		

ELLIS SUNRISE CENTER - 114

	Current Year FY18		Prior Year FY17		YTD Variance	
	Budget	YTD	Budget	YTD	\$ Change	% Change
Revenue						
Donations	-	-	-	-	-	
Security Deposit	-	-	-	-	-	
Credit Card Revenue	-	-	-	-	-	
Program Revenue	24,600	3,893	19,200	1,600	2,293	143%
Total Revenue	24,600	3,893	19,200	1,600	2,293	143%
Expenditure						
Personnel	14,456	2,306	6,864	375	1,931	515%
Employee Benefits	1,541	314	1,284	55	259	471%
Contractual	-	-	-	-	-	
Commodities	3,400	589	4,800	430	589	
Other	-	-	-	-	-	
Total Expenditure	19,397	3,209	12,948	430	2,779	646%
Surplus/(Deficit)	\$5,203	\$684	\$6,252	\$1,170		

Kendall County Forest Preserve
Income Statement
For Period Ended 1/31/18

2 Month Budget Percent = 16.7%

ELLIS WEDDINGS - 120

	Current Year FY18		Prior Year FY17		YTD Variance	
	Budget	YTD	Budget	YTD	\$ Change	% Change
Revenue						
Donations	-	-	15,000		3,000	
Security Deposit	15,000	3,000				
Credit Card Revenue	-	-	43,200	3,650	-850	-23%
Program Revenue	22,000	2,800	58,200	3,650	2,150	59%
Total Revenue	37,000	5,800				
	100.0%	15.7%		6.3%		
Expenditure						
Personnel	8,228	1,667	11,197	2,398	-731	-30%
Employee Benefits	566	385	2,000	446	-61	-14%
Contractual	16,555	202	19,100	15,392	-15,190	-99%
Commodities	2,050	1,274	2,075	524	750	143%
Other	4,000	150	1,500	150	150	
Total Expenditure	31,399	3,678	35,872	18,760	-15,082	-80%
	100.0%	11.7%		52.3%		
Surplus/(Deficit)	\$5,601	\$2,122	\$22,328	-\$15,110		

ELLIS OTHER RENTALS - 121

	Current Year FY18		Prior Year FY17		YTD Variance	
	Budget	YTD	Budget	YTD	\$ Change	% Change
Revenue						
Donations	-	-				
Security Deposit	600	-	600	250	-250	
Credit Card Revenue	-	-				
Program Revenue	4,500	-	4,500	429	-429	
Total Revenue	5,100	-	5,100	679	-679	
	100.0%	0.0%		9.5%		
Expenditure						
Personnel	-	-	2,000			
Employee Benefits	-	-	200			
Contractual	-	-				
Commodities	-	-	600			
Other	600	-	2,800			
Total Expenditure	600	-	2,800	-		
	100.0%	0.0%		0.0%		
Surplus/(Deficit)	\$4,500	\$-	\$2,300	\$679		

Kendall County Forest Preserve
Income Statement
For Period Ended 1/31/18

2 Month Budget Percent = 16.7%

ELLIS 5K - 130

Revenue
 Donations
 Security Deposit
 Credit Card Revenue
 Program Revenue
Total Revenue

Expenditure
 Personnel
 Employee Benefits
 Contractual
 Commodities
 Other
Total Expenditure

Surplus/(Deficit)

	Current Year FY18		Prior Year FY17		YTD Variance	
	Budget	YTD	%	Budget	YTD	%
	-	-			-	
	-	-			-	
	-	-			-	
	1,570	295		1,570	170	74%
	1,570	295		1,570	170	74%
	-	-			-	
	63	-		67	-	
	-	-			-	
	1,000	-		2,000	-	
	-	-			-	
	1,063	-		2,067	-	
	\$507	\$295		-\$497	\$170	

Kendall County Forest Preserve
Income Statement
For Period Ended 1/31/18

2 Month Budget Percent = 16.7%

HOOVER GROUNDS - 200

	Current Year FY18		Prior Year FY17		YTD Variance	
	Budget	YTD	Budget	YTD	\$ Change	% Change
Revenue						
Donations	-	-				
Rental Revenue	5,250	500	5,000	500		
Security Deposit Revenue	-	-				
Credit Card Revenue	-	-				
Total Revenue	5,250	500	5,000	500		10.0%
Expenditure						
Personnel	44,200	6,508	42,472	5,149	1,359	26%
Employee Benefits	13,416	2,218	13,059	1,691	527	31%
Contractual	-	-				
Commodities	48,900	5,170	47,900	6,643	-1,473	-22%
Other	6,500	1,083	6,500	858	225	26%
Total Expenditure	113,016	14,979	109,931	14,341	638	4%
Surplus/(Deficit)	-\$107,766	-\$14,479	-\$104,931	-\$13,841		

HOOVER BUNKHOUSE - 201

	Current Year FY18		Prior Year FY17		YTD Variance	
	Budget	YTD	Budget	YTD	\$ Change	% Change
Revenue						
Donations	-	-				
Rental Revenue	33,525	8,115	33,525	4,890	3,225	66%
Security Deposit Revenue	4,000	2,300	1,500	300	2,000	667%
Credit Card Revenue	-	-				
Total Revenue	37,525	10,415	35,025	5,190	5,225	101%
Expenditure						
Personnel	22,100	3,203	21,236	4,400	-1,197	-27%
Employee Benefits	6,707	1,105	6,530	1,185	-80	-7%
Contractual	-	-				
Commodities	-	-				
Other	-	-				
Total Expenditure	28,807	4,309	27,766	5,585	-1,276	-23%
Surplus/(Deficit)	\$8,718	\$6,106	\$7,259	-\$395		

Kendall County Forest Preserve
Income Statement
For Period Ended 1/31/18

2 Month Budget Percent = 16.7%

HOOVER CAMPSITE - 202

	Current Year FY18		Prior Year FY17		YTD Variance	
	Budget	YTD	Budget	YTD	\$ Change	% Change
Revenue						
Donations	-	-				
Rental Revenue	4,500	290	4,500		290	
Security Deposit Revenue	-	-				
Credit Card Revenue	-	-				
Total Revenue	4,500	290	4,500	-	290	
Expenditure						
Personnel	11,050	1,655	10,619	2,201	-546	-25%
Employee Benefits	3,353	557	3,265	615	-58	-9%
Contractual	-	-	-			
Commodities	-	-				
Other	-	-				
Total Expenditure	14,403	2,212	13,884	2,816	-604	-21%
Surplus/(Deficit)	-\$9,903	-\$1,922	-\$9,384	-\$2,816		

HOOVER MEADOWHAWK LODGE - 203

	Current Year FY18		Prior Year FY17		YTD Variance	
	Budget	YTD	Budget	YTD	\$ Change	% Change
Revenue						
Donations	-	-				
Rental Revenue	10,500	2,056	10,500	674	1,382	205%
Security Deposit Revenue	6,500	2,425	5,000	452	1,973	437%
Credit Card Revenue	-	-				
Total Revenue	17,000	4,481	15,500	1,126	3,355	298%
Expenditure						
Personnel	11,050	1,692	10,619	2,200	-508	-23%
Employee Benefits	3,353	560	3,265	615	-55	-9%
Contractual	-	-				
Commodities	-	-				
Other	-	-				
Total Expenditure	14,403	2,252	13,884	2,815	-563	-20%
Surplus/(Deficit)	\$2,597	\$2,229	\$1,616	-\$1,689		

Kendall County Forest Preserve
Income Statement
For Period Ended 1/31/18

2 Month Budget Percent = 16.7%

ENVIRONMENTAL EDUCATION - 300

	Current Year FY18		Prior Year FY17		YTD Variance	
	Budget	YTD	Budget	YTD	\$ Change	% Change
Revenue						
Donations	500	5	500			5
Security Deposit	-	-				
Credit Card Revenue	-	-				
Program Revenue	-	-				
Total Revenue	500	5	500	-		5
Expenditure						
Personnel	-	-				
Employee Benefits	-	-				
Contractual	-	-				
Commodities	400	-				
Other	-	-				
Total Expenditure	400	-	-	-		
Surplus/(Deficit)	\$100	\$5	\$500	\$500		

ENV. EDUCATION SCHOOL PROGRAMS - 301

	Current Year FY18		Prior Year FY17		YTD Variance	
	Budget	YTD	Budget	YTD	\$ Change	% Change
Revenue						
Donations						
Security Deposit						
Credit Card Revenue						
Program Revenue	33,000	2,090	35,960	1,131	959	85%
Total Revenue	33,000	2,090	35,960	1,131	959	85%
Expenditure						
Personnel	29,011	5,400	35,925	7,896	-2,496	-32%
Employee Benefits	4,146	631	5,124	913	-282	-31%
Contractual	-	-				
Commodities	-	-	950	36	-31	-86%
Other	-	-				
Total Expenditure	33,157	6,036	41,999	8,845	-2,809	-32%
Surplus/(Deficit)	-\$157	-\$3,946	-\$6,039	-\$7,714		

Kendall County Forest Preserve
Income Statement
For Period Ended 1/31/18

2 Month Budget Percent = 16.7%

ENV. EDUCATION CAMPS - 302

	Current Year FY18		Prior Year FY17		YTD Variance	
	Budget	YTD	Budget	YTD	\$ Change	% Change
Revenue						
Donations		5				5
Security Deposit						
Credit Card Revenue		3,485	39,118		3,485	
Program Revenue	33,000	3,490	39,118	-	3,490	
Total Revenue	100.0%	100.0%	100.0%	10.6%		
Expenditure						
Personnel		2,199	26,075	282	1,917	680%
Employee Benefits		298	3,719	171	127	74%
Contractual		-				
Commodities		2,000	3,000		100	
Other		-				
Total Expenditure	100.0%	100.0%	100.0%	8.1%	2,144	473%
Surplus/(Deficit)		\$900	\$6,324	-\$453		

ENV. EDUCATION NATURAL BEGINNINGS - 303

	Current Year FY18		Prior Year FY17		YTD Variance	
	Budget	YTD	Budget	YTD	\$ Change	% Change
Revenue						
Donations		-	2,000			
Security Deposit						
Credit Card Revenue		21,090	83,460	8,179	12,911	156%
Program Revenue	79,646	21,090	85,460	8,179	12,911	156%
Total Revenue	100.0%	100.0%	100.0%	9.8%		
Expenditure						
Personnel		9,267	53,293	11,802	-2,535	-21%
Employee Benefits		1,792	8,667	1,876	-84	-4%
Contractual		-				
Commodities		424	4,000	595	-171	-29%
Other		-				
Total Expenditure	100.0%	100.0%	100.0%	14.9%	-2,789	-20%
Surplus/(Deficit)		\$9,606	\$14,229	-\$6,094		

Kendall County Forest Preserve
Income Statement
For Period Ended 1/31/18

2 Month Budget Percent = 16.7%

ENV. EDUCATION PUBLIC PROGRAMS - 304

	Current Year FY18		Prior Year FY17		YTD Variance	
	Budget	YTD	Budget	YTD	\$ Change	% Change
Revenue						
Donations						
Security Deposit						
Credit Card Revenue		390	4,000	235	155	66%
Total Revenue	6,000	390	4,000	235	155	66%
	100.0%	100.0%				
Expenditure						
Personnel	5,500	1,317	3,500	1,293	24	2%
Employee Benefits	722	152	500	152	0	0%
Contractual	-	-	700		84	
Commodities	500	84				
Other	-	-				
Total Expenditure	6,722	1,553	4,700	1,445	108	7%
	100.0%					
Surplus/(Deficit)	-\$722	-\$1,163	-\$700	-\$1,210		

ENV. EDUCATION LAWS OF NATURE - 305

	Current Year FY18		Prior Year FY17		YTD Variance	
	Budget	YTD	Budget	YTD	\$ Change	% Change
Revenue						
Donations						
Security Deposit						
Credit Card Revenue						
Total Revenue	-	-	-	-		
Expenditure						
Personnel	1,750	247	1,750	394	-147	-37%
Employee Benefits	222	35	250	52	-17	-33%
Contractual	-	-				
Commodities	700	162	750	93	69	74%
Other	-	-				
Total Expenditure	2,672	444	2,750	539	-95	-18%
	100.0%					
Surplus/(Deficit)	-\$2,672	-\$444	-\$2,750	-\$539		

Kendall County Forest Preserve
Income Statement
For Period Ended 1/31/18

2 Month Budget Percent = 16.7%

ENV. EDUCATION OTHER PROGRAMS - 306

Revenue
 Donations
 Security Deposit
 Credit Card Revenue
 Program Revenue
Total Revenue

Expenditure
 Personnel
 Employee Benefits
 Contractual
 Commodities
 Other
Total Expenditure

Surplus/(Deficit)

	Current Year FY18		Prior Year FY17		YTD Variance	
	Budget	YTD	%	Budget	YTD	%
	-	-	-	-	-	-
	1,750	144	8.2%	1,750	47	206.5%
	222	135	60.7%	250	4	3270.0%
	-	-	-	750	-	-
	700	-	-	-	-	-
	-	-	-	2,750	51	1.9%
	2,672	279	10.4%	2,750	-\$51	447%
	-\$2,672	-\$279		-\$2,750		

65.5%
 8.3%
 26.2%
 100.0%

Special Events Policy
Kendall County Forest Preserve District

The Kendall County Forest Preserve District will allow Special Events that it deems to be in the public interest to be held on District property. A Special Event will be defined as an event in which District property will be used in a manner that is inconsistent with normal preserve activities, such as an event that involves the sale of concessions and/or other goods and services, the use of temporary structures, or multi-day events.

These Events will not be allowed to disturb the natural resources of the District in any way, and will only be allowed on District properties where the District deems there to be adequate facilities.

- Those persons, groups, or organizations requesting to hold a Special Event on District property will have to obtain a Special Event Permit from the District.
- A two month lead time is required.
- All events are required to supply an itinerary at time of application.
- Business, churches, scouts, school groups, etc. require a Certificate of Insurance naming Kendall County Forest Preserve District as an Additional Insured.

The Special Event Permit fee is in addition to the reservation fee for the location where your event is being held. Reservations may be made up to one year in advance.

The District staff shall, with the concurrence of the Forest Preserve Committee, award the Special Event Permits.

**Special Event Permit Application
Kendall County Forest Preserve District**

Instructions: Please sign the form and return it, along with the appropriate insurance certificate to:

Kendall County Forest Preserve District
110 West Madison Street
Yorkville, IL 60560

Please submit application at least two months prior to the Special Event.

Applicant Information:

Event Name: Shoop Scoot 5K Organization: Channahon-Minooka Running Club

Contact Person: Rheta Murdaugh

Address: 210 S. Raven Road, Shorewood, IL 60404 County: Will
Street City State Zip

Telephone: Home: (815)744-2880 X 101 Cell: (708) 949-1650

E-mail: murdaugh_r2d2@comcast.net

Special Event Information:

Name of Forest Preserve: Baker Woods – Ellis House & Equestrian Center Date(s): Sept. 16, 2018

Event: Shoop Scoot 5k – Fundraising Event for the American Heart Association

Estimated Attendance: 100+

Arrival Time (includes set-up): 7:00 am (race start at 8:30 am)

Departure Time (includes take down): 11:00 am

Will this Special Event include:

A = \$ 50.00

	Yes	No
1. The use of temporary structures?	___	<u>X</u>
2. Collecting/Charging an entrance or registration fee?	<u>X</u>	___
3. Selling concessions/food?	___	<u>X</u>

Will this Special Event include: Yes No

A = \$ 50.00 (continued)

- | | | | |
|----|---------------------------------|-----|----------|
| 4. | Selling goods and services? | ___ | <u>X</u> |
| 5. | Electronically amplified sound? | ___ | <u>X</u> |

B = \$ 150.00

- | | | | |
|----|-------------------------------|----------|----------|
| 6. | Business uses in Preserve? | ___ | <u>X</u> |
| 7. | Group larger than 250 people? | ___ | <u>X</u> |
| 8. | Extensive Use of grounds? | <u>X</u> | ___ |

C = \$ 250.00

- | | | | |
|-----|----------------------------------------------------------|----------|----------|
| 9. | Extensive Use of staff time? | <u>X</u> | ___ |
| 10. | Closes and/or limits part(s) of preserve to other users? | ___ | <u>X</u> |

▶ Permittee will be charged only for the highest category (A, B, or C) that is checked.

Description of the Special Event, including details of any 'Yes' answers from above:

The 5k run will include a 3.1 mile course within the Baker Woods Forest Preserve trail system.

Applicant's Signature: _____

Date: _____

**Special Event Agreement
Kendall County Forest Preserve District**

The Kendall County Forest Preserve District (District) and Rheta Murdaugh (Permittee) agrees as follows:

1. The Permittee shall meet the following insurance requirements:
 - A. Permittee shall have general liability coverage of \$1,000,000 per occurrence.
 - B. Certificates of Insurance must state the following: *The Kendall County Forest Preserve District is an additional insured on a primary and non-contributory basis.*
2. The Permittee shall pay the District \$250.00 for this approved Special Event Permit. Payment is due upon approval of permit.
3. The Permittee agrees to indemnify and hold harmless the District against any and all claims, losses, suits, and damages against the District arising, directly or indirectly out of the use of District premises or performance of this Special Event Agreement, specifically including claims resulting from any act or omission of the Permittee and the District, individually, and/or jointly and severally.
4. If concessions/food is to be sold at the Special Event, the vendors must comply with all requirements and regulations of the Illinois Department of Health and/or other governmental bodies having control over such vending operations, including the Kendall County Health and Human Services Department. The vendor shall possess all food and beverage dispensing licenses, taxes, and permits that are required by law.
5. The Permittee shall limit the Special Event activities to those described in the Special Use Permit Application.
6. The Permittee shall follow all District rules and regulations (see attached).
7. The Special Event Permit and the Permittee shall be present on-site at the Special Event.
8. The attached itinerary shall be a part of the Special Event Agreement.

Kendall County Forest Preserve District:

Signed: _____, Director / President

Permittee:

Signed: _____

Date: January 30, 2018

Kendall County Forest Preserve District 2018 Spring Programs

To register and pay* for a program:

Call 630-553-4025 or email
rantrim@co.kendall.il.us

*Payment required at time of registration

For additional information
on a program:

Call 630-553-2292
or email
edombrowski@co.kendall.il.us

*If a class does not meet its minimum enrollment, it will be cancelled at least two days prior to the event. Early registration prevents cancelled classes!

Spring Break Camps

Amazing Animals

Ages: 4-6

Date & Time: March 26-28, 9 am-12 pm

Location: Hoover Forest Preserve

Price: \$80

If your camper loves animals, they will love this camp. Animal lovers will get a closer look at the animals that call Illinois their home through games, hands-on activities, and crafts. Campers will get the opportunity to meet some of these native animals.

Full STEAM Ahead

Ages: 7-9

Date & Time: March 26-28 1-4 pm

Location: Hoover Forest Preserve

Price: \$80

This camp will enhance the problem solving skills of your curious explorer using fun, hands-on, STEAM based activities. Each day will include different science, technology, engineering, art, math and team building activities.

*Registration forms and additional information can be found online at kendallforest.com

March

10— Making Maple Magic

Ages: All Ages

Location: Hoover Forest Preserve
Meadowhawk Lodge

Time: 9:30-11:30 am

Price: \$7 per person— Register by March 6

Take a guided hike through the woods at Hoover Forest Preserve to learn all about the basics of making maple syrup. After the hike, enjoy a pancake breakfast with real maple syrup!

21—Toddling Naturalist— Wonderful Worms

Ages: 1-3 years old plus caregiver

Location: Hoover Forest Preserve
Meadowhawk Lodge

Time: 10-11 am

Price: \$5 per child— Register by March 19

In this program geared for 1-3 year olds, we will explore the natural world through a variety of activities. Each monthly program includes a combination of nature hikes, stories, songs, games, or crafts.

23—Babes in the Woods— Spunky Skunks

Ages: 4-6 years old plus caregiver

Location: Harris Forest Preserve
Shelter 4

Time: 1-2 pm

Price: \$5 per child— Register by March 21

In this hour-long program for 4-6 year olds, children will discover the wonders of nature through stories, nature hikes, crafts, songs, or games. Every month we will explore a different theme.



April

7—Women in the Wild

Ages: 18+

Location: Richard Young Forest Preserve

Time: 10-11 am

Price: \$5 per person— **Register by April 5**

Think Spring! Join us for a women's only spring wildflower hike. Accompany our knowledgeable and enthusiastic staff on a spring amble through Richard Young and Lyon Forest Preserve.

18—Toddling Naturalist— Spring Wildflowers

Ages: 1-3 years old plus caregiver

Location: Hoover Forest Preserve
Eagle's Nest Pavilion

Time: 10-11 am

Price: \$5 per child— **Register by April 16**

In this program geared for 1-3 year olds, we will explore the natural world through a variety of activities. Each monthly program includes a combination of nature hikes, stories, songs, games, or crafts.

20—Babes in the Woods— Spring Wildflowers

Ages: 4-6 years old plus caregiver

Location: Hoover Forest Preserve
Eagle's Nest Pavilion

Time: 1-2 pm

Price: \$5 per child— **Register by April 18**

In this hour-long program for 4-6 year olds, children will discover the wonders of nature through stories, nature hikes, crafts, songs, or games. Every month we will explore a different theme.

23—Eco Art for Kids

Ages: 6-10 years old

Location: Hoover Forest Preserve
Eagle's Nest Pavilion

Time: 4:30-6 pm

Price: \$5 per child— **Register by April 19**

Art is all around us! These classes will engage young artists of all skill levels with the natural world while helping them appreciate art and nature in a whole new way. We will focus on a different art project each season.

May

19— Safari Saturdays

Ages: 8-12 years old

Location: Hoover Forest Preserve
Eagle's Nest Pavilion

Time: 2-4 pm

Price: \$5 per person— **Register by May 17**

During Safari Saturdays, we will trek through Hoover in a safari style exploration for signs of wildlife. You never know what animal or unique plant you will find on the trail while out and about. We will look for tracks, scats and other evidence wildlife has left behind.

23—Toddling Naturalist— Gardening

Ages: 1-3 years old plus caregiver

Location: Hoover Forest Preserve
Eagle's Nest Pavilion

Time: 10-11 am

Price: \$5 per child— **Register by May 21**

In this program geared for 1-3 year olds, we will explore the natural world through a variety of activities. Each monthly program includes a combination of nature hikes, stories, songs, games, or crafts.

25—Babes in the Woods— Gardening

Ages: 4-6 years old plus caregiver

Location: Hoover Forest Preserve
Eagle's Nest Pavilion

Time: 1-2 pm

Price: \$5 per child— **Register by May 23**

In this hour-long program for 4-6 year olds, children will discover the wonders of nature through stories, nature hikes, crafts, songs, or games. Every month we will explore a different theme.

To register and pay* for a program:

Call 630-553-4025 or email
rantrim@co.kendall.il.us

*Payment required at time of registration

For additional information on a program:

Call 630-553-2292
or email edombrowski@co.kendall.il.us

*If a class does not meet its minimum enrollment, it will be cancelled at least two days prior to the event. Early registration prevents cancelled classes!

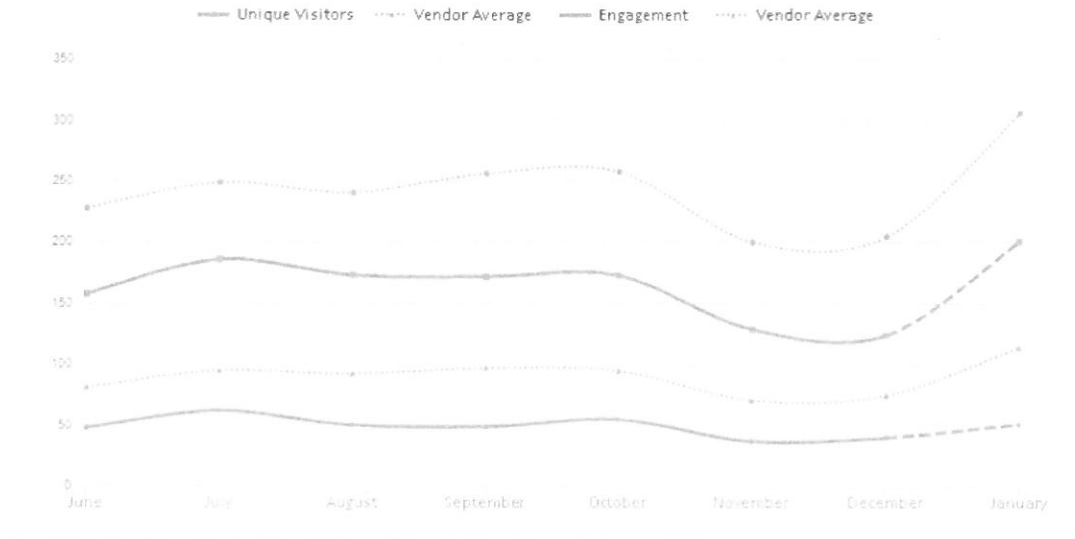

What does this mean?

Unique Page Views - The number of unique users that have viewed your storefront and the tabs within your storefront - photos, videos and reviews tab during the month

Emails & Calls - Total inquiries made through the information request form on your storefront. You will find these inquiries within your Inbox of My Account

Page Views - The total number of views of your storefront and the tabs within your storefront - photos, videos and reviews tab

Total Click-throughs - Total number of clicks from your storefront to your website, Facebook and Twitter pages

Storefront Saves - Total number of times your storefront has been saved to one of our members' My Knot wedding planner.

Engagement - A measure of how often brides are interacting with and taking notable action on your Storefront. This is the sum of Click-Throughs, Calls (Mobile), Inquiries and Storefront Saves. This gives you a great idea of how effective your Storefront is at grabbing a bride's interest and how likely it is to help you generate leads for your business.

Tour Requests - The total number of users who have requested tours from your storefront.

Distribution of Referrals - The percentage of your storefront's traffic from each of the markets in which you advertise. These are calculated by the referrals to your storefront from market results pages

	JUN	JUL	AUG	SEP	OCT	NOV	DEC	Month-to-Date	TOTAL	VENDOR AVG
Unique Visitors	158	186	173	172	173	129	124	201	1316	1,944
Engagement	48	62	50	49	55	37	40	51	392	720
Clickthroughs	29	43	29	36	41	24	27	41	270	442
Storefront Saves	5	14	4	4	6	9	7	6	55	119
Messages & Calls	13	5	15	9	8	4	6	4	64	146
Tour Requests	1	0	2	0	N/A	N/A	N/A	N/A	3	13
Page Views	199	219	217	221	201	169	138	230	1594	2,539

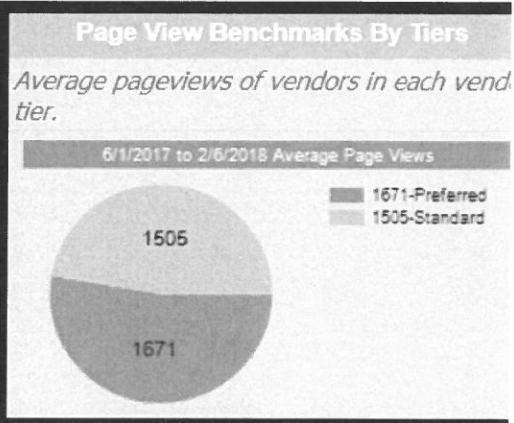
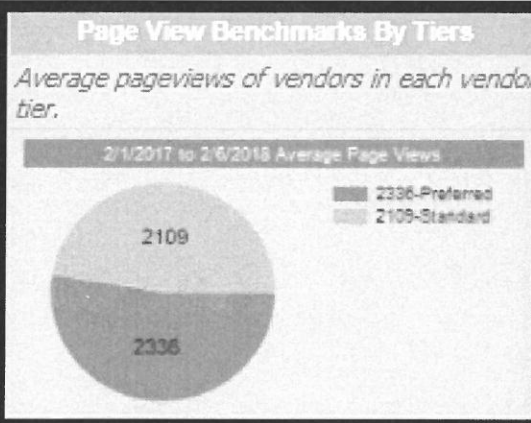
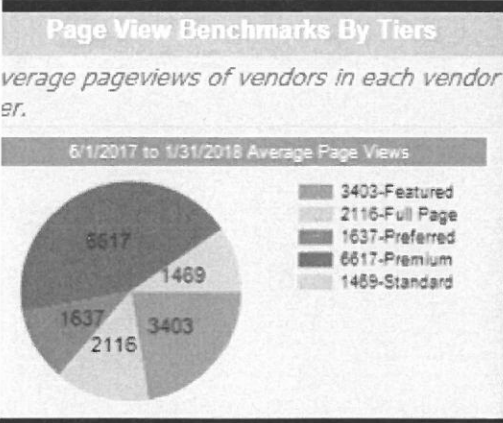

The District's "Standard" placement with "The Knot" will be renewed month-to-month after 6/1/18 at \$250 per month. There is currently a discounted opportunity to change from "Standard" to "Preferred" placement for \$350 per month. The District would lock into a 12-month subscription through June 2019, with an the additional \$1,200 cost split between FY18 and FY19.

Preferred rotates the District's venue position between spots 126-154 versus our current Standard venue rotation placement between spots 155 – 212.

The District received 1,594 page views between 6/1/17 to 1/31/18, exceeding vendor average by 100 + views. If this trend continued with the District's Preferred upgrade, page view traffic would likely increase above 1,637 page views (204+ per month on average).

To: Kendall County Forest Preserve District – Operations Committee

From: David Guritz, Director
Nicole Norton, Ellis Equestrian Center Program Coordinator

RE: Polish National Alliance Field Days at Ellis Equestrian Center
Negotiated Field Experience Schedule and Per Student Fee

Date: February 7, 2018

The District received a request to host summer camp students from the Polish National Alliance Youth Camp in Plano/Yorkville on two separate field days (July 10 and July 12, 2018) for tailored, all-day field trip experiences that incorporate hay rides, lead-line lessons, crafts, and habitat field studies.

The negotiated field trip cost proposed is \$35 per student, with anticipated attendance of 94 students for an estimated combined revenue total of \$3,290.

The PNA camp is submitting a \$100 deposit, with 50% of the estimated balance due June 1, 2018 based on their camp enrollment figures.

This program is building off of a successful pilot program offered in 2017 at a cost of \$20 per student for 90 total students. Following the pilot project, Ellis Equestrian Center staff followed-up with the PNA Youth Camp organizers to discuss their interests in returning, program options, and per student costs.

Revenues received will be deposited into the Ellis Camps cost center. In discussions with Ellis Equestrian Center staff, 3-day summer camp for 6-8 year old children scheduled for the week of July 9 was cancelled and removed from the schedule for summer camp offerings (R/NR average cost \$205 with maximum enrollment/revenues of 15 students/\$3,075).

To: Kendall County Forest Preserve District Operations Committee

From: David Guritz, Executive Director

RE: Request for Waiver/Reduction of Certain Insurance Requirements – Preferred Caterers' Program

Date: February 7, 2018

The District has been approached by Martin Gonzalez DBA Botaneros of Channahon, Illinois who has expressed interest in participation in the District's Preferred Caterers' Program.

A summary of liability insurance coverages, as well as a sample certificate received is attached to this report. I have also attached the survey sent out to all Preferred Catering firms.

In consultation with the insurance carrier, Botaneros currently maintains \$1 million commercial general liability for each occurrence and \$2 million aggregate coverage.

Botaneros does not carry the recommended/required \$5 million umbrella, workers comp which is not applicable (owners are direct service providers). The firm does carry hired non-owned auto coverage per the insurance carrier. The catering firm would not be serving liquor, and so would not be required to carry liquor liability coverage.

The insurance carrier indicated that the client's premium would be increased by \$750 for each additional \$1M of commercial general liability required, or \$2,250 to achieve \$5M of total coverage.

President Gilmour asked that I convey her concerns that the firm does not carry the required coverage for consideration as part of Operations Committee deliberations on the topic.

District staff is requesting direction from the Operations Committee for formal response to the request to waive the additional required \$3M general liability/umbrella liability coverage.

		Approved Insurance Coverage Requirements		
		Catering Firms	Bartending Services	Botaneros - Current Coverage
Comprehensive General Liability				
Bodily Injury		\$1M per occurrence; \$2M aggregate	\$1M per; \$1M aggregate	
Property Damage		\$1M per occurrence; \$2M aggregate	\$1M per; \$1M aggregate	\$100,000 per occurrence
Bodily Injury and Property Damage Combined		\$1M per occurrence; \$2M aggregate	\$1M per; \$1M aggregate	
Personal Injury		\$2M aggregate per project	\$1M aggregate per project	
OR				
Commercial General Liability				
General Aggregate per Project		\$2M	\$1M	\$2M
Products Completed Operations Aggregate		\$1M	\$1M	\$2M
Personal and Advertising Injury		\$1M	\$1M	\$1M
Per Occurrence		\$1M	\$1M	\$1M
Medical Expenses (any one person)		\$1,000	\$1,000	N/A
AND				
Umbrella Liability per Occurrence				
Per Occurrence		\$5M	\$1M	N/A
Aggregate		\$5M	\$1M	N/A
Worker's Compensation				
State		Statutory	Statutory	N/A
Applicable Federal		Statutory	Statutory	N/A
Employer's Liability		A, B and C \$500,000	A, B and C \$500,000	N/A
Business Automobile Liability (owned, non-owned and hired)				
Bodily Injury and Property Damage Combined		\$1M per occurrence	Hired and Non-Owned Auto	\$1M hired non-owned
Liquor Liability Insurance				
Liquor Liability Insurance		\$1M per occurrence	\$1M	N/A

The District requires a certificate of insurance naming the Kendall County Forest Preserve District, Ellis House and Meadowhawk Lodge as additionally insured as the certificate holder. The District requires a current Health Department Permit and a Food Service Inspection Report for catering firms (within past 6-months).



CERTIFICATE OF LIABILITY INSURANCE

DATE (MM/DD/YYYY) 05/23/2017

THIS CERTIFICATE IS ISSUED AS A MATTER OF INFORMATION ONLY AND CONFERS NO RIGHTS UPON THE CERTIFICATE HOLDER. THIS CERTIFICATE DOES NOT AFFIRMATIVELY OR NEGATIVELY AMEND, EXTEND OR ALTER THE COVERAGE AFFORDED BY THE POLICIES BELOW. THIS CERTIFICATE OF INSURANCE DOES NOT CONSTITUTE A CONTRACT BETWEEN THE ISSUING INSURER(S), AUTHORIZED REPRESENTATIVE OR PRODUCER, AND THE CERTIFICATE HOLDER.

IMPORTANT: If the certificate holder is an ADDITIONAL INSURED, the policy(ies) must be endorsed. If SUBROGATION IS WAIVED, subject to the terms and conditions of the policy, certain policies may require an endorsement. A statement on this certificate does not confer rights to the certificate holder in lieu of such endorsement(s).

PRODUCER PAR Insurance 14722 S. Naperville Road, Unit #116 Plainfield, IL 60544 Phone (815) 254-7900 Fax (815) 254-7339	CONTACT NAME: Bill Rademacher PHONE (A/C, No, Ext): (815) 254-7900 FAX (A/C, No): (815) 254-7339 E-MAIL ADDRESS: info@parinsurance.com														
INSURED Martin Gonzalez DBA Botaneros 26265 S Rachael Dr Channahon IL 60410	<table border="1" style="width: 100%; border-collapse: collapse;"> <tr> <th style="text-align: center;">INSURER(S) AFFORDING COVERAGE</th> <th style="text-align: center;">NAIC #</th> </tr> <tr> <td>INSURER A: NSI</td> <td></td> </tr> <tr> <td>INSURER B:</td> <td></td> </tr> <tr> <td>INSURER C:</td> <td></td> </tr> <tr> <td>INSURER D:</td> <td></td> </tr> <tr> <td>INSURER E:</td> <td></td> </tr> <tr> <td>INSURER F:</td> <td></td> </tr> </table>	INSURER(S) AFFORDING COVERAGE	NAIC #	INSURER A: NSI		INSURER B:		INSURER C:		INSURER D:		INSURER E:		INSURER F:	
INSURER(S) AFFORDING COVERAGE	NAIC #														
INSURER A: NSI															
INSURER B:															
INSURER C:															
INSURER D:															
INSURER E:															
INSURER F:															

COVERAGES	CERTIFICATE NUMBER:	REVISION NUMBER:
------------------	----------------------------	-------------------------

THIS IS TO CERTIFY THAT THE POLICIES OF INSURANCE LISTED BELOW HAVE BEEN ISSUED TO THE INSURED NAMED ABOVE FOR THE POLICY PERIOD INDICATED. NOTWITHSTANDING ANY REQUIREMENT, TERM OR CONDITION OF ANY CONTRACT OR OTHER DOCUMENT WITH RESPECT TO WHICH THIS CERTIFICATE MAY BE ISSUED OR MAY PERTAIN, THE INSURANCE AFFORDED BY THE POLICIES DESCRIBED HEREIN IS SUBJECT TO ALL THE TERMS, EXCLUSIONS AND CONDITIONS OF SUCH POLICIES. LIMITS SHOWN MAY HAVE BEEN REDUCED BY PAID CLAIMS.

INSR LTR	TYPE OF INSURANCE	ADDLSUBR INSR	WVD	POLICY NUMBER	POLICY EFF (MM/DD/YYYY)	POLICY EXP (MM/DD/YYYY)	LIMITS
A	<input checked="" type="checkbox"/> COMMERCIAL GENERAL LIABILITY <input type="checkbox"/> CLAIMS-MADE <input checked="" type="checkbox"/> OCCUR <input type="checkbox"/> _____ <input type="checkbox"/> _____ GEN'L AGGREGATE LIMIT APPLIES PER: <input type="checkbox"/> POLICY <input type="checkbox"/> PRO-JECT <input type="checkbox"/> LOC <input type="checkbox"/> OTHER	Y	Y	A140329	05/01/2017	05/01/2018	EACH OCCURRENCE \$ 1,000,000.00 DAMAGE TO RENTED PREMISES (Ea occurrence) \$ 100,000.00 MED EXP (Any one person) \$ PERSONAL & ADV INJURY \$ 1,000,000.00 GENERAL AGGREGATE \$ 2,000,000.00 PRODUCTS - COMP/OP AGG \$ 2,000,000.00 \$
	AUTOMOBILE LIABILITY <input type="checkbox"/> ANY AUTO <input type="checkbox"/> ALL OWNED AUTOS <input type="checkbox"/> SCHEDULED AUTOS <input type="checkbox"/> HIRED AUTOS <input type="checkbox"/> NON-OWNED AUTOS <input type="checkbox"/>						COMBINED SINGLE LIMIT (Ea accident) \$ BODILY INJURY (Per person) \$ BODILY INJURY (Per accident) \$ PROPERTY DAMAGE (Per accident) \$ \$
	<input type="checkbox"/> UMBRELLA LIAB <input type="checkbox"/> OCCUR <input type="checkbox"/> EXCESS LIAB <input type="checkbox"/> CLAIMS-MADE <input type="checkbox"/> DED <input type="checkbox"/> RETENTION \$						EACH OCCURRENCE \$ AGGREGATE \$ \$
	WORKERS COMPENSATION AND EMPLOYERS' LIABILITY Y / N ANY PROPRIETOR/PARTNER/EXECUTIVE OFFICER/MEMBER EXCLUDED? (Mandatory in NH) If yes, describe under DESCRIPTION OF OPERATIONS below	N / A					<input type="checkbox"/> PER STATUTE <input type="checkbox"/> OTHER E.L. EACH ACCIDENT \$ E.L. DISEASE - EA EMPLOYEE \$ E.L. DISEASE - POLICY LIMIT \$

DESCRIPTION OF OPERATIONS / LOCATIONS / VEHICLES (Attach ACORD 101, Additional Remarks Schedule, if more space is required)
 RE: Centennial Celebration 2017
 Certificate Holder is additional insured. A waiver of subrogation applies in favor of the Certificate Holder. 30 days cancellation notice applies

CERTIFICATE HOLDER Cathedral of St Raymond Nonnatus 604 N Raynor Ave Joliet, IL 60435	CANCELLATION SHOULD ANY OF THE ABOVE DESCRIBED POLICIES BE CANCELLED BEFORE THE EXPIRATION DATE THEREOF, NOTICE WILL BE DELIVERED IN ACCORDANCE WITH THE POLICY PROVISIONS. AUTHORIZED REPRESENTATIVE
-----------------------------------------------------------------------------------------------------------	--------------------------------------------------------------------------------------------------------------------------------------------------------------------------------------------------------------------------------

December 4, 2017

Dear Preferred Caterers and Alcohol Service Providers:

Thank you for your past participation in the Kendall County Forest Preserve District's Preferred Caterers' Program.

The District is in process of surveying our preferred catering and/or alcohol service vendors. In 2017, the District's Board of Commissioners instituted new insurance requirements for its Preferred Caterers Program vendors. These changes included modification of the District's General Use Ordinance to allow clients and vendors a new option for serving alcohol for contracted events hosted at Ellis House and Meadowhawk Lodge.

As part of this program, catering firms participating in the District's Preferred Caterers Program may extend alcohol service to clients for District-contracted events provided the catering firm:

1. Extends the required dram shop liability coverage and other required coverage amounts (Attachment 1 – Insurance Requirements);
2. Secures the required Kendall County Health Department permit and inspection report;
3. Secures the required Kendall County liquor license; and
4. Submits the Kendall County Forest Preserve District Preferred Catering Program enrollment form and \$300.00 annual fee.

Alternatively, catering firms and/or clients may now contract directly with those businesses extending alcohol service only that elect to enroll in the 2018 Preferred Caterers Program. Businesses extending alcohol service only must:

1. Employ and/or contract with bartenders that have secured current Beverage Alcohol Sellers and Servers Education and Training (BASSET) certification;
2. Extend the required insurance coverage amounts (Attachment 1 – Insurance Requirements)
3. Submit the Kendall County Forest Preserve District Preferred Catering Program enrollment form and annual fee of \$300.00.

A list of the current approved insurance coverage requirements for the Preferred Catering Program is attached to this letter. **The District is in the process of surveying past participating catering firms to determine whether your participation and enrollment will be negatively impacted by changes to the required insurance coverage amounts.** Please complete the attached survey, or contact the District directly with your comments or concerns for the upcoming year.

Thank you, again, for your continued participation in the District's Preferred Catering Program.

Sincerely,

Dave Guritz, Director
(630) 553-4131
dguritz@co.kendall.il.us

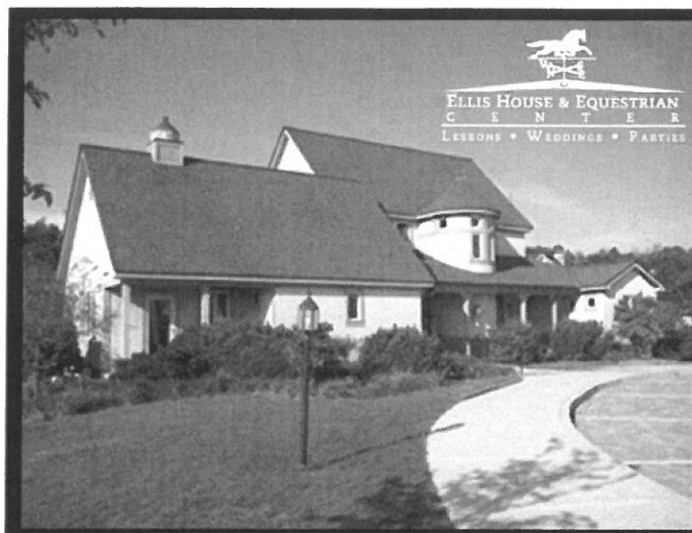

Ellis House and Equestrian Center



Meadowhawk Lodge

Preferred Caterer Program Benefits

The Kendall County Forest Preserve District extends the following benefits to our Preferred Catering Firms:

- Website listing, including an option to post a link to your website from the District's website.
- Catering firm listing and direct contact information in the District's venue catalog brochures.
- Display of catering firm brochures at both Ellis House and the Kendall County Historic Courthouse.
- Promotion of catering firm menus at the District's Bridal Expo and other showcase events attended by District staff members.
- Distribution of catering firm brochures and menus in the District's tour folder, given to prospective Ellis House or Meadowhawk Lodge clients.

The signed Ellis House and Meadowhawk Lodge Catering Permit, fees and required paperwork must be received before we can continue to publish your preferred caterer status and continue advertising your services.

Ellis House leases a 40x80 tent from May through October. In addition to the tent, the District supplies 33 – 60" round tables, 12 – 6' banquet tables, 6 – 30" round cocktail tables, and 200 white plastic resin chairs. This equipment is only used outside in the tent.

Meadowhawk Lodge offers 24 – 60" round tables, 12 – 6' banquet tables, and 150 white plastic chairs.

As a reminder neither Ellis House nor Meadowhawk Lodge allow glass beer bottles as a safety measure.

**Invitation for Continued Participation in the Kendall County Forest Preserve
District's Preferred Caterers Program**

2018

Attachment A – 2018 Preferred Caterers Program: Required Insurance Coverage Amounts

The chart below provides a summary of the insurance coverage requirements for catering firms and bartending service businesses serving food and/or alcohol at District venues.

Preferred Catering Program - Pre-Enrollment Survey of Required Insurance Coverages Amounts				
1. Please review your firm's current coverage amounts. 2. Note that Comprehensive General OR Commercial General Liability Coverage is required. Umbrella Liability, Worker's Compensation Liability, Business Auto (owned, non-owned, hired), and Liquor Liability Coverage Optional for Catering Firms (required to serve alcohol at District events). 3. Mark an (X) where the firm does not meet the required coverage. 3. Indicate the amount of coverage your firm would be able/willing to bind (if any?) to remain in the Preferred Catering Program.				
Insurance Coverage Types and Amounts	2018 Preferred Catering Program - Insurance Coverage Requirements for Catering and Bartending Service Businesses			(X) Please Indicate if Your Firm Currently Maintains (or Plans to Secure) the Required Coverage Amounts
	COLUMN A: Catering Firms	COLUMN B: Bartending Services		
Comprehensive General Liability				
Bodily Injury	\$1M per occurrence; \$2M aggregate	\$1M per; \$1M aggregate		
Property Damage	\$1M per occurrence; \$2M aggregate	\$1M per; \$1M aggregate		
Bodily Injury and Property Damage Combined	\$1M per occurrence; \$2M aggregate	\$1M per; \$1M aggregate		
Personal Injury	\$2M aggregate per project	\$1M aggregate per project		
OR				
Commercial General Liability				
General Aggregate per Project	\$2M	\$1M		
Products Completed Operations Aggregate	\$1M	\$1M		
Personal and Advertising Injury	\$1M	\$1M		
Per Occurance	\$1M	\$1M		
Medical Expenses (any one person)	\$1,000	\$1,000		
AND				
Umbrella Liability per Occurance				
Per Occurance	\$5M	\$1M		
Aggregate	\$5M	\$1M		
Worker's Compensation				
State	Statutory	Statutory		
Applicable Federal	Statutory	Statutory		
Employer's Liability	A, B and C \$500,000	A, B and C \$500,000		
Business Automobile Liability (owned, non-owned and hired vehicles)				
Bodily Injury and Property Damage Combined	\$1M per occurrence	Hired and Non-Owned Auto		
Liquor Liability Insurance				
Liquor Liability Insurance	\$1M per occurrence	\$1M		
The District requires a certificate of insurance naming the Kendall County Forest Preserve District, Ellis House and Meadowhawk Lodge as additionally insured as the certificate holder. The District also requires a current Health Department Permit and a Food Service Inspection Report for catering firms (within past 6-months).				

PLEASE NOTE THAT THE DISTRICT IS EVALUATING THE REQUIRED COVERAGE AMOUNTS

PLEASE INDICATE IF YOU PLAN TO WITHDRAWL FROM THE 2018 PREFERRED CATERING PROGRAM DUE TO INCREASED INSURANCE COVERAGE AMOUNTS. INFORMATION WILL BE SHARED WITH THE DISTRICT'S BOARD OF COMMISSIONERS FOR CONSIDERATION AND POSSIBLE AMENDMENT OF THE REQUIRED COVERAGE AMOUNTS.

Event Date	Type of Event	Anticipated Rental Payment	Rental Payment Due	Rental Amount Paid	Security Deposit	Security Dep. Paid/Ret'd
Weddings / Receptions - 2018						
Kennelly 24-Mar-18	Wedding Reception	\$1,575.00	24-Feb-18		\$750.00	Pd. 6/12/17
Krasowski 22-Sep-18	Wedding Ceremony	\$1,600.00	22-Jul-18		\$800.00	Pd. 1/4/18
Other Rentals - 2018						
Larson 6-Jan-18	Going Away Party	\$255.00	14-Nov-17	\$255.00	\$127.50	Return 1/16
Andrews 20-Jan-18	Church Dinner	\$212.50	4-Jan-18	\$212.50	\$106.25	Pd. 1/5/18
28-Jan-18	Bridal Shower	\$255.00	28-Dec-17	\$255.00	\$127.50	Pd. 7/19/17
KC Democrats						
(Sutcliff) 30-Jan-18	Committee Meeting	\$137.50	30-Dec-17	\$137.50	\$68.75	Pd. 11/17/17
Gawne 10-Feb-18	Anniversary Party	\$305.00	10-Dec-17	\$305.00	\$152.50	Pd. 8/21/17
Marx 2-Mar-18	Church Retreat	\$560.00	2-Feb-18		\$305.00	Pd. 1/3/18
Konow 4-Mar-18	Birthday Party	\$255.00	26-Jan-18	\$255.00	\$127.50	Pd. 1/12/18
Savage 31-Mar-18	Birthday Party	\$180.00	31-Jan-18	\$180.00	\$90.00	Pd. 10/9/17
Gulling 14-Apr-18	Baby Shower	\$270.00	15-Feb-18		\$127.50	
KC Justice 21-Apr-18	5K Run	\$0.00	-	-	\$0.00	-
Frantes! 28-Apr-18	Bridal Shower	\$255.00	28-Feb-18		\$127.50	Pd. 12/13/17
KC Soil & Water May 2 & 9, 2018 Environmental Science						
		\$0.00	-	-	\$0.00	-
Simon 19-May-18	Bridal Shower	\$337.50	19-Mar-18	\$337.50	\$168.75	Pd. 1/12/18
Patel June 6-10	Retreat	\$1,250.00	6-Apr-18		\$625.00	Pd. 12/18/17
Torok 14-Jul-18	Graduation/Birthday	\$330.00	14-May-18		\$165.00	
KC University of Ill						
Ext 23-Aug-18	Staff Retreat	\$0.00	-	-	\$0.00	-
				\$1,937.50	\$3,868.75	
				\$7,777.50	\$1,937.50	\$3,868.75

Antim 1/19/18

We save land.



We save rivers.

Chairman

Christopher Burke, PhD

Vice Chairman

Nancy Hopp

Treasurer

Thomas Schneider

Secretary

Tom Bennington

Trustees

- John Binneboese
- Gail Bumgarner
- Pete Connolly
- Ken Holmstrom
- David Hulseberg
- Robert Hutchinson
- Susan Jayne
- Julie Long
- Joe Mikan
- Kaaren Oldfield
- D. "Dewey" Pierotti
- Jack Pizzo
- Ben Schwarz
- Patricia Taichert
- Lois Vitt Sale
- Daniel Wagner
- Dennis E. Wisnosky

Leadership Board

- James Bramsen
President/CEO
Spraying Systems
Company
- Anthony A. Casaccio
President
Inland Real Estate
Development Corp.
- Christine Sobek, EdD
President
Waubonsee Community College
- Robert J. Schillerstrom
Former Chairman
DuPage County
- Stephen C. Van Arsdell
Retired Chairman/CEO
Deloitte & Touche
- Jack E. Mensching
President
Itasca Bank & Trust Co.

President/CEO
Brook McDonald

January 18, 2018

Mr. Dave Guritz
Kendall County Forest Preserve District
110 W Madison St
Yorkville, IL 60560

Dear Mr. Guritz,

As a past supporter of our Earth Day Benefit Dinner, we greatly appreciate your commitment to the protection of our natural environment.

The Earth Day Benefit Dinner is vital to continuing our work to save nature in your neighborhood, and this year's dinner will be held **April 19th, 2018** at Bobak's Signature Events and Conference Center in Woodridge, IL.

Our guests have told us many times how much they enjoy our nature-inspired silent auction. **It has become the premier nature-inspired silent auctions in the region**, and your donation last year led to our most amazing Benefit Dinner to date. We expect 600 attendees this year with guests including elected officials, corporate executive leaders and community leaders. Please consider a donation to our Benefit Dinner by **contributing to the 2018 Earth Day Benefit Dinner silent auction.**



We love being able to showcase the creativity and talent of those closest to us while also raising money to protect our environment. Feel free to get in touch with me using the contact information below. There is a form included for your donation details. You can also visit www.theconservationfoundation.org/benefitdinner to find out more about the event. We'd love to have you attend and usher in Spring with us!

Thank you in advance for your help. You are greatly appreciated!

Best Regards,

Scott LaMorte
Senior Advancement Officer
slamorte@theconservationfoundation.org
Phone: 630-428-4500, Ext. 142
Fax: 630-428-4599

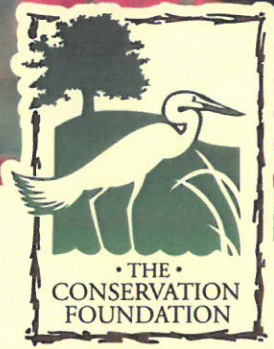

Earth Day Benefit Dinner

April 19th, 2018

Auction Item Donation Response Form

The Conservation Foundation relies on the generosity of local businesses and community members for the items offered to our guests at the acclaimed Earth Day Benefit Dinner Silent Auction. All donors will have their names prominently displayed on our BidPal electronic auction devices as well as in the event program.

**Yes! I want to provide an auction item to the silent auction for
The Conservation Foundation's Earth Day Benefit Dinner.**

Contact Name _____

Company Name (if applicable) _____

Address _____

City, State, Zip _____

Phone _____ Email _____

Item(s) to be Donated _____

Estimated Value _____

We will be happy to make arrangements for your donation to be picked up.

Item needs to be picked up? _____ yes _____ no

**Please contact Scott LaMorte at 630-428-4500, Ext. 142 or
slamorte@theconservationfoundation.org with any questions.**

You can mail this form to 10S404 Knoch Knolls Rd, Naperville, IL 60565, fax to 630-428-4599 or email it to slamorte@theconservationfoundation.org. Thank you so much for your support!

To: Kendall County Forest Preserve District Operations Committee

From: David Guritz, Director
Emily Dombrowski, Environmental Education Program Manager

RE: First-Quarter Marketing Initiatives: December 1, 2017 – February 6, 2018

Date: February 7, 2018

First Quarter Marketing Initiatives

Social Media Stats

FB Pages

Kendall County Forest Preserve District Education Department- 1,455 likes
Ellis House and Equestrian Center- 663 likes
Natural Beginnings- 1,060 likes
Hoover Forest Preserve- 471 likes

Constant Contact 1,433 subscribers (30.5% open rate)
Instagram 214 followers
The Knot 1,594 page views (6/1/17-1/31/18)

Chamber Blasts Bridal Expo – Currently scheduled (Oswego Chamber/Joliet Chamber)

FB Ads

2018 Bridal Expo (Currently running)
2018 Spring Break and Summer Camps (Currently running)
Special Event Venues (Ellis/MHL) Promotional Second Event Discount (\$87.12)
NB Open House (\$86.87)



Print Ads

Bridal Expo

(Record Newspapers; Joliet-Morris Wedding Magazine; Free Press Newspapers (Morris-Coal City); Upcoming Bridal Inserts)

Summer Camps

Chronicle Summer Camp Guide (Kendall; Kane; West Suburban)

Other Marketing Initiatives Completed

- Stepping Stones Winter 2018 eNewsletter
- Online Calendar of Events
- Online Preserves and Amenities Map

Second Quarter Marketing Initiatives Planned

Social Media Ads

- Stepping Stones Post Boosts (Quarterly)
- Maple Syrup Post Boost (Winter)
- Ellis Lessons Catalog (Winter-Spring-Summer-Fall)
- 2018 Spring Break and Summer Camps (Winter-Spring-Summer)
- Event Venues – Target Audience Diversification (Winter-Spring-Summer-Fall)
- Hoofin’ It 5K (Summer-Fall)
- Natural Beginnings – 19-20 Program Year Target Recruitment



2018 CALENDAR OF EVENTS

February



ELLIS HOUSE BRIDAL EXPO

Ellis House & Equestrian Center

February 18 from 11 am–2 pm

From food to flowers, limousines to honeymoons – you'll find a wide range of wedding merchants eager to please a variety of tastes and budgets.

June



NATIONAL MUD DAY CELEBRATION

Hoover Forest Preserve

June 30 from 10:30 am–12 pm

Feel the mud squish between your fingers as we make mud pies, create mud artwork, and learn that it is okay to get dirty!

March



PLANTS OF CONCERN TRAINING

Kendall County Historic Courthouse

March 3 from 9 am–3 pm

MAKING MAPLE MAGIC

Hoover Forest Preserve

March 10 from 9:30 am–11:30 am

Take a guided hike to discover how sap becomes syrup and enjoy a pancake breakfast afterwards.

September



FALL BIRDING HIKE

Hoover Forest Preserve

September 15 from 10 am–12 pm

Join a local birding expert on a morning hike to look for local and migrating birds.

HOOFIN' IT 5K

Ellis House Equestrian Center

September 30 from 8 am–11 am

April



EARTH DAY CELEBRATION

Hoover Forest Preserve

April 21 from 11 am--2 pm

Come and celebrate the earth at the Hoover Forest Preserve Nature Play Space!

October



CREATURES OF THE NIGHT

Hoover Forest Preserve

October 20 from 5:30 pm--7 pm

Creatures of the Night combines the make-believe, spooky fun of Halloween with the beauty of nighttime nature.

May



NATIVE PLANT SALE

Harris Forest Preserve

May 27 from 10 am–1 pm

Support the Kendall County Forest Foundation and fill your yard and garden with native plants.

November



TURKEY TALK

Hoover Forest Preserve

November 17 from 1 pm--3 pm

Celebrate Thanksgiving by learning all about turkeys!

Visit kendallforest.com for details on these events and more!

Things to Do...

Hiking

- Hoover
- Harris
- Lyon/Richard Young
- Subat
- Maramech
- Baker Woods—Ellis House
- Jay Woods
- Millbrook South

Camping & Bunkhouse Rentals

- Hoover Forest Preserve
(*by reservation only*)

Canoeing & Kayaking

- Fox River Water Tail
- Shuh Shuh Gah Canoe Launch

Lessons & Horseback Riding Trails

- Ellis Equestrian Center
- Harris
- Hoover

Shelter Rentals

- Harris
- Jay Woods
- Richard Young

Special Event Venue Rentals

- Ellis House
- Hoover—Meadowhawk Lodge

Information & Contacts

Main Office (630) 553-4025

Ellis House and Equestrian Center
(815) 475-4035

Visit us online at:

KendallForest.com

EllisHEC.com

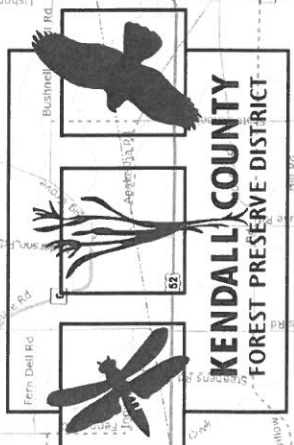
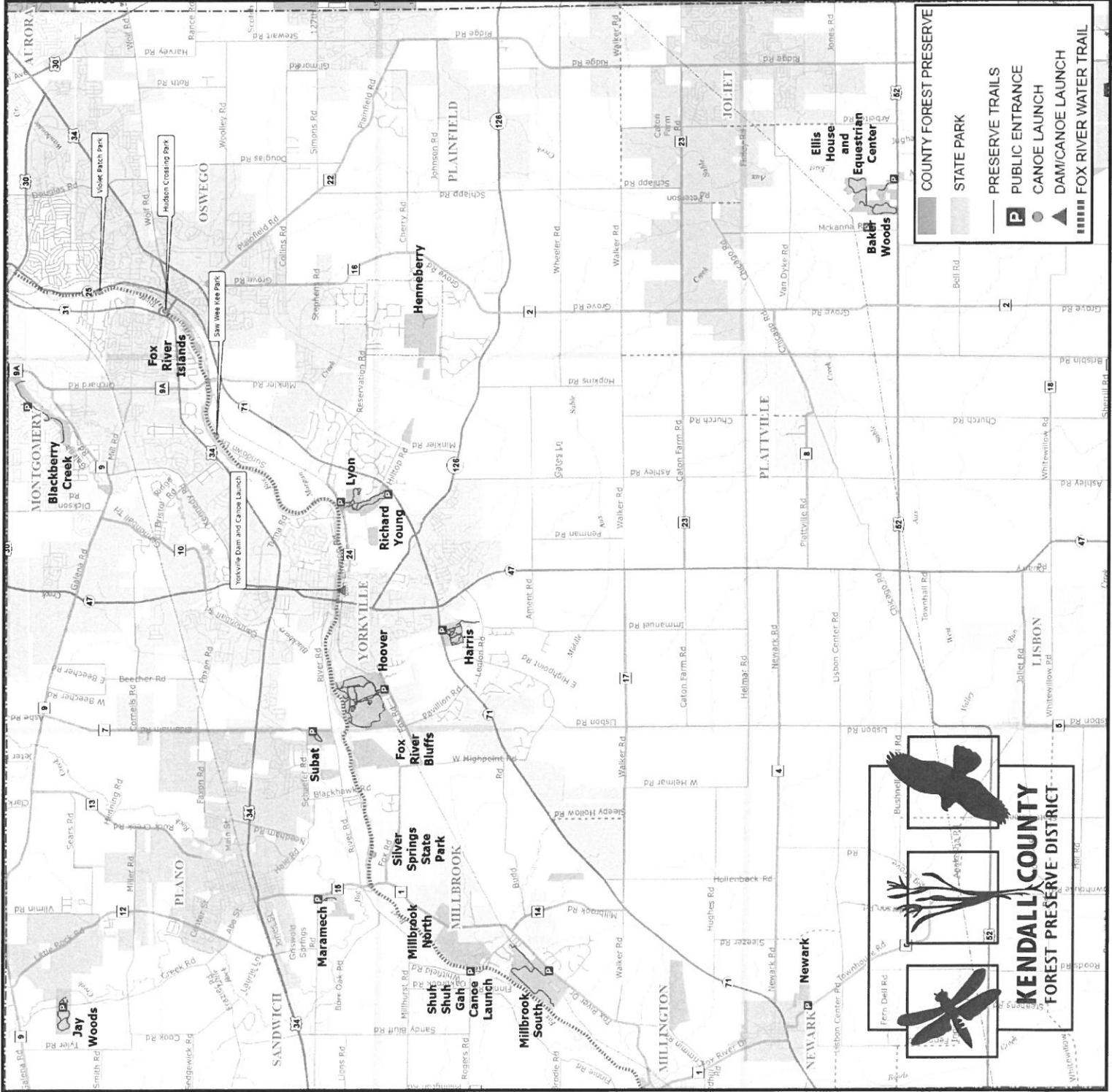

Kendall County Forest Preserve District Board of Commissioners

Judy Gilmour, President
 Matt Prochaska, Vice President
 Elizabeth Flowers, Secretary
 Lynn Cullick
 Bob Davidson

Scott Gryder
 Tony Giles
 Audra Hendrix
 Matt Kellogg
 John Purcell

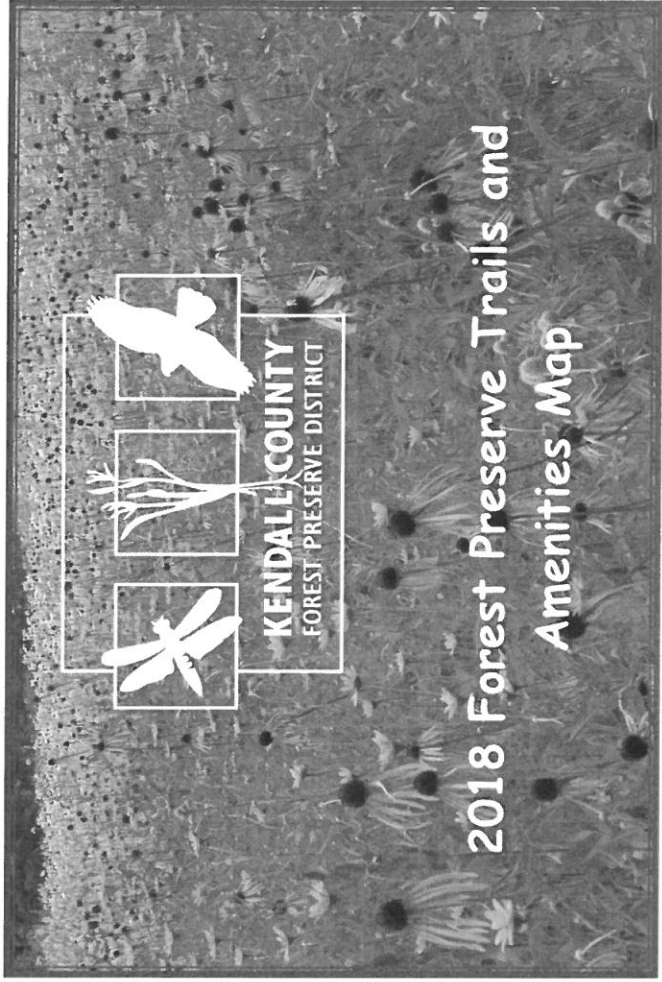
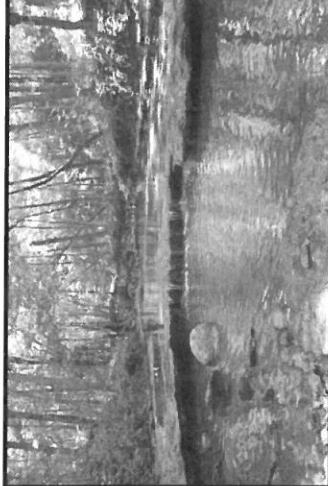
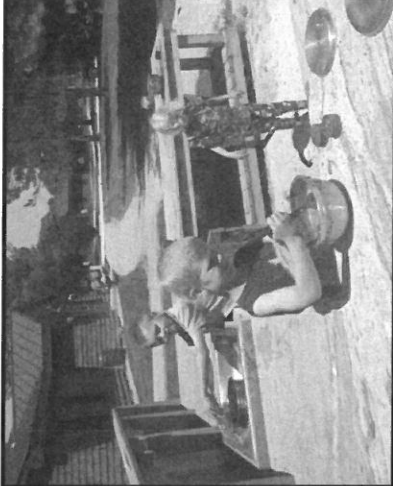
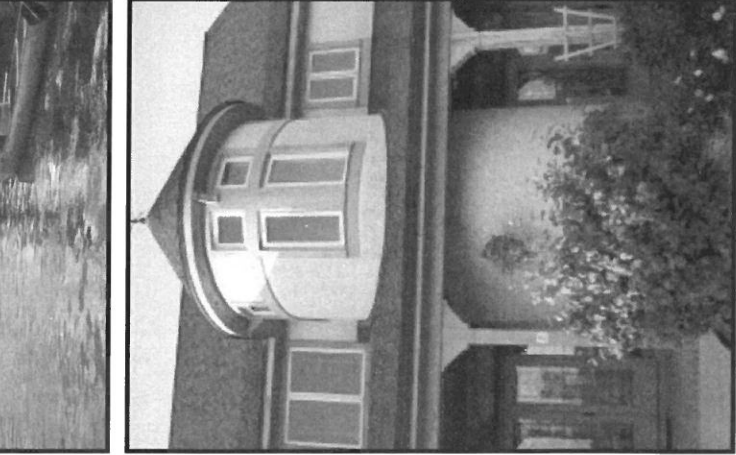

2018 Forest Preserve Trails and Amenities Map

2018 Calendar of Events

January 15	Summer Camp & Natural Beginnings Open Registration
February 18	Ellis House Bridal Expo
March 3	Plants of Concerns Volunteer Training
March 10	Making Maple Magic
April 21	Earth Day Celebration- Hoover Nature Play Space
May 27	Native-Plant Pre-Sale and Pickup
June 14	Pollinator Potluck - Volunteer Appreciation Picnic
September 15	Fall Birding Hike
September 30	Hoofin' It 5k
October 20	Creatures of the Night-Halloween-themed Family Program
November 17	Turkey Talk-Thanksgiving-themed Family Program

For more information on these programs contact Emily Dombrowski, Environmental Education Program Manager, at 630-553-2292 or email edombrowski@eco.kendall.il.us



Kendall County GIS

111 West Fox Street - Room 308
 Yorkville, Illinois 60560-1498
 630.553.4030

Compiled using data through 12/31/2016



To: Kendall County Operations Committee

From: David Guritz, Director

RE: Operational Updates

Date: February 7, 2018

Little Rock Creek Acquisition Project Updates

The District anticipates receiving IDNR certification of the appraisals next week. This would put the District on track for presenting the State's letter of notification to proceed to the Committee of the Whole on February 14, 2018, with subsequent posting of approval of a letter of intent, with required backup forms on the February 20 Commission agenda.

Presuming the Board of Commissioners approves the offer letter, and the offer letter is formally accepted by TCF, with backup forms returned, the Board of Commissioners would be in a position to consider a purchase ordinance and contract at the March 6 Commission meeting.

General Use Ordinance Violations and Enforcement Discussions

Per Operations Committee direction, staff have begun efforts to survey other forest preserves and park districts to determine whether there are examples where District staff are authorized to take enforcement action for violations of park use rules or general use violations.

Hoover Forest Preserve – NPDES Permit and Lift Station Pump Replacements

The District has submitted permit renewal information to the Illinois Environmental Protection Agency. Our current permit expires in June 2018.

Kuhn Plumbing of Oswego has been scheduled for a service call on February 15 to determine the model of the lift station pumps that will require replacement. The service call estimate is under \$1,000. No records were retained by the BSA's engineering firm.

Hoover Forest Preserve – Parking Lot Lighting Inspection

A request has been sent to Riemenschneider Electric, Inc. to complete an inspection of the parking lot lights to determine whether work beyond bulb replacements will be needed. The Board of Commissioners will be copied on the results.

FHA-RTP Public Hearing

The notice of the public hearing is attached, and will take place at the Kendall County Historic Courthouse on Thursday, February 15, 2018 from 5:30 to 7:30 pm.

Millbrook Bridge Conservation Plan Public Notice

The notice for the public comment period is attached, and will begin February 8, 2018 extending through April 1, 2018. The conservation plan has been posted online by the IDNR, and is on display at the District's office and Yorkville Public Library.

PUBLIC NOTICE

The Kendall County Forest Preserve District has applied for Incidental Take Authorization to the Illinois Department of Natural Resources, Office of Resource Conservation, concerning the following species.

State Endangered: River Redhorse (*Moxostoma carinatum*) and
Greater Redhorse (*Moxostoma valenciennesi*)

Kendall County Forest Preserve
District mailing address:
Kendall County Forest Preserve District
Attention: Mr. David Guritz, Director
110 West Madison Street
Yorkville, IL 60560

The Forest Preserve District is proposing to remove an existing bridge over the Fox River northwest of the Village of Millbrook approximately 250' upstream from Whitfield Road in the southwest quarter of section 9, township 36 North, range 6 East of the Third Principal Meridian. Proposed work consists of removing the existing steel truss bridge and the placement of stone riprap for erosion control. Access to the channel below the bridge will be required to complete the bridge removal.

Temporary cofferdams and a temporary stone causeway will be placed in the river for dewatering and access. Fish within the coffered area will be collected and relocated prior to construction. Work will not be completed during the normal spawning time of May and June. The proposed activity may take an undetermined number of River Redhorse and Greater Redhorse fish. The proposed area of impact to the Fox River is 0.62 acres of temporary impact and 0.08 acres of permanent impact.

Erosion and sediment control measures will be utilized during construction to minimize impacts to adjacent stream habitat. The Forest Preserve will mitigate impacts through acquisition and conservation of similar habitat in the watershed. A copy of the Conservation Plan is available for inspection at (1) the Kendall County Forest Preserve District at 110 West Madison Street, Yorkville, IL 60560 (2) The Illinois Department of Natural Resources website <https://www.dnr.illinois.gov/conservation/NaturalHeritage/Pages/Incidental-Take-Authorizations.aspx> (ITA #178), and (3) The Yorkville Public Library at 902 Game Farm Road, Yorkville, IL 60560.

Comments on the Conservation Plan should be directed to the Illinois Department of Natural Resources, Office of Resource Conservation, Incidental Take Authorization Coordinator, One Natural Resources Way, Springfield IL 62702 or DNR.ITAcordinator@illinois.gov.

The Comment period closes thirty (30) days after the final publication of this notice in the Kendall County Record. Concurrent with the first publication in the Kendall County Record, the notice will be published one time in the Breeze Courier, the official State newspaper. The comment period will end on April 1, 2018.

(Published in the Kendall County Record on February 8, 15, 22, March 1, 2018) 1502934

PUBLIC NOTICE

The Kendall County Forest Preserve District will hold a public meeting on Thursday, February 15, 2018, from 5:30 PM to 7:00 PM at the Kendall County Forest Preserve Administrative Offices located in the Historic Courthouse, 110 W. Madison Street, Yorkville, Illinois to discuss a grant application to the Illinois Department of Natural Resources, RTP Program regarding the development of public access and trails at Fox River Bluffs Forest Preserve. Written and verbal public input is requested. If unable to attend the public meeting, residents may send written comments to

David Guritz, Director at the address above, or email the District at kcforest@co.kendall.il.us. The Historic Courthouse is an accessible location.

(Published in the Kendall County Record on February 1, 2018) 1502398